

Harnett County Department of Public Health

Improvement Permit

243 Spring Flowers

A building permit cannot be issued with only an Improvement Permit

ISSUED TO: Adams Homes AEC LLC PROPERTY LOCATION: 361201 Ponderosa Rd
 SUBDIVISION: CAROLINA SEASONS LOT # 55
 NEW REPAIR EXPANSION
 Type of Structure: SFD
 Proposed Wastewater System Type: 25% REDUCTION
 Projected Daily Flow: 480 GPD
 Number of bedrooms: 4 Number of Occupants: 8 max
 Basement Yes No
 Pump Required: Yes No May be required based on final location and elevations of facilities
 Type of Water Supply: Community Public Well Distance from well _____ feet
 Permit conditions: _____ Permit valid for: Five years No expiration

Authorized State Agent: James E. Markham III P.E. Date: 7-7-21 SEE ATTACHED SITE SKETCH
 The issuance of this permit by the Health Department in no way guarantees the issuance of other permits. The permit holder is responsible for checking with appropriate governing bodies in meeting their requirements. This site is subject to revocation if the site plan, plat, or the intended use changes. The Improvement Permit shall not be affected by a change in ownership of the site. This permit is subject to compliance with the provisions of the Laws and Rules for Sewage Treatment and Disposal and to conditions of this permit.

Construction Authorization

(Required for Building Permit)

The construction and installation requirements of Rules .1950, .1952, .1954, .1955, .1956, .1957, 1958, and .1959 are incorporated by references into this permit and shall be met. Systems shall be installed in accordance with the attached system layout.

ISSUED TO: Adams Homes AEC LLC PROPERTY LOCATION: 361201 Ponderosa Rd
 SUBDIVISION: CAROLINA SEASONS LOT # 55
 Facility Type: SFD New Expansion Repair
 Basement? Yes No Basement Fixtures? Yes No
 Type of Wastewater System** 25% REDUCTION System (Initial) Wastewater Flow: 480 GPD
 (See note below, if applicable 25% REDUCTION (Repair)
 Installation Requirements/Conditions
 Septic Tank Size 1000 gallons Number of trenches 2
 Pump Tank Size 1000 gallons Exact length of each trench 120 feet Trench Spacing: 9 Feet on Center
 Trenches shall be installed on contour at a Maximum Trench Depth of: 24-218 inches Soil Cover: 6 inches
 (Trench bottoms shall be level to +/- 1/4" in all directions) (Maximum soil cover shall not exceed 36" above the trench bottom)
 Pump Requirements: _____ ft. TDH vs. _____ GPM Aggregate Depth: 6 inches below pipe
2 inches above pipe
12 inches total
 Conditions: Pump may NOT BE Required (PENDING PUMPING STUBS OUT)

**WATER LINES (INCLUDING IRRIGATION) MUST BE 10FT. FROM ANY PART OF SEPTIC SYSTEM OR REPAIR AREA.
NO UTILITIES ALLOWED IN INITIAL OR REPAIR DRAIN FIELD AREA.**

**If applicable: I understand the system type specified is different from the type specified on the application. I accept the specifications of this permit.

Owner/Legal Representative Signature: _____ Date: _____

This Construction Authorization is subject to revocation if the site plan, plat, or the intended use changes. The Construction Authorization shall not be transferred when there is a change in ownership of the site. This Construction Authorization is subject to compliance with the provisions of the Laws and Rules for Sewage Treatment and Disposal and to the conditions of this permit. SEE ATTACHED SITE SKETCH

Authorized State Agent: James E. Markham III P.E. Date: 7-7-21
 Construction Authorization Expiration Date: 7-7-26

Application # SFD 2008-0042

Harnett County Department of Public Health Site Sketch

Property Location: 521201 Ponderosa RD
Issued To: Adams Homes AEC LLC Subdivision CAROLINA SEASONS Lot # 55
Authorized State Agent: James E. Markham Date: 7-7-21

Pump WILL NOT BE NEEDED IF PLUMBING IS STUBBED OUT
High enough to Accommodate Ditch Depths

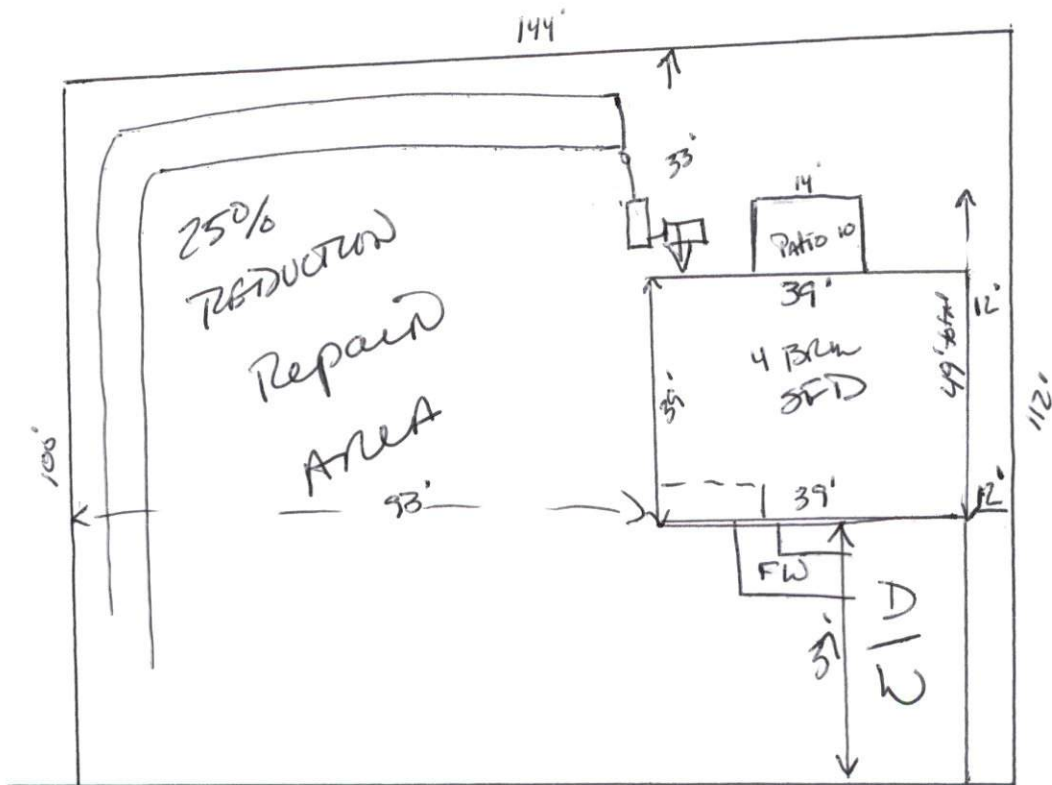

SPRING Flowers DR

This drawing is for illustrative purposes only. System installation must meet all pertinent laws, rules, and regulations.