

NOT TO SCALE
VICINITY MAP

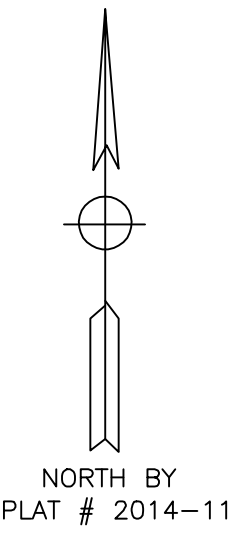

I, MELVIN A. GRAHAM, PLS. CERTIFY THAT THIS PLAT WAS DRAWN UNDER MY SUPERVISION FROM AN ACTUAL SURVEY MADE UNDER MY SUPERVISION (1:10,000 PROCEDURES) PLAT PREPARED IN ACCORDANCE WITH "STANDARDS OF PRACTICE FOR LAND SURVEYING IN NORTH CAROLINA"
Melvin A. Graham 09/26/2022
 MELVIN A. GRAHAM, PLS. L-3471 DATE



NOTE:
THIS SURVEY IS OF AN EXISTING PARCEL OR PARCELS OF LAND AND DOES NOT CREATE A NEW STREET OR CHANGE AN EXISTING STREET.
Melvin A. Graham
 SURVEYOR

NOTE:
THIS PROPERTY IS SUBJECT TO ANY AND ALL EASEMENTS, RIGHT OF WAYS, AND AGREEMENTS OF RECORD PRIOR TO THIS PLAT.

NOTES:
PROPERTY CONSIST OF ALL OF THE BELINDA D, WILLIAMS and JOSEPH B. DAVIS PROPERTY AS RECORDED IN D.B. 3872, PG. 342 HARNETT COUNTY REGISTRY.

ALL AREAS BY COORDINATE METHOD
 PROPERTY ZONED RA-20R
 PID # 039589 1015 78
 PIN # 9577-70-6862.000
 REF: LOT 2 PLAT # 2014-11

NOTE: THIS MAP IS NOT INTENDED FOR RECORDATION IN ACCORDANCE WITH G.S. 47-30 AS AMENDED.

NC 27 W 70' R/W (PAVED ROAD)

10' ADDITION TO R/W PLAT # 2006-33

MINIMUM BUILDING SETBACKS
 FRONT - 35'
 SIDELINES - 10'
 SIDE STREET - 20'
 REAR - 25'

LEGEND:
 EIP-EXISTING IRON PIPE OR IRON ROD
 NIP-NEW IRON PIPE OR IRON ROD
 NRRS-NEW RAILROAD SPIKE
 ERRS-EXISTING RAILROAD SPIKE
 NPK-NEW P.K. NAIL
 EPK-EXISTING P.K. NAIL
 ECM-EXISTING CONCRETE MONUMENT
 C/L-CENTER LINE
 PP-POWER POLE
 LP-LIGHT POLE
 R/W-RIGHT OF WAY
 CP-CALCULATED POINT
 -E- ELECTRICITY
 * - GROUND ELEVATION
 -X-X- FENCE

LOT 90
PLAT # 2006-500

LOT 1
PLAT # 2014-11

LOT 2
38,313 sq.ft.
(0.88 AC.)

SEPTIC SYSTEM EASEMENT
PLAT # 2008-964

LOT 74
PLAT # 2013-353

THIS PROPERTY IS NOT IN A SPECIAL FLOOD HAZARD AREA ACCORDING TO MAP NUMBER: 3710956600J OF THE FEDERAL EMERGENCY MANAGEMENT AGENCY. EFF. DATE: 10/03/2006

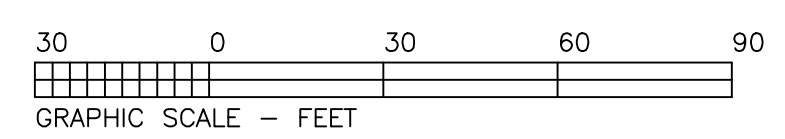

TOWNSHIP BARBECUE	COUNTY HARNETT	STATE NC
SURVEY FOR (OWNER) BELINDA D. WILLIAMS JOSEPH B. DAVIS 158 MCKAY DRIVE SPRING LAKE, NC 28390		DATE: 09/20/2022
PROPERTY ADDRESS 16581 NC 27 W SANFORD, NC 27332		SCALE: 1"=30'
MELVIN A. GRAHAM, PLS. 3679 NICHOLSON ROAD CAMERON, NC 28326 PHONE(919)499-6174		PROJECT: 0622
		REVISION: