

Harnett County Department of Public Health Improvement Permit

A building permit cannot be issued with only an Improvement Permit

PROPERTY LOCATION: 1030 W. Strickland Road (SR 1789)

ISSUED TO: Brian Barefoot/Herring Builders SUBDIVISION Travis Ray Adams LOT # 3

NEW REPAIR EXPANSION Site Improvements required prior to Construction Authorization Issuance:

Type of Structure: 67x62 3bed/2ba

Proposed Wastewater System Type: 25% Reduction System

Projected Daily Flow: 360 GPD

Number of bedrooms: 3 Number of Occupants: 6 max

Basement Yes No

Pump Required: Yes No May be required based on final location and elevations of facilities

Type of Water Supply: Community Public Well Distance from well NA feet

Permit valid for: Five years No expiration

Permit conditions: _____

Authorized State Agent:  Date: 02/20/2020 SEE ATTACHED SITE SKETCH

The issuance of this permit by the Health Department in no way guarantees the issuance of other permits. The permit holder is responsible for checking with appropriate governing bodies in meeting their requirements. This site is subject to revocation if the site plan, plat, or the intended use changes. The Improvement Permit shall not be affected by a change in ownership of the site. This permit is subject to compliance with the provisions of the Laws and Rules for Sewage Treatment and Disposal and to conditions of this permit.

Construction Authorization

(Required for Building Permit)

The construction and installation requirements of Rules .1950, .1952, .1954, .1955, .1956, .1957, .1958, and .1959 are incorporated by references into this permit and shall be met. Systems shall be installed in accordance with the attached system layout.

ISSUED TO: Brian Barefoot/Herring Builders PROPERTY LOCATION: 1030 W. Strickland Road (SR 1789)

FACILITY TYPE: 67x62 3bed/2ba SUBDIVISION Travis Ray Adams LOT # 3

New Expansion Repair

Basement? Yes No Basement Fixtures? Yes No

Type of Wastewater System** 25% Reduction System (Initial) Wastewater Flow: 360 GPD

(See note below, if applicable)

25% Reduction System (Repair)

<p><u>Installation Requirements/Conditions</u></p> <p>Septic Tank Size <u>1000</u> gallons</p> <p>Pump Tank Size _____ gallons</p>	<p>Number of trenches <u>3</u></p> <p>Exact length of each trench <u>90</u> feet</p> <p>Trenches shall be installed on contour at a Maximum Trench Depth of: <u>24</u> inches (Trench bottoms shall be level to +/-1/4" in all directions)</p>	<p>Trench Spacing: <u>9</u> Feet on Center</p> <p>Soil Cover: <u>12</u> inches (Maximum soil cover shall not exceed 36" above the trench bottom)</p>
--	--	--

Pump Requirements: _____ ft. TDH vs. _____ GPM

Aggregate Depth: NA inches below pipe NA inches above pipe NA inches total

Conditions: Gravity to D-Box Equal Distribution

**WATER LINES (INCLUDING IRRIGATION) MUST BE 10FT. FROM ANY PART OF SEPTIC SYSTEM OR REPAIR AREA.
NO UTILITIES ALLOWED IN INITIAL OR REPAIR DRAIN FIELD AREA.**

**If applicable: I understand the system type specified is different from the type specified on the application. I accept the specifications of this permit.

Owner/Legal Representative Signature: _____ Date: _____

This Construction Authorization is subject to revocation if the site plan, plat, or the intended use changes. The Construction Authorization shall not be transferred when there is a change in ownership of the site. This Construction Authorization is subject to compliance with the provisions of the Laws and Rules for Sewage Treatment and Disposal and to the conditions of this permit. SEE ATTACHED SITE SKETCH

Authorized State Agent:  Date: 02/20/2020

Andrew Curran Construction Authorization Expiration Date: 02/20/2025

Harnett County Department of Public Health Site Sketch

Property Location: 1030 W. Strickland Road (SR 1789)

Issued To: Brian Barefoot

Subdivision Travis Ray Adams

Lot # 3

Authorized State Agent: _____

[Handwritten Signature]
ANDREW CURRAN

Date: 08/20/2020

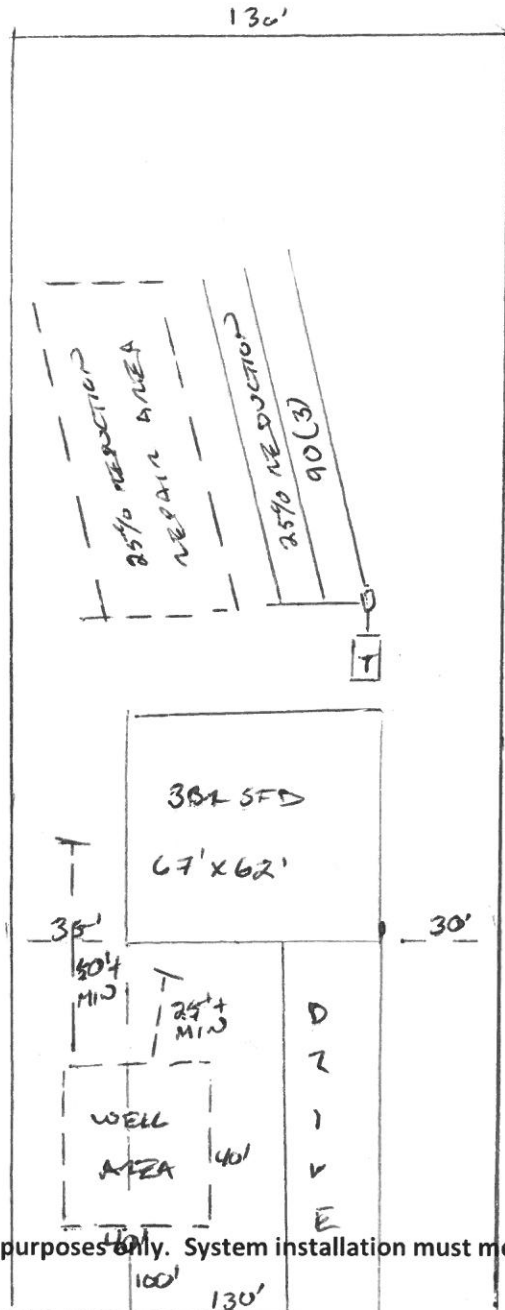

*GRAVITY TO D-BOX
EQUAL DISTRIBUTION

This drawing is for illustrative purposes only. System installation must meet all pertinent laws, rules, and regulations.

W. STRICKLAND ROAD (SR 1789)