

SFD 2007-0074

LOT 1

**SOIL/SITE EVALUATION  
 for ON-SITE WASTEWATER SYSTEM**

Owner: - Applicant: KRB BUILDING  
 Address: CAL GARDNER CH. Date Evaluated: 08/10/2008  
 Proposed Facility: 382 SFD Design Flow (.1949): 360 GPD  
 Location of Site: 382 SFD Property Recorded:  
 Water Supply:  Public  Individual  Well  
 Evaluation Method:  Auger Boring  Pit  Cut  
 Type of Wastewater:  Sewage  Industrial Process

Property Size:  
 Spring  Other  
 Mixed

P R O F I L E #	.1940 Landscape Position/ Slope %	Horizon Depth (In.)	SOIL MORPHOLOGY .1941		OTHER PROFILE FACTORS				Profile Class & LTAR
			.1941 Structure/ Texture	.1941 Consistence Mineralogy	.1942 Soil Wetness/ Color	.1943 Soil Depth (IN.)	.1956 Sapro Class	.1944 Restr Horiz	
1,2,3	L 3-4%	0-12	CL LS	VFA RSP					PS
		12-32	ML SL	F1 SSS	7.5" dia @ 30"	32			G.4
4,5,6	L 3-4%	0-12	CL LS	VFA RSP					PS
		12-36	ML SL	F1 SSS	7.5" dia @ 36"	36			G.4

Description	Initial System	Repair System	Other Factors (.1946): Site Classification (.1948):
Available Space (.1945)	<input checked="" type="checkbox"/>	<input checked="" type="checkbox"/>	PROVISIONALLY SUITABLE
System Type(s)	25% RED	25% RED	Evaluated By: <u>AUSTIN LAMIN, NEDS</u>
Site LTAR	G.4	G.4	Others Present:

COMMENTS: \_\_\_\_\_

LANDSCAPE POSITIONS	GROUP	TEXTURES	.1955 LTAR	CONSISTENCE MOIST	WET
R-RIDGE	I	S-SAND	1.2 - 0.8	VFR-VERY FRIABLE	NS-NON-STICKY
S-SHOULDER SLOPE		LS-LOAMY SAND			
L-LINEAR SLOPE	II	SL-SANDY LOAM	0.8 - 0.6	FI-FIRM	SS-SLIGHTLY STICKY
FS-FOOT SLOPE		L-LOAM			
N-NOSE SLOPE	III	SI-SILT	0.6 - 0.3	VFI-VERY FIRM	S-STICKY
H-HEAD SLOPE		CL-CLAY LOAM			
CC-CONCLAVE SLOPE	IV	SIL-SILT LOAM	0.4 - 0.1	EFI-EXTREMELY FIRM	VS-VERY STICKY
CV-CONVEX SLOPE		SCL-SANDY CLAY LOAM			
T-TERRACE					NP-NON-PLASTIC
FP-FLOOD PLAN					SP-SLIGHTLY STICKY
					P-PLASTIC
					VP-VERY PLASTIC

- STRUCTURE
- SG-SINGLE GRAIN
  - M-MASSIVE
  - CR-CRUMB
  - GR-GRANULAR
  - SBK-SUBANGULAR BLOCKY
  - ABK-ANGULAR BLOCKY
  - PL-PLATY
  - PR-PRISMATIC

- MINERALOGY
- SLIGHTLY EXPANSIVE
  - EXPANSIVE

Show profile locations and other site features (dimensions, references or benchmark, and North)

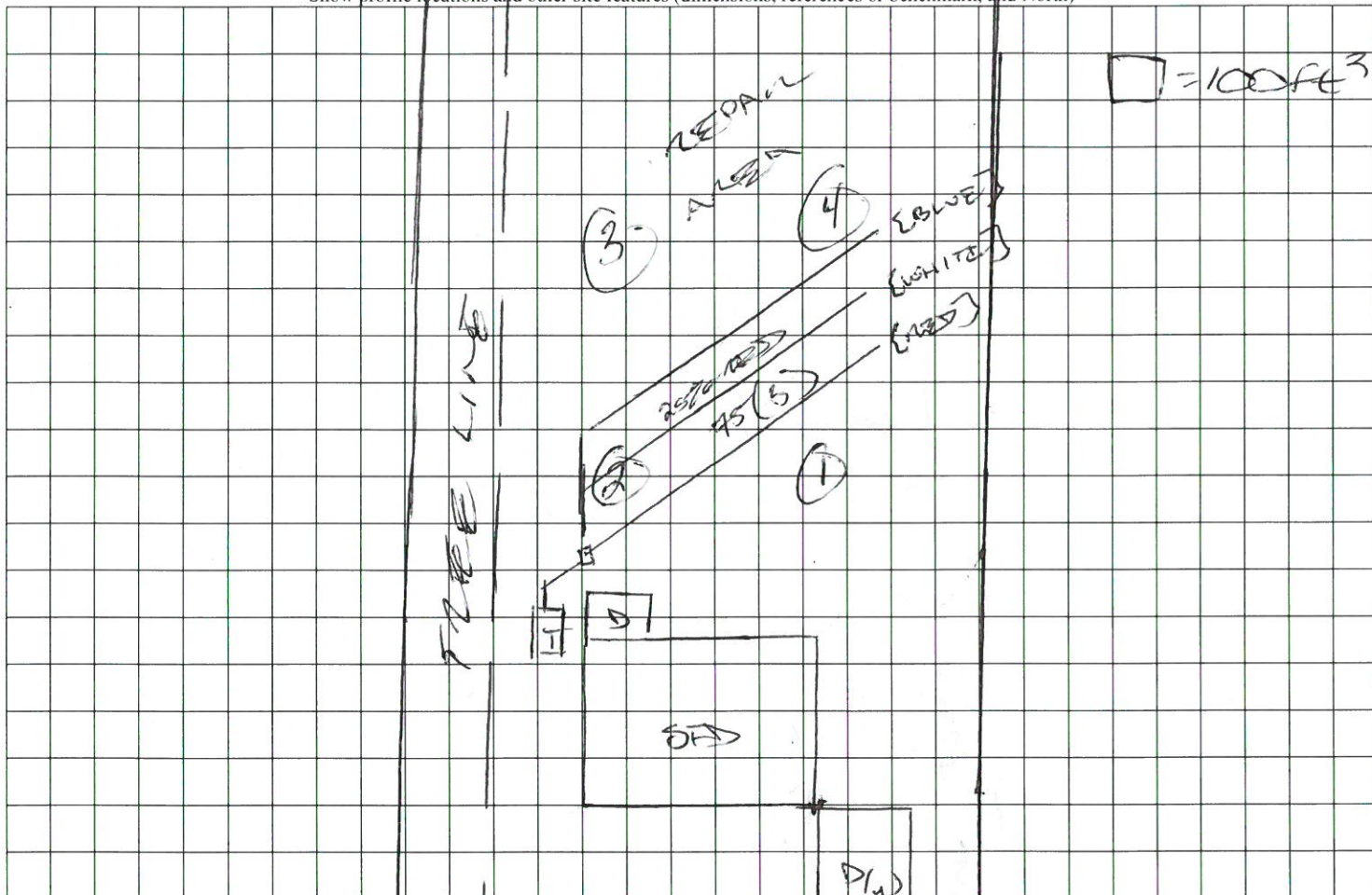

OAK GROVE CH. RD.  
 52 1532