

CURVE TABLE				
CURVE	LENGTH	RADIUS	BEARING	CHORD
C1	85.52'	325.18'	N86°51'21"E	85.27'

NOTE : CONTRACTOR TO VERIFY ALL BUILDING SETBACKS PRIOR TO CONSTRUCTION.

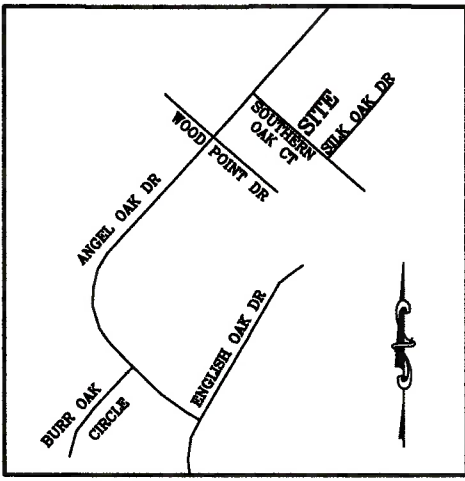

VICINITY MAP  
(NO SCALE)

(184)  
FOREST OAKS  
PHASE 3  
P.B. 2007, PG. 847

S49°17'13"W 70.19'

WETLANDS

(271)

0.38  
ACRES  
16,505 SQ. FT.

WETLANDS

20' DRAINAGE EASEMENT

20' SEWER EASEMENT

M.B. 2020, PG. 220



(272)

FOREST OAKS  
PHASE 5, SECTION 2  
P.B. 2020, PG. 220

S10°40'55"E 204.26'

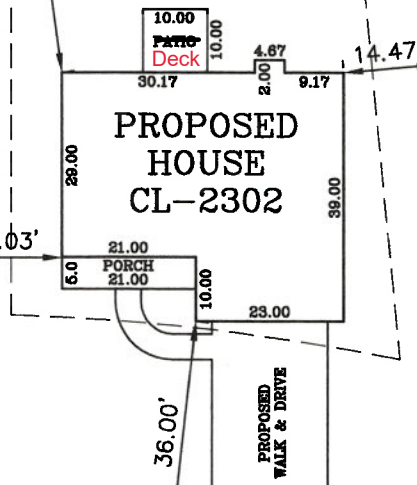

(270)

FOREST OAKS  
PHASE 5, SECTION 2  
P.B. 2020, PG. 220

ZONING: RA-20R  
SETBACKS:

FRONT - 35'  
SIDE - 10'  
REAR - 25'

SILK OAK DRIVE

50 FT. PUBLIC R/W

PLOT PLAN

PLOT PLAN FOR: CAVINESS LAND DEVELOPMENT

ADDRESS: SILK OAK DRIVE

CITY OF: NEAR BUNNLEVEL, NC

COUNTY OF: HARNETT

TOWNSHIP OF: ANDERSON CREEK

DATE: JULY 7TH, 2020

SCALE: 1" = 30'

REFERENCE: LOT 271

FOREST OAKS  
PHASE 5, SECTION 2  
M.B. 2020, PG. 220

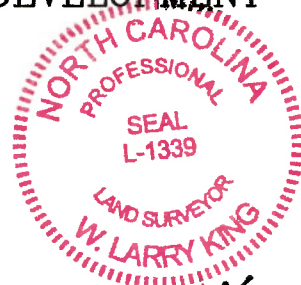

*W. Larry King 0707-20*  
W. LARRY KING, PLS - L-1339

Larry King & Associates, R.L.S., P.A.

P.O. Box 53787

1333 Morganton Road, Suite 201

Fayetteville, NC 28305

Phone: (910)483-4300

Fax: (910)483-4052

www.LKandA.com

NC Firm License C-0887

THIS MAP CAN NOT BE USED FOR RECORDATION OR ATTACHED TO A DEED TO BE RECORDED. THIS MAP IS NOT DRAWN IN ACCORDANCE WITH GS 47-30.

THE BOUNDARY AND LOT INFORMATION SHOWN ON THIS MAP IS TAKEN FROM THAT DOCUMENT DESCRIBED IN THE "REFERENCE" LINE SHOWN HEREON. THIS INFORMATION SHOULD BE CONFIRMED AS THE MOST CURRENT FOR THIS PROPERTY BEFORE ISSUANCE OF PERMITS OR COMMENCEMENT OF CONSTRUCTION. NO TITLE SEARCH WAS PERFORMED ON THIS PROPERTY BY THIS SURVEYOR.

I, W. LARRY KING, CERTIFY THAT THIS MAP IS FOR THE PURPOSE OF PERMITTING ONLY, IT IS NOT A SURVEY AND NO RELIANCE MAY BE PLACED ON ITS ACCURACY. THE STRUCTURE SHOWN ON THIS PLOT PLAN IS PLACED ACCORDING TO THE INSTRUCTIONS GIVEN BY THE BUILDER. ALL DIMENSIONS AND SETBACKS SHOULD BE VERIFIED FOR COMPLIANCE WITH ZONING AND COVENANTS.