

## Harnett County Department of Public Health Improvement Permit

A building permit cannot be issued with only an Improvement Permit

ISSUED TO: DANIEL & RENI WAGSTAFF PROPERTY LOCATION: 142 CARROLL DAVIS LN (NC 42)  
 SUBDIVISION \_\_\_\_\_ LOT # \_\_\_\_\_  
 NEW  REPAIR  EXPANSION  Site Improvements required prior to Construction Authorization Issuance: \_\_\_\_\_  
 Type of Structure: 1-BEDROOM 44x38' SFD  
 Proposed Wastewater System Type: 25% REDUCTION SIS.  
 Projected Daily Flow: 240 GPD (STATE MIN)  
 Number of bedrooms: 2 Number of Occupants: 4 max (STATE MIN)  
 Basement  Yes  No  
 Pump Required:  Yes  No  May be required based on final location and elevations of facilities  
 Type of Water Supply:  Community  Public  Well Distance from well 100+ feet Permit valid for:  Five years  
 Permit conditions: \_\_\_\_\_  No expiration

Authorized State Agent: [Signature] Date: 07/14/2020 SEE ATTACHED SITE SKETCH  
 The issuance of this permit by the Health Department in no way guarantees the issuance of other permits. The permit holder is responsible for checking with appropriate governing bodies in meeting their requirements. This site is subject to revocation if the site plan, plat, or the intended use changes. The Improvement Permit shall not be affected by a change in ownership of the site. This permit is subject to compliance with the provisions of the Laws and Rules for Sewage Treatment and Disposal and to conditions of this permit.

### Construction Authorization (Required for Building Permit)

The construction and installation requirements of Rules 1950, 1952, 1954, 1955, 1956, 1957, 1958, and 1959 are incorporated by references into this permit and shall be met. Systems shall be installed in accordance with the attached system layout.

ISSUED TO: DANIEL & RENI WAGSTAFF PROPERTY LOCATION: 142 CARROLL DAVIS LN (NC 42)  
 SUBDIVISION \_\_\_\_\_ LOT # \_\_\_\_\_  
 Facility Type: 1-B 44x38' SFD  New  Expansion  Repair  
 Basement?  Yes  No Basement Fixtures?  Yes  No  
 Type of Wastewater System\*\* 25% REDUCTION SIS. (Initial) Wastewater Flow: 240 GPD  
 (See note below, if applicable  25% REDUCTION SIS. (Repair) (STATE MIN)  

<u>Installation Requirements/Conditions</u>	Number of trenches <u>2</u>	Trench Spacing: <u>9</u> Feet on Center
Septic Tank Size <u>1000</u> gallons	Exact length of each trench <u>75</u> feet	Soil Cover: <u>12</u> inches
Pump Tank Size _____ gallons	Trenches shall be installed on contour at a Maximum Trench Depth of: <u>24</u> inches (Trench bottoms shall be level to +/-1/4" in all directions)	(Maximum soil cover shall not exceed 36" above the trench bottom)
Pump Requirements: _____ ft. TDH vs. _____ GPM		Aggregate Depth: <u>NA</u> inches below pipe <u>NA</u> inches above pipe
Conditions: <u>GRAVITY TO D-BOX EQUAL DISTRIBUTION</u>		<u>NA</u> inches total

**WATER LINES (INCLUDING IRRIGATION) MUST BE 10FT. FROM ANY PART OF SEPTIC SYSTEM OR REPAIR AREA.  
 NO UTILITIES ALLOWED IN INITIAL OR REPAIR DRAIN FIELD AREA.**

\*\*If applicable: I understand the system type specified is different from the type specified on the application. I accept the specifications of this permit.  
 Owner/Legal Representative Signature: \_\_\_\_\_ Date: \_\_\_\_\_

This Construction Authorization is subject to revocation if the site plan, plat, or the intended use changes. The Construction Authorization shall not be transferred when there is a change in ownership of the site. This Construction Authorization is subject to compliance with the provisions of the Laws and Rules for Sewage Treatment and Disposal and to the conditions of this permit. SEE ATTACHED SITE SKETCH

Authorized State Agent: [Signature] Date: 07/14/2020  
ANDREW CURRIN Construction Authorization Expiration Date: 07/14/2020

Application # SFD 2006-0085

# Harnett County Department of Public Health Site Sketch

Property Location: 142 CARROLL DAVID LN. (NY 42)

Issued To: DANIEL & RENI WAGSTAF Subdivision \_\_\_\_\_ Lot # \_\_\_\_\_

Authorized State Agent: *Andrew Curran* Date: 07/14/2020

ANDREW CURRAN

- \* SIZED FOR 2-BEDROOM 240 GPD [STATE MINIMUM]
- \* GRAVITY TO D-BOX EQUAL DISTRIBUTION
- \* PLUMBING WILL NEED TO BE STUBBED ON HIGH CORNER OF SFD OR PUMP SYSTEM MAY BE REQUIRED

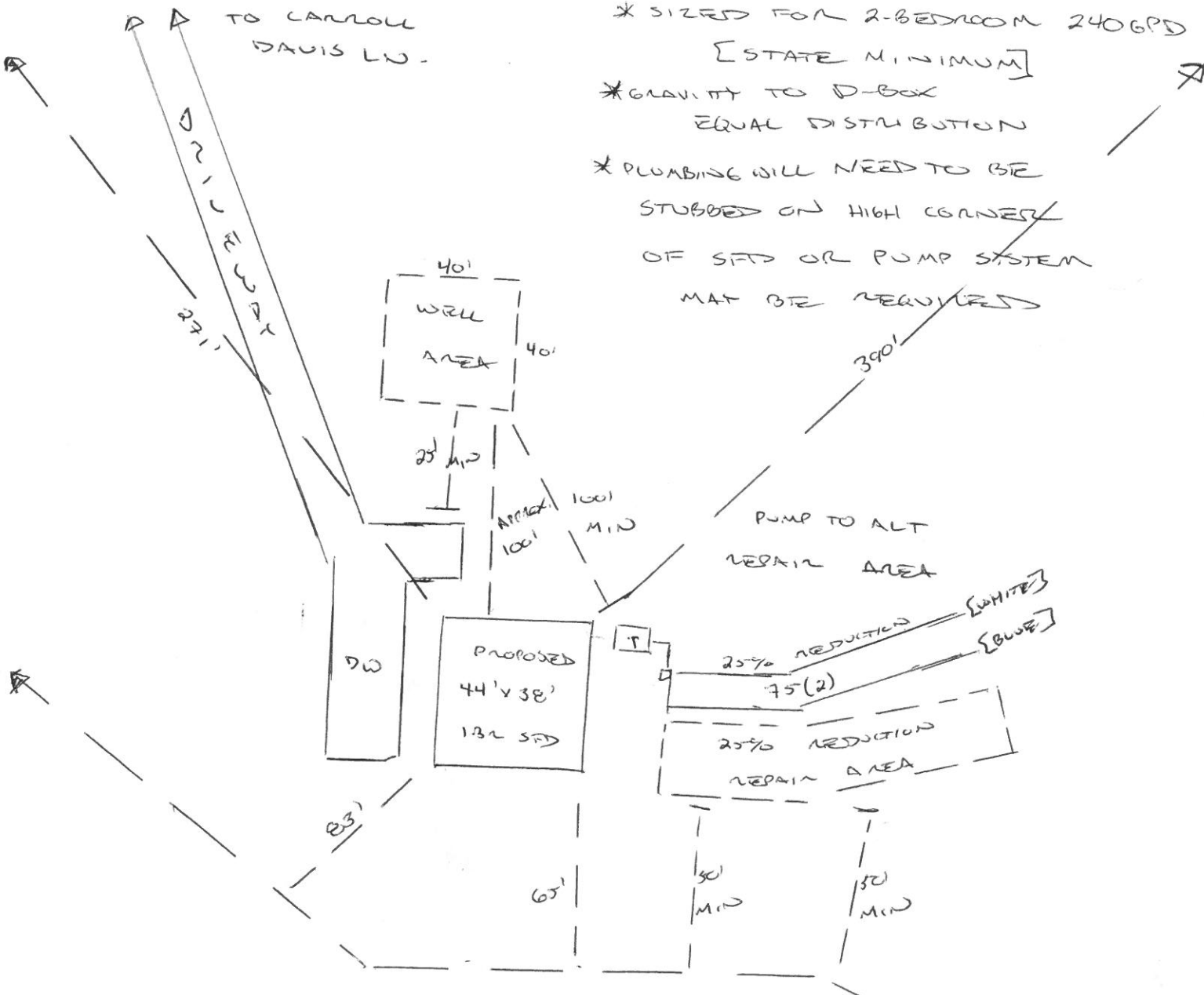

EXISTING POND  
This drawing is for illustrative purposes only. System installation must meet all pertinent laws, rules, and regulations.