

**Avery Pond**

**Lot #157**

3-Bedroom Home (360 gal./day)

<u>LINE #</u>	<u>COLOR</u>	<u>BS</u>	<u>HI</u>	<u>FS</u>	<u>ELEVATION</u>	<u>LINE LENGTH</u>	<u>Design Length</u>
TBM		2.0		100.0		<u>in field</u>	<u>installation</u>
INST. 1			102.0				
1	Yellow			6.8	95.2	70	65
2	Pink			6.4	95.6	70	65
3	Orange			6.1	95.9	70	65
4	Red			5.7	96.3	70	65
5	White			4.3	97.7	70	65
6	Blue			3	99	70	65
7	Yellow			2.6	99.4	70	65
8	Pink			1.3	100.7	70	65
Total							

	<u>System</u>	<u>Repair</u>
	Lines 1-4	Lines 5-8
<b>System Type</b>	Accepted Status System EZ-FLOW	Accepted Status System EZ-FLOW
Suggested Soil LTAR	0.350	0.350
<b>Total Line Length</b>	260	260
<b>Square Footage</b>	780	780
<b>Proposed Trench Bottom</b>	18-24"	18-24"
<b>Distribution Method</b>	Pump to D-Box	Pump to D-Box

# Avery Pond 3-Bedroom Septic Proposal Lot #157

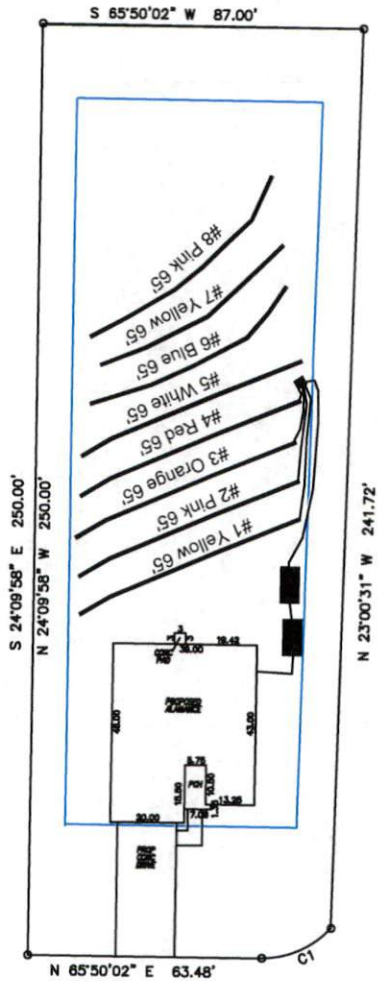

System: Pump to D-Box  
 Lines: 1-4 (260')  
 0.35 LTAR  
 18-24" Trench Bottom  
 Accepted Status System  
 Repair: Pump to D-Box  
 Lines: 5-8 (260')  
 0.35 LTAR  
 18-24" Trench Bottom  
 Accepted Status System

Doonbeg Drive

GRAPHIC SCALE  
 1" = 50'



Adams  
 Soil Consulting  
 919-414-6761  
 Job #708