

HTE# 5502006-0054

Harnett County Department of Public Health

No. 26746

PERMIT # NA

Operation Permit

New Installation Septic Tank Nitrification Line Repair Expansion SL 1429

PROPERTY LOCATION: 36 DOUGBEE DR. (CHALGATE RD)

Name: (owner) LGI HOMES NC LLC SUBDIVISION AVENT POND LOT # 164

System Installer: TIGANTONS PLUMBING Registration # _____

Basement with plumbing: Garage Number of Bedrooms 3

Type of Water Supply: Community Public Well Distance from well NA feet

System Type: 25% REDUCTION SYS. IIIg Types V and VI Systems expire in 5 years.

(In accordance with Table V a)

Owner must contact Health Department 6 months prior to expiration for permit renewal.

This system has been installed in compliance with applicable North Carolina General Statutes Rules for Sewage Treatment and Disposal, and all conditions of the Improvement Permit and Construction Authorization.

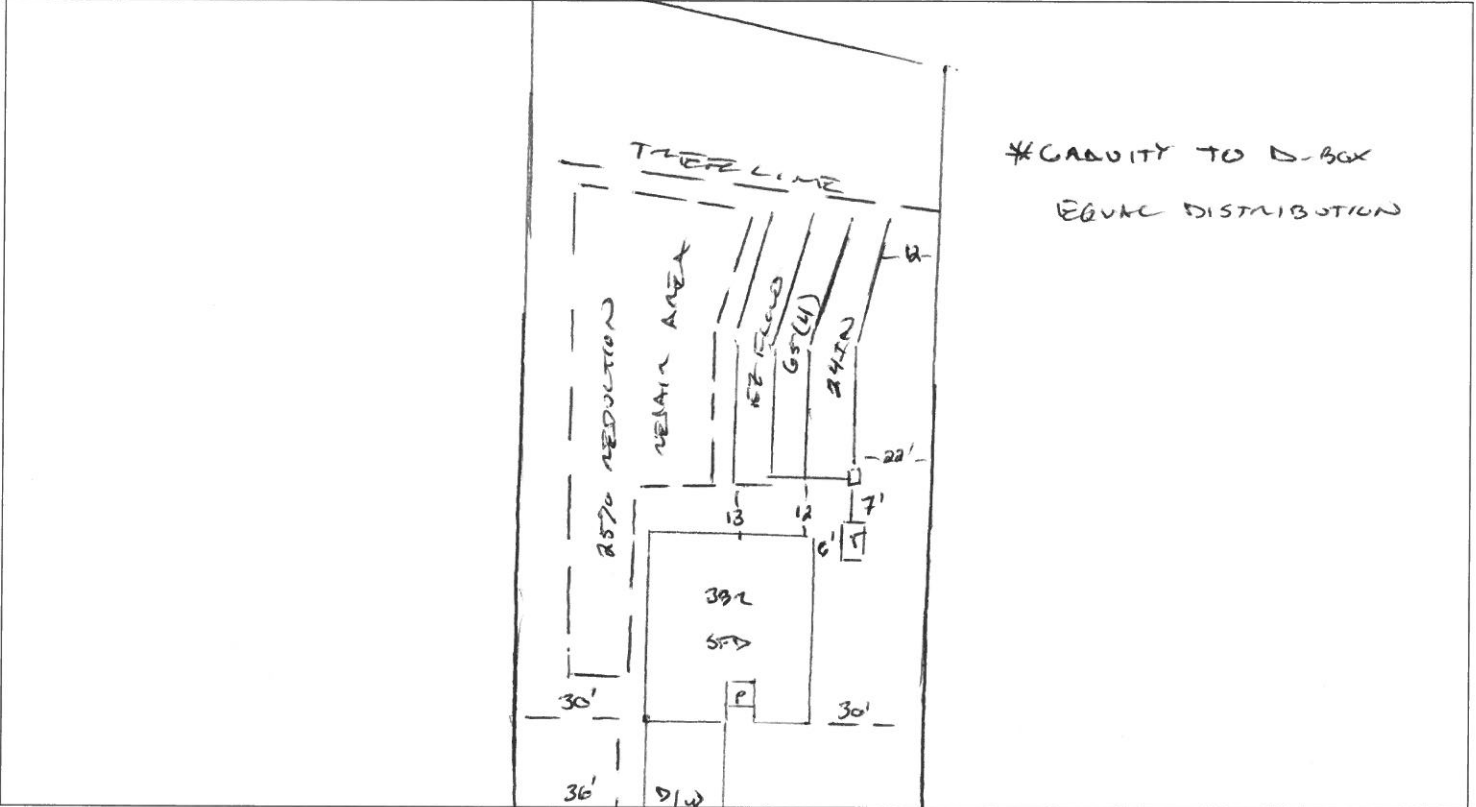

PERMIT CONDITIONS:

- I. Performance: System shall perform in accordance with Rule .1961.
- II. Monitoring: As required by Rule .1961.
- III. Maintenance: As required by Rule .1961. Other: DOUGBEE DRIVE
Subsurface system operator required? Yes No
If yes, see attached sheet for additional operation conditions, maintenance and reporting.
- IV. Operation: _____
- V. Other: _____

D-Box Pump Alarm H2O Line PWR Line

Following are the specifications for the sewage disposal system on the above captioned property.

Type of system: Conventional Other EB FLOW IIIg Septic Tank: 1000 gallons Pump Tank: _____ gallons
 Subsurface No. of exact length width of depth of
 Drainage Field ditches 4 of each ditch 65 feet ditches 3 feet ditches 24 inches
 French Drain Required: _____ Linear feet

Authorized State Agent [Signature] Date 11/06/2020