

**Avery Pond**  
**Lot #165**

4-Bedroom Home (480 gal./day)

<u>LINE #</u>	<u>COLOR</u>	<u>BS</u>	<u>HI</u>	<u>FS</u>	<u>ELEVATION</u>	<u>LINE LENGTH</u>	<u>Design Length</u>
TBM		2.0		100.0		<u>in field</u>	<u>installation</u>
INST. 1			102.0				
1	White			2.6	99.4	60	60
2	Blue			3	99	81	80
3	Yellow			3.4	98.6	90	90
4	Orange			3.8	98.2	65	65
5	Pink			4.2	97.8	65	65
6	Red			4.5	97.5	65	65
7	White			4.7	97.3	65	65
8	Blue			4.9	97.1	107	100
9	Yellow			5		70	70

Total

	<u>System</u>	<u>Repair</u>
	Lines 1-5	Lines 6-9
<b>System Type</b>	Accepted Status System EZ-FLOW	T&J Panel 50% Reduction System
Suggested Soil LTAR	0.350	0.350
<b>Total Line Length</b>	360	235
<b>Square Footage</b>	1080	705
<b>Proposed Trench Bottom</b>	18-24"	18-24"
<b>Distribution Method</b>	Gravity to Serial Dist	Pressure Manifold

# Avery Pond 4-Bedroom Septic Proposal Lot #165

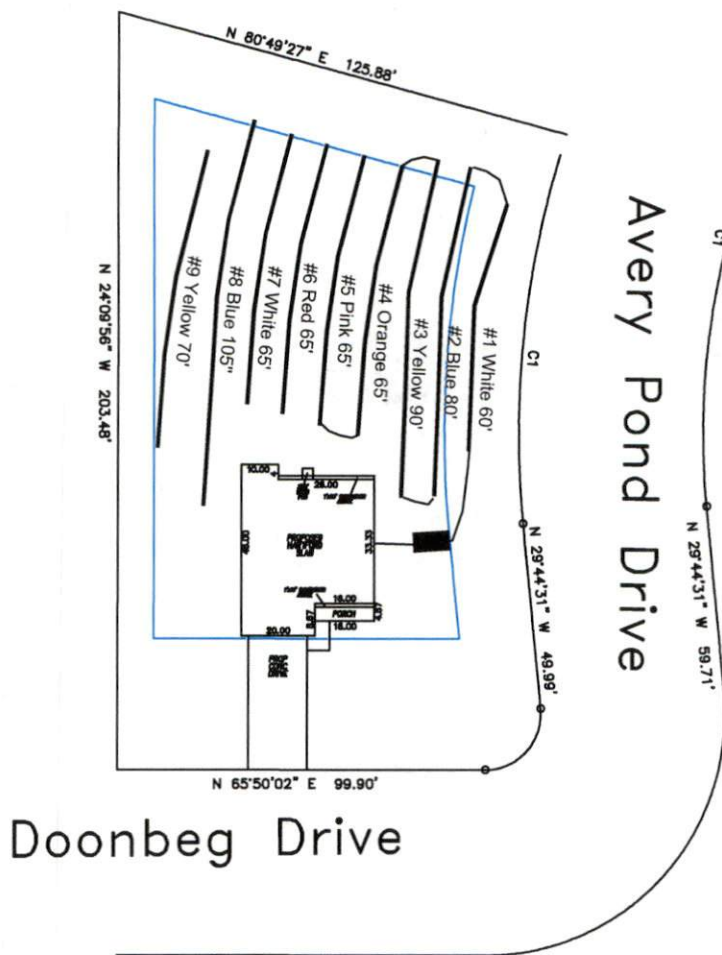

System: Gravity to Serial Dist  
 Lines: 1-5 (360')  
 0.35 LTAR  
 18-24" Trench Bottom  
 Accepted Status System  
 Repair: Pressure Manifold  
 Lines: 6-9 (260')  
 0.35 LTAR  
 18-24" Trench Bottom  
 T&J Panel 50% Reduction System

GRAPHIC SCALE  
 1" = 50'



Adams  
 Soil Consulting  
 919-414-6761  
 Job #708