



ECS Southeast, LLP

6151 Raeford Road, Suite A
Fayetteville, NC 28304
9104013288
9103230539

LETTER OF TRANSMITTAL

September 23, 2020
Floyd Properties

Fayetteville, NC 28305
ATTN: Darlene Rzonca

RE: **Anderson Creek Club Lot 1097**
ECS Job # **4458-N**

Permits:
Location: **141 Education Drive**
Spring Lake, NC 28390

Field Reports For your use As requested

CC: Floyd Properties - Veronica Page

ENCL: Field Report # 1 9/23/2020

Jack Edgar Cowsert, P.E.
Senior Project Engineer

Donny Johnson
Field Services Manager

Disclaimer

1. This report (and any attachments) shall not be reproduced except in full without prior written approval of ECS.
2. The information in this report relates only to the activities performed on the report date.
3. Where appropriate, this report includes statements as to compliance with applicable project drawings, and specifications for the activities, performed on this report date.
4. Incomplete or non-conforming work will be reported for future resolution.
5. The results of samples and/or specimens obtained or prepared for supersequent laboratory testing will be presented in separate reports/documents.



ECS Southeast, LLP
 6151 Raeford Road, Suite A
 Fayetteville, NC 28304
 (910) 401-3288 [Phone]
 (910) 323-0539 [Fax]

FIELD REPORT

Project **Anderson Creek Club Lot 1097**
 Location **Spring Lake, NC**
 Client **Floyd Properties**
 Contractor **Floyd Properties**

Project No. **4458-N**
 Report No. **1**
 Day & Date **Wednesday 9/23/2020**
 Weather **70 °/ Cloudy**
 On-Site Time **1.00**
 Lab Time **0.25**
 Travel Time* **1.25**
 Total **2.50**
 Re Obs Time **0.00**

Remarks

Trip Charges*	Tolls/Parking*	Mileage* 50	Time of Arrival	Departure
Chargeable Items			11:00A	12:00P

* Travel time and mileage will be billed in accordance with the contract.

Summary of Services Performed (field test data, locations, elevations & depths are estimates) & Individuals Contacted.

An ECS representative arrived on site, as requested, to check the bearing capacity of soils via hand auger/DCP method for soil backfill for front and back porch of lot 1097.

Please see the attached sketch for location details.

A hand auger was used to advance the boreholes to different depths noted on the boring logs. Dynamic Cone Penetrometer (DCP) test were performed in the hand auger boreholes by a 1.5 inch diameter cone driven into the soil by a 15 pound ring weight with a free fall of 20 inches. The number of blows required to drive the cone into the soil a distance of 1.75 inches is termed the DCP Value and is indicated for each test on the hand auger.

A total of 2 hand auger/DCP evaluations were performed to a depth of approximately 3 feet below the current sub grade elevation. It is the opinion of ECS that the materials in place, at the locations and elevations tested, did appear to be suitable to support a design bearing capacity 2000 psf. Soils appear to have been properly placed and compacted.

ECS will return, as requested, to perform additional services.

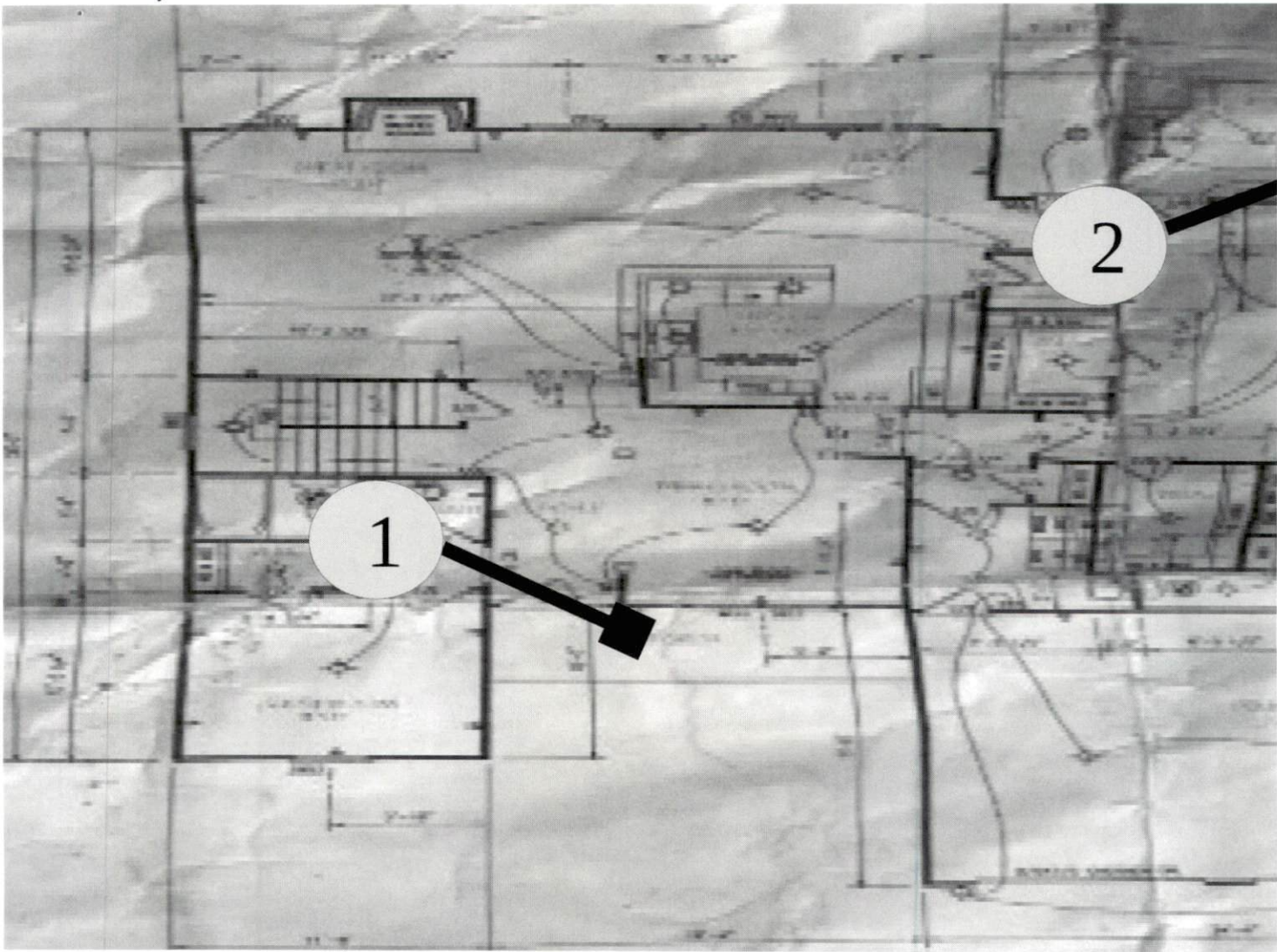

Joshua Noffsinger
22 Sep 2020
Proj#4458-N
WO#58523



K
T



Report of Spread Footing - Foundation Observations

Project: Anderson Creek Club Lot 1097
 Location: 141 Education Drive
 Spring Lake - Cumberland - NC - 28390
 Contractor: Floyd Properties

Project No.: 4458-N
 Day/Date: 9/23/2020

Footing Number	Location	Size (W x H x L)		Footing Bottom Elevation		Description of Steel Placed	Description of Subgrade Material	Re #
		Design	Actual	Design **	Depth of Undercut (in)			
1	1	x x	x x	N/A	0		Orange Sand	6 8,
1	1	x x	x x	N/A	-1		Orange Sand	6 7,
1	1	x x	x x	N/A	-2		Orange Sand	6 8,
1	1	x x	x x	N/A	-3		Orange Sand	6 9,
2	2	x x	x x	N/A	0		Orange Sand	6 7,
2	2	x x	x x	N/A	-1		Orange Sand	6 9,
2	2	x x	x x	N/A	-2		Orange Sand	6 8,
2	2	x x	x x	N/A	-3		Orange Sand	6 9,

** SGE: Subgrade Elevation to be determined by surveyor.



Report of Spread Footing - Foundation Observations

Project: Anderson Creek Club Lot 1097
Location: 141 Education Drive
Spring Lake - Cumberland - NC - 28390
Contractor: Floyd Properties

Project No.: 4458-N
Day/Date: 9/23/2020

By: Josh Noffsing

ECS Southeast