

FIRST FLOOR PLAN

22X34 PRINTS SCALE: 1/4"=1'-0"
 11X17 PRINTS SCALE: 1/8"=1'-0"

SQUARE FOOTAGE

FIRST FLOOR HTD. = 1,925
 SECOND FLOOR HTD. = 1,060
 TOTAL HTD. SQ. FT. = 2,985
 GARAGE = 541
 FRONT PORCH = 288
 SCREENED PORCH = 319

WINDOW FALL PREVENTION PROTECTION

IF ANY PART OF THE CLEAR OPENING OF THE OPERABLE PORTION OF A WINDOW IS LOCATED MORE THAN 2' ABOVE THE EXTERIOR GRADE THEN THE LOWEST PART OF THE CLEAR OPENING MUST BE AT LEAST 24" ABOVE THE FLOOR OF THE ROOM IN WHICH IT IS LOCATED.

EXCEPTIONS:

1. THE WINDOW IS A FIXED UNIT.
2. THE WINDOW DOES NOT ALLOW THE PASSAGE OF A 4" INCH DIAMETER SPHERE.
3. THE WINDOW IS EQUIPPED WITH A WINDOW FALL PREVENTION DEVICE MEETING ASTM F2090.
4. THE WINDOW IS EQUIPPED WITH AN APPROVED WINDOW OPENING LIMITING DEVICE.

NOTE: WHEN USED WITH AN EMERGENCY ESCAPE AND RESCUE WINDOW, OPENING LIMITING DEVICES AND FALL PREVENTION DEVICES MUST BE APPROVED FOR EMERGENCY ESCAPE AND RESCUE PROVISIONS.

ARCHITECTURAL PLANS WALL LEGEND

	STANDARD STUD WALL WITH 1/2" BRICK VENEER
	STANDARD STUD WALL WITH 5" BRICK VENEER
	STANDARD STUD WALL WITH 1/2" BRICK VENEER AND STONE VENEER
	STANDARD STUD WALL WITH 5" BRICK VENEER AND STONE VENEER
	STANDARD STUD WALL WITH 5" BRICK VENEER AND STONE VENEER AND STONE VENEER
	STANDARD STUD WALL WITH 5" BRICK VENEER AND STONE VENEER AND STONE VENEER
	STANDARD STUD WALL WITH 5" BRICK VENEER AND STONE VENEER AND STONE VENEER
	STANDARD STUD WALL WITH 5" BRICK VENEER AND STONE VENEER AND STONE VENEER
	STANDARD STUD WALL WITH 5" BRICK VENEER AND STONE VENEER AND STONE VENEER
	STANDARD STUD WALL WITH 5" BRICK VENEER AND STONE VENEER AND STONE VENEER

GENERAL NOTES

WALL THICKNESS / ANGLES

ALL EXTERIOR STUD WALLS ARE DRAWN 4" THICK U.N.O.
 ALL INTERIOR STUD WALLS ARE DRAWN 4" THICK U.N.O.
 ANGLED WALLS ARE DRAWN @ 45° U.N.O.

EGRESS

ALL BEDROOMS MUST HAVE AT LEAST ONE WINDOW WHICH CONFORMS TO EGRESS REQUIREMENTS FOR CLEAR OPENING HEIGHT AND WIDTH. IT IS THE CONTRACTOR'S RESPONSIBILITY TO VERIFY EGRESS SIZING PER CODE MAY VARY.

WALL/CEILING HEIGHTS

WALL AND CEILING HEIGHTS NOTES ARE BASED ON NOMINAL 100 ON THE PLANS.
 ALL VALUED OR SLOPED CEILING ARE TO BE FURRED DOWN TO ACCOMMODATE REQUIRED GELING INSULATION INSULATION REQUIREMENTS.

STAIRS

STAIRS ARE MEASURED FROM NOSING TO NOSING (N.N.). MAXIMUM STAIR RISE HEIGHT TO BE NO GREATER THAN 8'-10"

4. GABRIEL DESIGN WILL NOT ASSUME ANY LIABILITY FOR EXPENSES ASSOCIATED WITH ERRORS AND OMISSIONS ON THESE DRAWINGS UNLESS OFFSET BY VERIFIED CONSTRUCTION SAVINGS AS A RESULT OF DESIGNER.
 5. GABRIEL DESIGN RETAINS OWNERSHIP OF ALL OF DESIGNS DEPICTED AND IMPLIED HEREIN.
 6. GABRIEL DESIGN IS NOT RESPONSIBLE FOR ESTIMATING, MAINTAINING, OR REGULATING CONSTRUCTION COSTS ASSOCIATED WITH THESE PLANS.

©2019 ALL RIGHTS RESERVED.
 REPRODUCTION OF THIS SHEET IN WHOLE OR IN PART IS STRICTLY PROHIBITED.
 PLANS MAY BE USED ONLY BY CLIENT; UNAUTHORIZED USE IS STRICTLY PROHIBITED.

Glenwood Builders
 New Home Plan
 88 Florence Pines Lot 4
 Fuquay Varina, NC - Permit Set

PROGRESS DATE: 04-14-20
 ISSUE DATE: GR
 DRAWN BY: WW
 CHECKED BY: WW

REVISIONS:

DATE	BY	DESCRIPTION

SHEET NO: **A-40**
 PLAN NO: **P-01220**

gabriel design
 pwx architecture
 raleigh, nc
 email: gabreyesdesign@gmail.com
 phone: (919) 491-5855

HEADER SCHEDULE

(A) (2) 2x10 FLUSH
 (B) (2) 2x10 DROPPED
 (C) (2) 2x8 FLUSH
 (D) (2) 2x8 DROPPED

D.J. -DOUBLE JOIST
 U.W. = UNDER WALL

NOTE: ■= INDICATES SIGNIFICANT POINT LOAD, BLOCK SOLID DOWN TO FOUNDATION, PIER, OR SUPPORT BEAM.

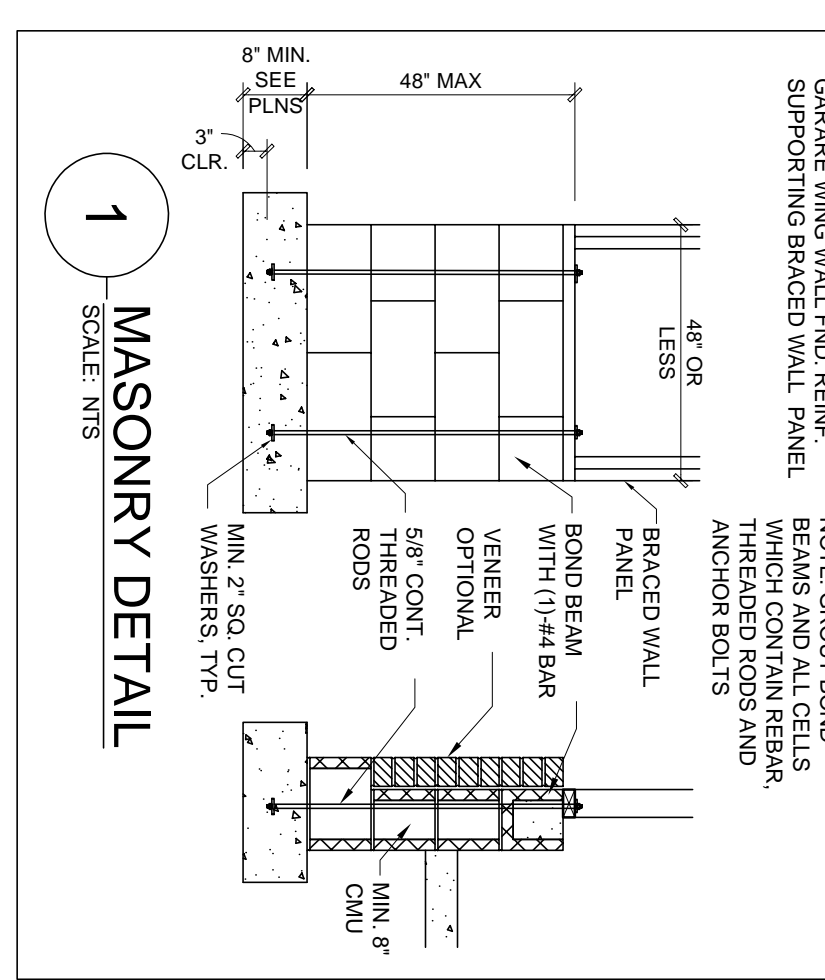
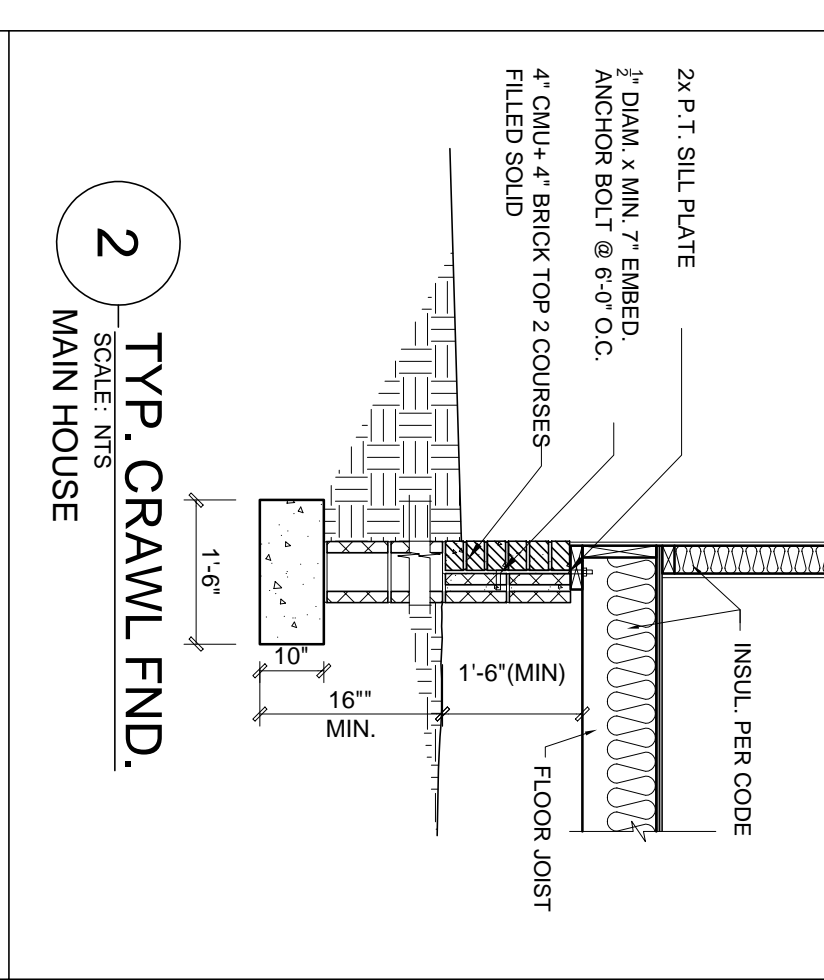
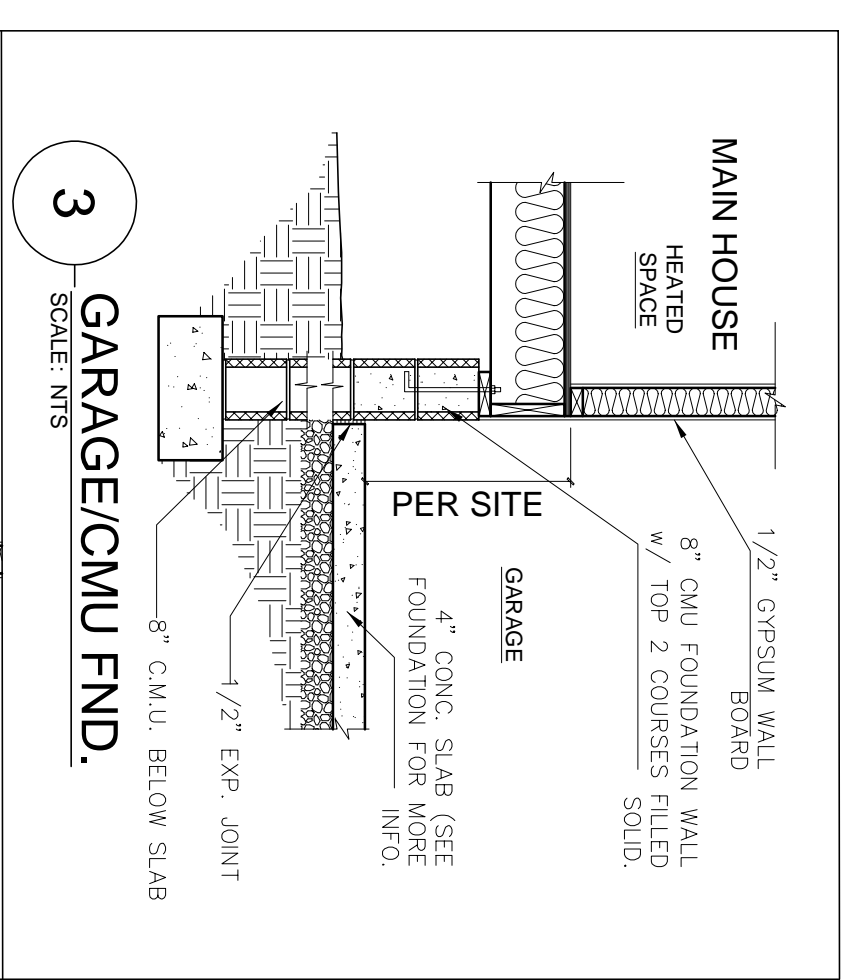

GENERAL NOTES:
 1. ALL DRAWINGS ARE TO BE COORDINATED WITH ALL SITE INFORMATION BY OWNER AND CONTRACTOR, AND APPLICABLE CODES.
 2. CONTRACTOR IS TO NOTIFY DESIGNER IMMEDIATELY OF CONDITIONS OR ITEMS VARYING FROM DEPICTED INFORMATION.
 3. GABRIEL DESIGN IS NOT RESPONSIBLE FOR CONSTRUCTED VARIATIONS FROM THE INFORMATION DEPICTED.

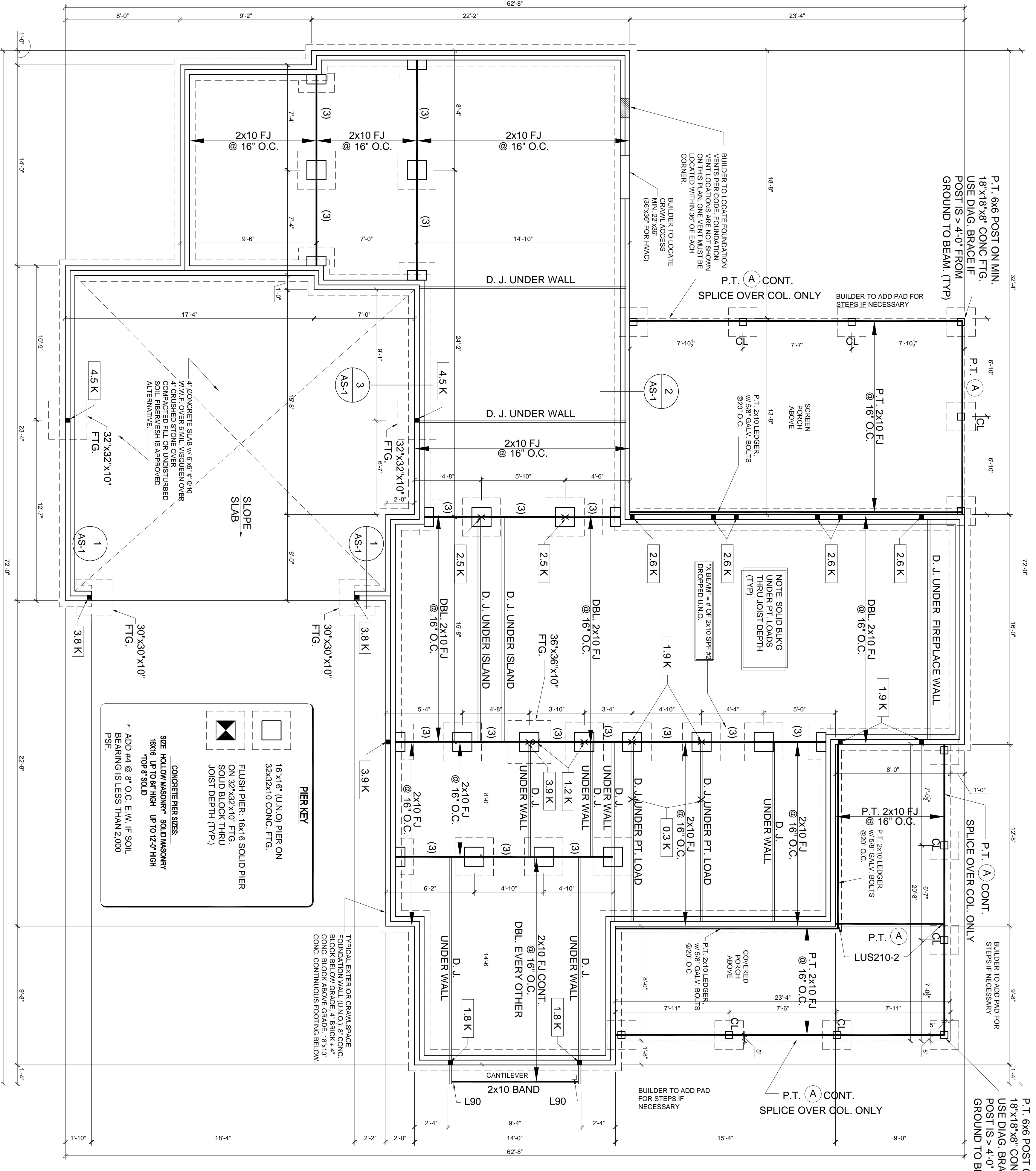

PIER KEY

FLUSH PIER: 16x16 SOLID PIER ON 32x32x10 CONG. FTG.

SIZE: HOLLOW MASONRY SOLID MASONRY 16x16 UP TO 6\"/>

CRAWL FOUNDATION/FIRST FLOOR FRAMING

22X34 PRINTS SCALE: 1/4\"/>

OPT. SEALED CRAWLSPACE
 MECHANICAL VENTILATION REQUIREMENT:
 MINIMUM OF 1 CFM PER SQ. SQUARE FEET

OPTIONAL SEALED CRAWL
 VENTILATION
 1,909 SQ. FT. / 50 = 39 CFM FAN

CrawlSpace Vent Calculations

A	Crawl Space Area	1309
B	Vent Area Required by Code (without vapor barrier)	12.7
C	Number of vents required	22.1
D	Number of vents with vapor barrier reduction	14.0
E	Formula:	
F	Formula:	
G	Formula:	
H	Formula:	

Notes:
 1. Builder must adjust ventilation calculations if using vents with a net area that is different than 0.47 sqft per vent.
 2. Crawl condition vents must be placed within 3 feet of each other.
 3. Foundation vents must be placed to allow for cross ventilation.

STRUCTURAL DESIGN BY
 MAEC W. MILLS, RA

DATE SEALED:
 INVALED IF UNSEALED

REGISTERED PROFESSIONAL ENGINEER
 NORTH-CAROLINA LICENSE # 7579
 VALID ONLY IF SIGNED IN BLUE

Glenwood Builders
 New Home Plan
 88 Florence Pines Lot 4
 Fuquay Varina, NC - Permit Set

gabriel design
 pwx architecture
 raleigh, nc
 email: gabereyesdesign@gmail.com
 phone: (919) 491-5855

PROGRESS DATE: _____
 ISSUE DATE: 04-14-20
 DRAWN BY: GR
 CHECKED BY: MW

REVISIONS:

DATE	BY	DESCRIPTION

PLAN NO. P-01220
 SHEET NO. AS-1
 Crawl Foundation & First Floor Framing

