

SPR 2005-0065
 AVENT ROAD
 LOT 128

**SOIL/SITE EVALUATION
 for ON-SITE WASTEWATER SYSTEM**

Owner: — Applicant: **LCI HOMES**
 Address: _____ Date Evaluated: **06/03/2020**
 Proposed Facility: _____ Design Flow (.1949): **360 GPD** Property Size:
 Location of Site: **302 SP** Property Recorded: **360680**
 Water Supply: Public Individual Well Spring Other
 Evaluation Method: Auger Boring Pit Cut
 Type of Wastewater: Sewage Industrial Process Mixed

| P R O F I L E # | .1940 Landscape Position/ Slope % | Horizon Depth (In.) | SOIL MORPHOLOGY .1941 | | OTHER PROFILE FACTORS | | | | Profile Class & LTAR |
|--------------------------------------|--|---------------------------|--------------------------------|------------------------------------|------------------------------------|------------------------------|-------------------------|-------------------------|----------------------------|
| | | | .1941 Structure/ Texture | .1941 Consistence Mineralogy | .1942 Soil Wetness/ Color | .1943 Soil Depth (IN.) | .1956 Sapro Class | .1944 Restr Horiz | |
| 1, 2 | 2.5-6% | 0-28 | GL LS | VF NSNP | | | | | PS |
| 3 | | 28-48 | GL SL | FN SP | | 48 | | | G-35 |
| 4 | 2.5-6% | 0-28 | GL LS | VFL NSNP | | | | | |
| | | 28-48 | GL SL | FN SP | | | | | PS |
| | | 48+ | RM | — | | 48 | | | G-35 |

| Description | Initial System | Repair System | Other Factors (.1946): Site Classification (.1948): |
|-------------------------|-------------------------------------|-------------------------------------|--|
| Available Space (.1945) | <input checked="" type="checkbox"/> | <input checked="" type="checkbox"/> | PROVISIONALLY SUITABLE |
| System Type(s) | 25% MED | 25% MED | Evaluated By: ANDREW CORRIE, PE/ES |
| Site LTAR | 0.35 | 0.35 | Others Present: |

COMMENTS: _____

| LANDSCAPE POSITIONS | GROUP | TEXTURES | .1955 LTAR | CONSISTENCE MOIST | WET |
|---------------------|-------|---------------------|------------|--------------------|--------------------|
| R-RIDGE | I | S-SAND | 1.2 - 0.8 | VFR-VERY FRIABLE | NS-NON-STICKY |
| S-SHOULDER SLOPE | | LS-LOAMY SAND | | | |
| L-LINEAR SLOPE | II | SL-SANDY LOAM | 0.8 - 0.6 | FI-FIRM | SS-SLIGHTY STICKY |
| FS-FOOT SLOPE | | L-LOAM | | | |
| N-NOSE SLOPE | | | | | |
| H-HEAD SLOPE | III | SI-SILT | 0.6 - 0.3 | VFI-VERY FIRM | S-STICKY |
| CC-CONCLAVE SLOPE | | SIL-SILT LOAM | | | |
| CV-CONVEX SLOPE | | CL-CLAY LOAM | | | |
| T-TERRACE | | SCL-SANDY CLAY LOAM | | | |
| FP-FLOOD PLAN | IV | SIC-SILTY CLAY | 0.4 - 0.1 | EFI-EXTREMELY FIRM | VS-VERY STICKY |
| | | C-CLAY | | | NP-NON-PLASTIC |
| | | SC-SANDY CLAY | | | SP-SLIGHTLY STICKY |

- STRUCTURE
 SG-SINGLE GRAIN
 M- MASSIVE
 CR-CRUMB
 GR-GRANULAR
 SBK-SUBANGULAR BLOCKY
 ABK-ANGULAR BLOCKY
 PL-PLATY
 PR-PRISMATIC

- MINERALOGY
 SLIGHTLY EXPANSIVE
 EXPANSIVE

Show profile locations and other site features (dimensions, references or benchmark, and North)

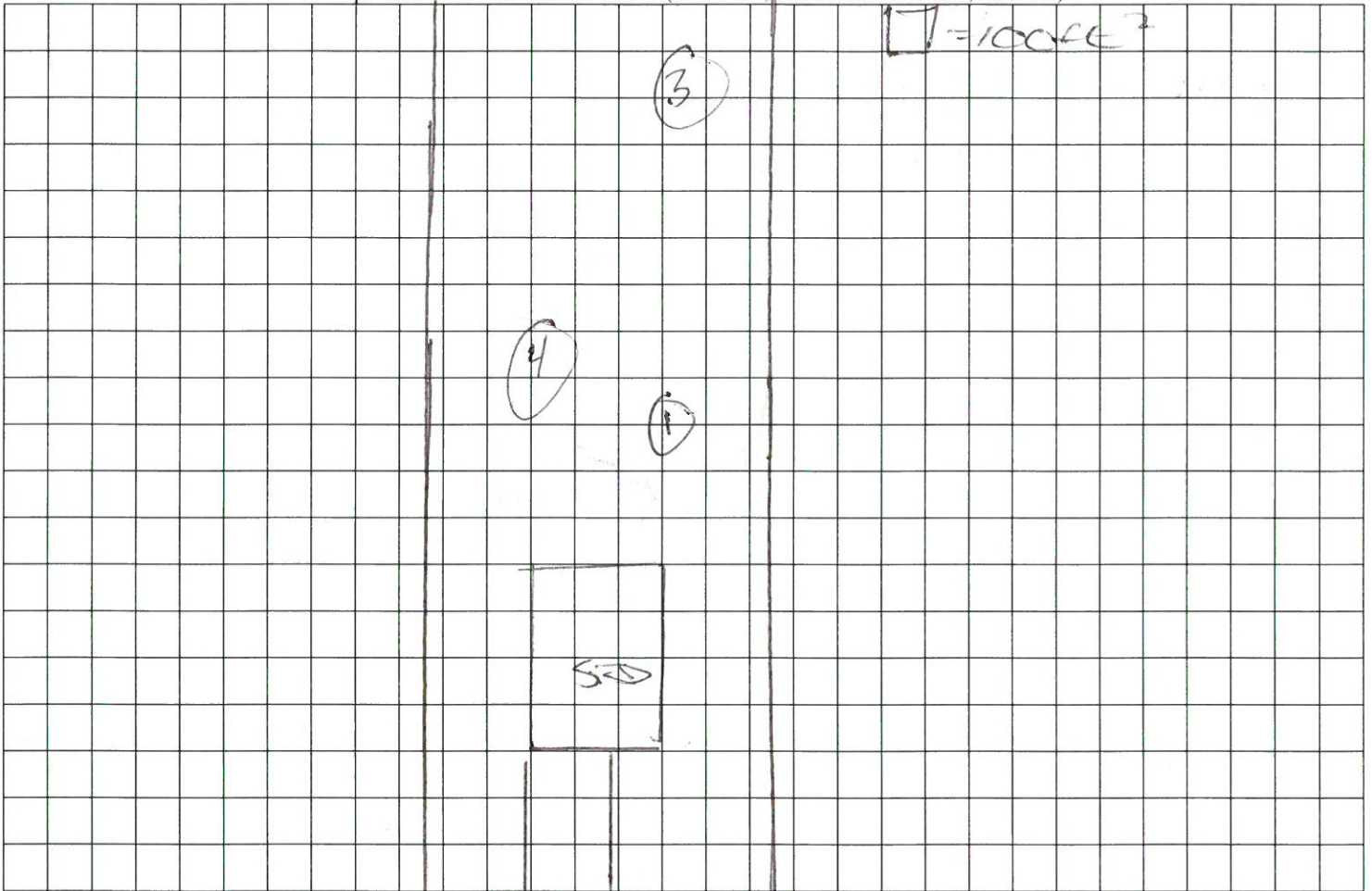

LOHINCH DR.