

Harnett County Department of Public Health Improvement Permit

A building permit cannot be issued with only an Improvement Permit

ISSUED TO: LGI Homes NC LLC PROPERTY LOCATION: 93 Lahinch Dr. (Chalybeate Rd. - SR 1429)
 SUBDIVISION Avery Pond LOT # 118
 NEW REPAIR EXPANSION Site Improvements required prior to Construction Authorization Issuance:
 Type of Structure: 3-Bedroom SFD
 Proposed Wastewater System Type: 25% Reduction Sys.
 Projected Daily Flow: 360 GPD
 Number of bedrooms: 3 Number of Occupants: 6 max
 Basement Yes No
 Pump Required: Yes No May be required based on final location and elevations of facilities
 Type of Water Supply: Community Public Well Distance from well NA feet Permit valid for: Five years
 Permit conditions: No expiration

Authorized State Agent: [Signature] Date: 06/05/2020 SEE ATTACHED SITE SKETCH
 The issuance of this permit by the Health Department in no way guarantees the issuance of other permits. The permit holder is responsible for checking with appropriate governing bodies in meeting their requirements. This site is subject to revocation if the site plan, plat, or the intended use changes. The Improvement Permit shall not be affected by a change in ownership of the site. This permit is subject to compliance with the provisions of the Laws and Rules for Sewage Treatment and Disposal and to conditions of this permit.

Construction Authorization (Required for Building Permit)

The construction and installation requirements of Rules 1950, 1952, 1954, 1955, 1956, 1957, 1958, and 1959 are incorporated by references into this permit and shall be met. Systems shall be installed in accordance with the attached system layout.

ISSUED TO: LGI Homes NC LLC PROPERTY LOCATION: 93 Lahinch Dr. (Chalybeate Rd. - SR 14)
 SUBDIVISION Avery Pond LOT # 118
 Facility Type: 3-Bedroom SFD New Expansion Repair
 Basement? Yes No Basement Fixtures? Yes No
 Type of Wastewater System** 25% Reduction Sys. (Initial) Wastewater Flow: 360 GPD
 (See note below, if applicable 25% Reduction Sys. (Repair)

Installation Requirements/Conditions

Septic Tank Size <u>1000</u> gallons	Number of trenches <u>4</u>	Trench Spacing: <u>9</u> Feet on Center
Pump Tank Size <u>1000</u> gallons	Exact length of each trench <u>60</u> feet	Soil Cover: <u>12</u> inches
	Trenches shall be installed on contour at a Maximum Trench Depth of: <u>24</u> inches (Trench bottoms shall be level to +/-1/4" in all directions)	(Maximum soil cover shall not exceed 36" above the trench bottom)
Pump Requirements: _____ ft. TDH vs. _____ GPM		Aggregate Depth: <u>NA</u> inches below pipe <u>NA</u> inches above pipe <u>NA</u> inches total

Conditions: Gravity to D-Box; Proposal by Adams Soil Consulting

**WATER LINES (INCLUDING IRRIGATION) MUST BE 10FT. FROM ANY PART OF SEPTIC SYSTEM OR REPAIR AREA.
 NO UTILITIES ALLOWED IN INITIAL OR REPAIR DRAIN FIELD AREA.**

**If applicable: I understand the system type specified is different from the type specified on the application. I accept the specifications of this permit.

Owner/Legal Representative Signature: _____ Date: _____

This Construction Authorization is subject to revocation if the site plan, plat, or the intended use changes. The Construction Authorization shall not be transferred when there is a change in ownership of the site. This Construction Authorization is subject to compliance with the provisions of the Laws and Rules for Sewage Treatment and Disposal and to the conditions of this permit. SEE ATTACHED SITE SKETCH

Authorized State Agent: [Signature] Date: 06/05/2020
ANDREW CUMMINS Construction Authorization Expiration Date: 06/05/2025

Application # SFD2005-0055

Harnett County Department of Public Health Site Sketch

Property Location: 93 Lahinch Dr. (Chalybeate Road - Sr 1429)

Issued To: LGI Homes-NC, LLC

Subdivision Avery Pond

Lot # 118

Authorized State Agent: *[Signature]*

Date: 06/05/2020

ANDREW CURRAN

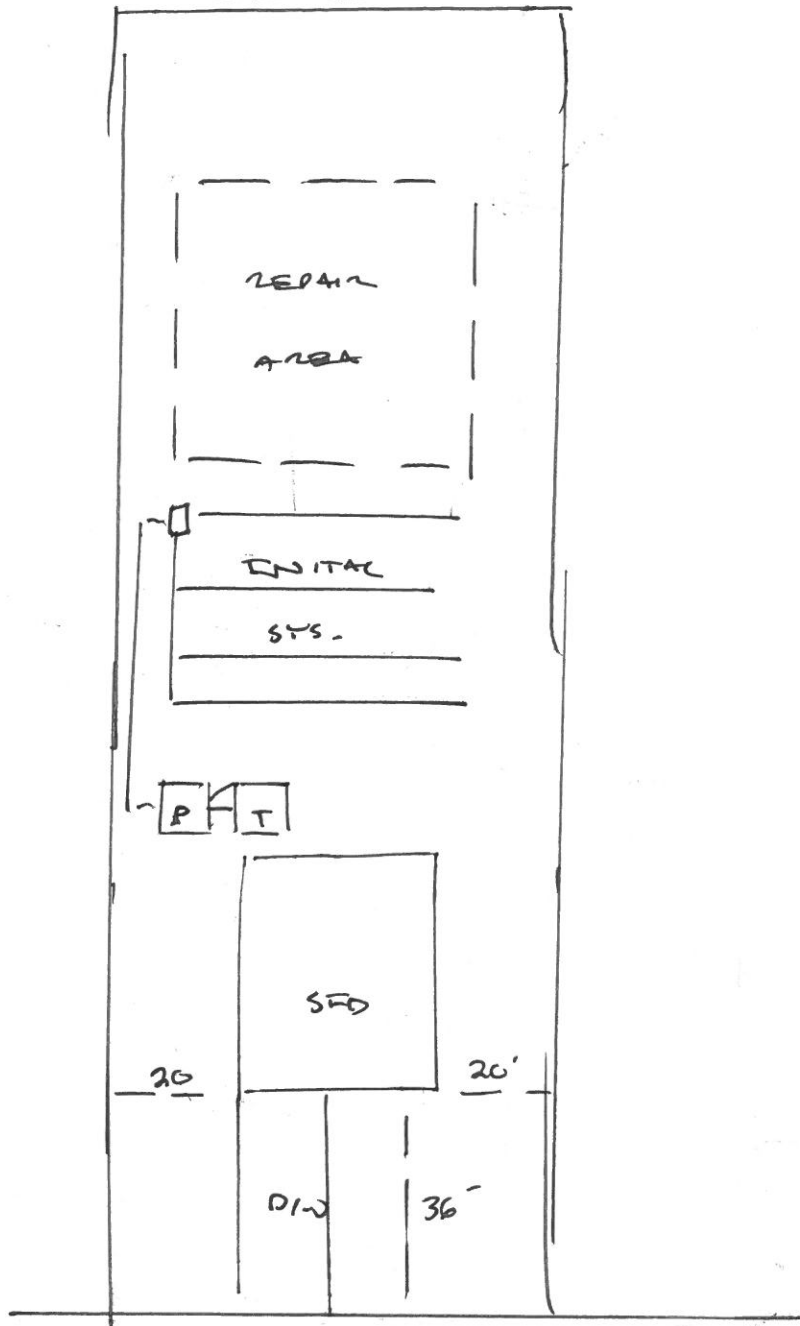

This drawing is for illustrative purposes only. System installation must meet all pertinent laws, rules, and regulations.

Avery Pond 3-Bedroom Septic Proposal Lot #118

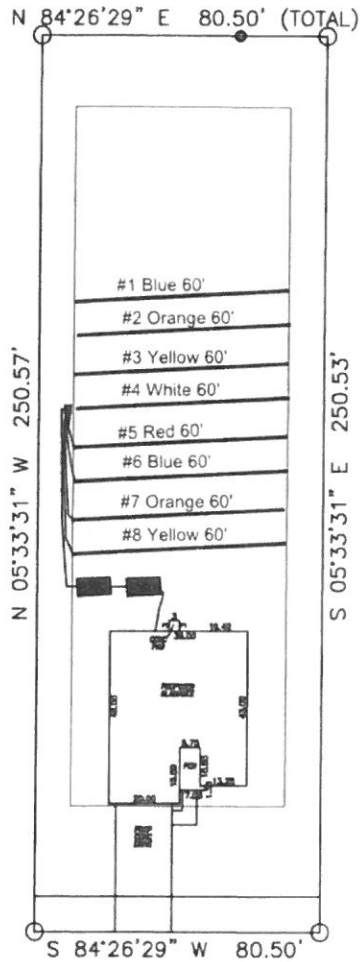

118

System: Pump to D-Box
 Lines: 5-8 (240')
 0.4 LTAR
 24" Trench Bottom
 Accepted Status System
 Repair: Pressure Manifold
 Lines: 1-4 (240')
 0.4 LTAR
 24" Trench Bottom
 Accepted Status System

Lahinch Drive



GRAPHIC SCALE
 1" = 50'



Adams
 Soil Consulting
 919-414-6761
 Job #708

Avery Pond

Lot #118

3-Bedroom Home (360 gal./day)

<u>LINE #</u>	<u>COLOR</u>	<u>BS</u>	<u>HI</u>	<u>FS</u>	<u>ELEVATION</u>	<u>LINE LENGTH</u>	<u>Design Length</u>
TBM		2.0		100.0		<u>in field</u>	<u>installation</u>
INST. 1			102.0				
1	Blue			3.1	98.9	60	60
2	Orange			3.3	98.7	60	60
3	Yellow			3.5	98.5	60	60
4	White			3.7	98.3	60	60
5	Red			3.8	98.2	60	60
6	Blue			3.9	98.1	60	60
7	Orange			4.1	97.9	60	60
8	Yellow			4.5	97.5	60	60
Total						240	240

System

Repair

Lines 5-8

Lines 1-4

System Type

Accepted Status System
EZ-FLOW

Accepted Status System
EZ-FLOW

Suggested Soil LTAR

0.40

0.40

Total Line Length

240

240

Square Footage

720

720

Proposed Trench Bottom

24"

24"

Distribution Method

Pump to D-
Box

Pump to D-Box