

Avery Pond

Lot #118

3-Bedroom Home (360 gal./day)

<u>LINE #</u>	<u>COLOR</u>	<u>BS</u>	<u>HI</u>	<u>FS</u>	<u>ELEVATION</u>	<u>LINE LENGTH</u>	<u>Design Length</u>
TBM		2.0		100.0		<u>in field</u>	<u>installation</u>
INST. 1			102.0				
1	Blue			3.1	98.9	60	60
2	Orange			3.3	98.7	60	60
3	Yellow			3.5	98.5	60	60
4	White			3.7	98.3	60	60
5	Red			3.8	98.2	60	60
6	Blue			3.9	98.1	60	60
7	Orange			4.1	97.9	60	60
8	Yellow			4.5	97.5	60	60
Total						240	240

System

Lines 5-8

Repair

Lines 1-4

System Type

Accepted Status System
EZ-FLOW

Accepted Status System
EZ-FLOW

Suggested Soil LTAR

0.40

0.40

Total Line Length

240

240

Square Footage

720

720

Proposed Trench Bottom

24"

24"

Distribution Method

Pump to D-
Box

Pump to D-Box

Avery Pond 3-Bedroom Septic Proposal Lot #118

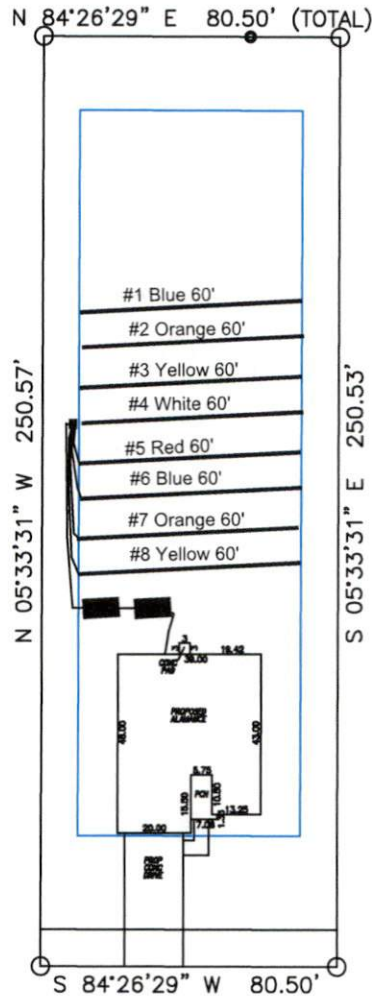

118

System: Pump to D-Box
 Lines: 5-8 (240')
 0.4 LTAR
 24" Trench Bottom
 Accepted Status System
 Repair: Pressure Manifold
 Lines: 1-4 (240')
 0.4 LTAR
 24" Trench Bottom
 Accepted Status System

Lahinch Drive

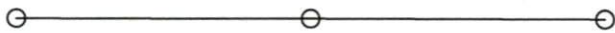

GRAPHIC SCALE
1" = 50'



Adams
Soil Consulting
919-414-6761
Job #708