

Harnett County Department of Public Health Improvement Permit

A building permit cannot be issued with only an Improvement Permit

ISSUED TO: HUGH SULLES BLDG LLC PROPERTY LOCATION: 4994 CHRISTIAN CT RD (SR 1412)
 SUBDIVISION: PRINCE POINTE LOT # 2
 NEW REPAIR EXPANSION
 Type of Structure: 4-BEDROOM 52'x49' SFS
 Proposed Wastewater System Type: 25% REDUCTION
 Projected Daily Flow: 480 GPD
 Number of bedrooms: 4 Number of Occupants: 5 max
 Basement Yes No
 Pump Required: Yes No May be required based on final location and elevations of facilities
 Type of Water Supply: Community Public Well Distance from well NA feet
 Permit conditions: _____ Permit valid for: Five years No expiration

Authorized State Agent: [Signature] Date: 06/02/2020 SEE ATTACHED SITE SKETCH
 The issuance of this permit by the Health Department in no way guarantees the issuance of other permits. The permit holder is responsible for checking with appropriate governing bodies in meeting their requirements. This site is subject to revocation if the site plan, plat, or the intended use changes. The Improvement Permit shall not be affected by a change in ownership of the site. This permit is subject to compliance with the provisions of the Laws and Rules for Sewage Treatment and Disposal and to conditions of this permit.

Construction Authorization (Required for Building Permit)

The construction and installation requirements of Rules .1950, .1952, .1954, .1955, .1956, .1957, .1958, and .1959 are incorporated by references into this permit and shall be met. Systems shall be installed in accordance with the attached system layout.

ISSUED TO: HUGH SULLES BLDG LLC PROPERTY LOCATION: 4994 CHRISTIAN CT RD (SR 1412)
 SUBDIVISION: PRINCE POINTE LOT # 2
 Facility Type: 482 52'x49' SFS New Expansion Repair
 Basement? Yes No Basement Fixtures? Yes No
 Type of Wastewater System** 25% REDUCTION SYS. (Initial) Wastewater Flow: 480 GPD
 (See note below, if applicable PUMP TO 25% REDUCTION (Repair))

Installation Requirements/Conditions

Septic Tank Size <u>1250</u> gallons	Number of trenches <u>3</u>	Trench Spacing: <u>9</u> Feet on Center
Pump Tank Size _____ gallons	Exact length of each trench <u>90</u> feet	Soil Cover: <u>12</u> inches
	Trenches shall be installed on contour at a Maximum Trench Depth of: <u>24</u> inches (Trench bottoms shall be level to +/-1/4" in all directions)	(Maximum soil cover shall not exceed 36" above the trench bottom)
Pump Requirements: _____ ft. TDH vs. _____ GPM		Aggregate Depth: <u>NA</u> inches below pipe <u>NA</u> inches above pipe <u>NA</u> inches total

Conditions: GRAVITY TO D-BOX EQUAL DISTRIBUTION

**WATER LINES (INCLUDING IRRIGATION) MUST BE 10FT. FROM ANY PART OF SEPTIC SYSTEM OR REPAIR AREA.
 NO UTILITIES ALLOWED IN INITIAL OR REPAIR DRAIN FIELD AREA.**

***If applicable: I understand the system type specified is different from the type specified on the application. I accept the specifications of this permit.*

Owner/Legal Representative Signature: _____ Date: _____

This Construction Authorization is subject to revocation if the site plan, plat, or the intended use changes. The Construction Authorization shall not be transferred when there is a change in ownership of the site. This Construction Authorization is subject to compliance with the provisions of the Laws and Rules for Sewage Treatment and Disposal and to the conditions of this permit. SEE ATTACHED SITE SKETCH

Authorized State Agent: [Signature] Date: 06/02/2020
ANDREW CURRAN Construction Authorization Expiration Date: 06/02/2025

Application # SFD 2005-0052

Harnett County Department of Public Health Site Sketch

Property Location: 4994 CHRISTIAN LT RD (SR 1412)
Issued To: HUGH SURLES BLDG LLC Subdivision PLINER POINTE Lot # 2

Authorized State Agent: *Andrew Curran* Date: 06/02/2020
ANDREW CURRAN

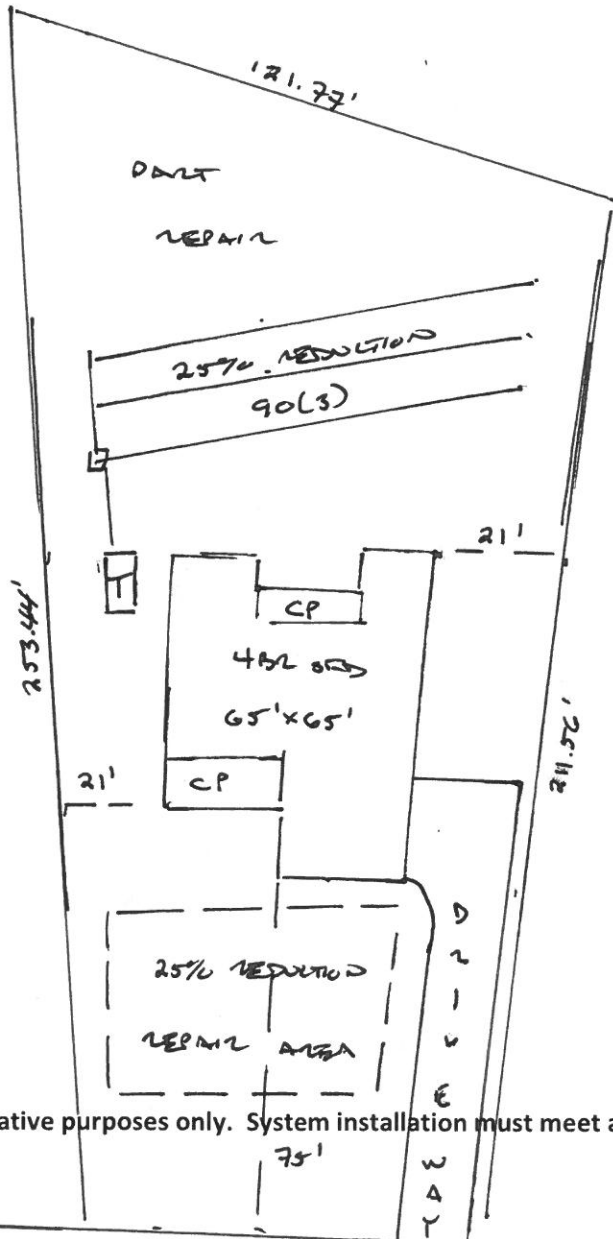

* GRAVITY TO D-BOX
EQUAL DISTRIBUTION
* UTILITY ACCESS SHALL
BE ALONG EITHER
PROPERTY LINE

This drawing is for illustrative purposes only. System installation must meet all pertinent laws, rules, and regulations.

CHRISTIAN LT RD (SR 1412)