

Harnett County Department of Public Health Improvement Permit

A building permit cannot be issued with only an Improvement Permit

ISSUED TO: DAN RYAN BUZDENS N.C. LLC PROPERTY LOCATION: 321453 OLD MILL RD
 NEW REPAIR EXPANSION SUBDIVISION: 0106 Mill Village LOT # 13
 Site Improvements required prior to Construction Authorization Issuance: _____
 Type of Structure: SFD
 Proposed Wastewater System Type: 25% RECONSTRUCTION
 Projected Daily Flow: 480 ~~300~~ GPD
 Number of bedrooms: 4 Number of Occupants: 8 max
 Basement Yes No
 Pump Required: Yes No May be required based on final location and elevations of facilities
 Type of Water Supply: Community Public Well Distance from well _____ feet Permit valid for: Five years
 Permit conditions: _____ No expiration

Authorized State Agent: James E. Manhart Date: 6-4-20 SEE ATTACHED SITE SKETCH
 The issuance of this permit by the Health Department in no way guarantees the issuance of other permits. The permit holder is responsible for checking with appropriate governing bodies in meeting their requirements. This site is subject to revocation if the site plan, plat, or the intended use changes. The Improvement Permit shall not be affected by a change in ownership of the site. This permit is subject to compliance with the provisions of the Laws and Rules for Sewage Treatment and Disposal and to conditions of this permit.

Construction Authorization

(Required for Building Permit)

The construction and installation requirements of Rules .1950, .1952, .1954, .1955, .1956, .1957, .1958, and .1959 are incorporated by references into this permit and shall be met. Systems shall be installed in accordance with the attached system layout.

ISSUED TO: DAN RYAN BUZDENS N.C. LLC PROPERTY LOCATION: 321453 OLD MILL RD
 SUBDIVISION: 0106 Mill Village LOT # 13
 Facility Type: SFD New Expansion Repair
 Basement? Yes No Basement Fixtures? Yes No
 Type of Wastewater System** 25% RECONSTRUCTION (Accepted) (Initial) Wastewater Flow: 480 GPD
 (See note below, if applicable
25% RECONSTRUCTION (Accepted) (Repair)
 Installation Requirements/Conditions
 Septic Tank Size 1200 gallons Number of trenches 4
 Pump Tank Size _____ gallons Exact length of each trench 100 feet Trench Spacing: 9 Feet on Center
 Trenches shall be installed on contour at a Soil Cover: 6 inches
 Maximum Trench Depth of: 24" inches (Maximum soil cover shall not exceed
 (Trench bottoms shall be level to +/-1/4" 36" above the trench bottom)
 in all directions)
 Pump Requirements: _____ ft. TDH vs. _____ GPM Aggregate Depth: 6 inches below pipe
2 inches above pipe
 Conditions: All Rules + Regulations Apply ON INSTALLATION of Septic System. 12 inches total

**WATER LINES (INCLUDING IRRIGATION) MUST BE 10FT. FROM ANY PART OF SEPTIC SYSTEM OR REPAIR AREA.
 NO UTILITIES ALLOWED IN INITIAL OR REPAIR DRAIN FIELD AREA.**

**If applicable: I understand the system type specified is different from the type specified on the application. I accept the specifications of this permit.
 Owner/Legal Representative Signature: _____ Date: _____

This Construction Authorization is subject to revocation if the site plan, plat, or the intended use changes. The Construction Authorization shall not be transferred when there is a change in ownership of the site. This Construction Authorization is subject to compliance with the provisions of the Laws and Rules for Sewage Treatment and Disposal and to the conditions of this permit. SEE ATTACHED SITE SKETCH

Authorized State Agent: James E. Manhart Date: 6-4-20
 Construction Authorization Expiration Date: 6-4-25

HTE# SFD 2005-0050

Permit # SFD 2005-0050

Harnett County Department of Public Health Site Sketch

PROPERTY LOCATOR: 511453 OLD MILL RD

ISSUED TO: Dan Ryan Buckdens N.C. LLC SUBDIVISION Old Mill Village LOT # 13

Authorized State Agent: James E. Marshall ~~REBOTS~~ Date: 6-4-20

* Follow All Rules & Regulations ON INSTALLATION.

* IF SYSTEM FLAGS ARE MISSING HAVE CONSULTANT REFLAG BEFORE INSTALL.

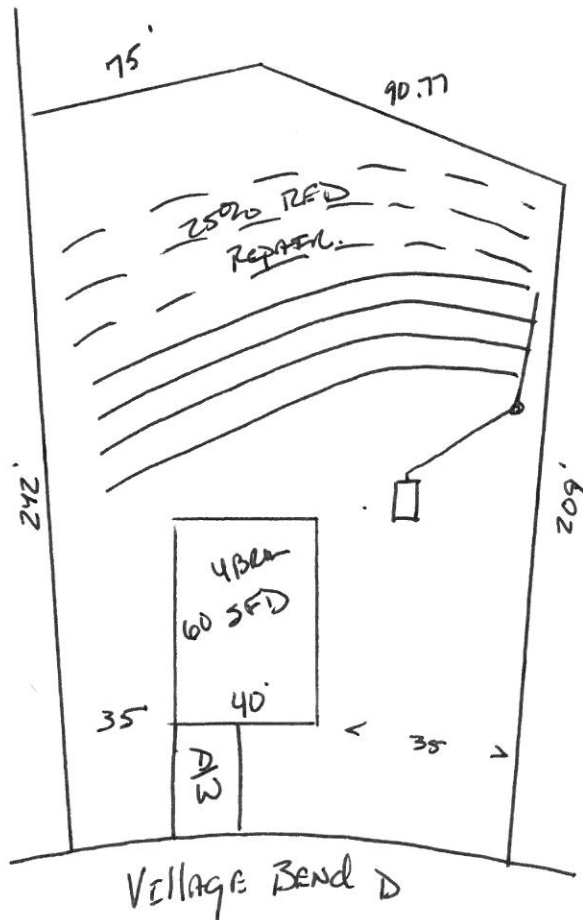

Olde Mill Village

Lot #13

4-Bedroom Home (480 gal./day)

<u>LINE #</u>	<u>COLOR</u>	<u>BS</u>	<u>HI</u>	<u>FS</u>	<u>ELEVATION</u>	<u>LINE LENGTH</u>	<u>Design Length</u>
TBM		0.0		100.0		<u>in field</u>	<u>installation</u>
INST. 1			100.0				
1	Blue			4.5	95.5	100	100
2	Pink			5	95	120	100
3	Orange			5.5	94.5	128	100
4	White			5.9	94.1	135	100
5	Red			6.4	93.6	135	135
6	Blue			7.1	92.9	135	135
7	Pink			8.2	91.8	135	135
Total						888	805

	<u>System</u>	<u>Repair</u>
	Lines 1-4	Lines 5-7
System Type	Accepted Status System EZ-FLOW	Accepted Status System EZ-FLOW
Suggested Soil LTAR	0.30	0.30
Total Line Length	400	405
Square Footage	1200	1215
Proposed Trench Bottom	24"	18"
Distribution Method	Gravity to D-Box	Gravity to D-Box