



**ECS Southeast, LLC**

6151 Raeford Road, Suite A  
Fayetteville, NC 28304  
9104013288  
9103230539

**LETTER OF TRANSMITTAL**

October 21, 2024  
Patim, Inc  
650 Posey Farm Rd  
Raeford, NC 28376  
ATTN: Tim Hawkes

RE: **Caldwell Home**  
ECS Job # **33:7069**  
  
Permits:  
Location: **553 Farrar Dairy Rd**  
**Lillington, NC 27546**

Field Reports       For your use       As requested

CC:

ENCL: Field Report # 1      10/18/2024



**OCT 21 2024**

Jack Cowsert, P.E.  
Office Manager

Aaron Kyle Adair  
CMT Senior Project Coordinator

*Disclaimer*

1. This report (and any attachments) shall not be reproduced except in full without prior written approval of ECS.
2. The information in this report relates only to the activities performed on the report date.
3. Where appropriate, this report includes statements as to compliance with applicable project drawings, and specifications for the activities, performed on this report date.
4. Incomplete or non-conforming work will be reported for future resolution.
5. The results of samples and/or specimens obtained or prepared for subsequent laboratory testing will be presented in separate reports/documents.



ECS Southeast, LLC  
6151 Raeford Road, Suite A  
Fayetteville, NC 28304  
(910) 401-3288 [Phone]  
(910) 323-0539 [Fax]

## FIELD REPORT

Project **Caldwell Home**  
Location **Lillington, NC**  
Client **Patim, Inc**  
Contractor **None Listed**

Project No. **33:7069**  
Report No. **1**  
Day & Date **Friday 10/18/2024**  
Weather **70 °/ Sunny**  
On-Site Time **1.25**  
Lab Time **0.00**  
Travel Time\* **0.00**  
Total **1.25**  
Re Obs Time **0.00**

Remarks					
Trip Charges*	Tolls/Parking*	Mileage*	Time of	Arrival	Departure
Chargeable Items				<b>1:00P</b>	<b>2:15P</b>

\* Travel time and mileage will be billed in accordance with the contract.

**Summary of Services Performed (field test data, locations, elevations & depths are estimates) & Individuals Contacted.**

ECS Representative arrived on site, as requested, to check the bearing capacity of soils via hand auger/DCP method (ASTM STP-399) for monolithic slab. Please see the attached sketch and data sheet for details.

A total of 4 hand auger/DCP evaluations were performed to a depth of approximately 3 feet below the current footing subgrade elevation. Test results indicated that the materials in place (at the locations and elevations tested) did appear to be suitable to support the design bearing capacity of 2,000 psf.

ECS will return upon request to provide additional services.

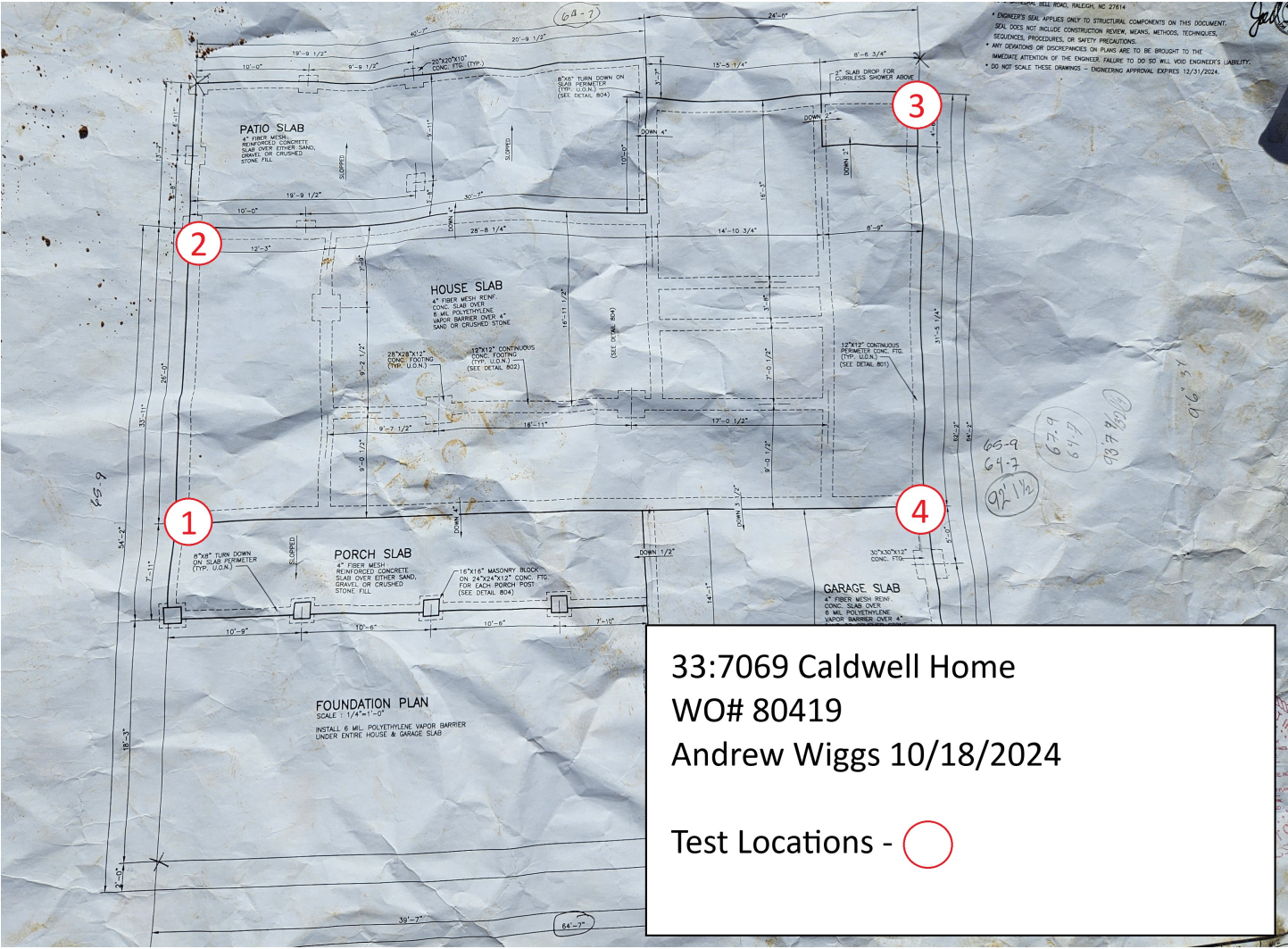

33:7069 Caldwell Home  
 WO# 80419  
 Andrew Wiggs 10/18/2024



ECS Southeast, LLC  
 Fayetteville, NC  
 Phone: 910-401-3288

**DYNAMIC CONE PENETROMETER TEST REPORT**

Project: Caldwell Home								Design Bearing Capacity: 2000 psf
Project No: 7069								Monolithic Slab Footings
Technician: Andrew Wiggs								
Date: 10/18/2024								
Test Location	Water Table Depth	Test Depth	Footing Dimensions	Penetrometer Blow Counts				Remarks/Soil Descriptions
				1 3/4"	1 3/4"	1 3/4"	Average	
1		0		8	8	9	8.5	Brown Clayey Sand
1		-1		15			15	Brown Clayey Sand
1		-2		7	9	10	9.5	Brown Clayey Sand
1		-3		13	15		15	Brown Clayey Sand
2		0		7	9	11	10	Brown Clayey Sand
2		-1		9	11	13	12	Brown Clayey Sand
2		-2		13	15		15	Tan Sand
2		-3		8	8	8	8	Gray Silty Sand
3		0		8	8	10	9	Brown Clayey Sand
3		-1		13	15		14	Gray Silty Sand
3		-2		13	10	10	10	Gray Silty Sand
3		-3		7	13	15	14	Brown Clayey Sand
4		0		7	15		15	Brown Clayey Sand
4		-1		10	12	13	12.5	Brown Clayey Sand
4		-2		7	11	11	11	Brown Clayey Sand
4		-3		15			15	Brown Clayey Sand

# Attachments



overview

Figure 1