

**SOIL/SITE EVALUATION
 for ON-SITE WASTEWATER SYSTEM**

Cummin Plantation

Owner: Applicant: *Laimco Custom Builders*
 Address: Date Evaluated: *5/18/2020*
 Proposed Facility: *SFD* Design Flow (.1949): *360 GPD* Property Size:
 Location of Site: Property Recorded:
 Water Supply: Public Individual Well Spring Other
 Evaluation Method: Auger Boring Pit Cut
 Type of Wastewater: Sewage Industrial Process Mixed

P R O F I L E #	.1940 Landscape Position/ Slope %	Horizon Depth (In.)	SOIL MORPHOLOGY .1941		OTHER PROFILE FACTORS				Profile Class & LTAR
			.1941 Structure/ Texture	.1941 Consistence Mineralogy	.1942 Soil Wetness/ Color	.1943 Soil Depth (IN.)	.1956 Sapro Class	.1944 Restr Horiz	
1	L < 5%	0-24	GR LS	VFR SXP	NSNP				
		24-40	BK SCL	Fi SXP	SSSP	40"			PS 0.4
2	L < 5%	0-31	GR LS	VFR SXP	NSNP	10x7" @34"			PS 0.4

Description	Initial System	Repair System	Other Factors (.1946): Site Classification (.1948):
Available Space (.1945)	✓	✓	PS
System Type(s)	25' led	25' lead	Evaluated By: BA
Site LTAR	0.4	0.4	Others Present:

COMMENTS: _____

LANDSCAPE POSITIONS	GROUP	TEXTURES	.1955 LTAR	CONSISTENCE MOIST	WET
R-RIDGE	I	S-SAND	1.2 - 0.8	VFR-VERY FRIABLE	NS-NON-STICKY
S-SHOULDER SLOPE		LS-LOAMY SAND			
L-LINEAR SLOPE	II	SL-SANDY LOAM	0.8 - 0.6	FI-FIRM	SS-SLIGHTY STICKY
FS-FOOT SLOPE		L-LOAM			
N-NOSE SLOPE					
H-HEAD SLOPE	III	SI-SILT	0.6 - 0.3	EFI-EXTREMELY FIRM	VS-VERY STICKY
CC-CONCLAVE SLOPE		SIL-SILT LOAM			
CV-CONVEX SLOPE		CL-CLAY LOAM			
T-TERRACE		SCL-SANDY CLAY LOAM			
FP-FLOOD PLAN	IV	SIC-SILTY CLAY	0.4 - 0.1		NP-NON-PLASTIC
		C-CLAY			
		SC-SANDY CLAY			

STRUCTURE
 SG-SINGLE GRAIN
 M-MASSIVE
 CR-CRUMB
 GR-GRANULAR
 SBK-SUBANGULAR BLOCKY
 ABK-ANGULAR BLOCKY
 PL-PLATY
 PR-PRISMATIC

MINERALOGY
 SLIGHTLY EXPANSIVE
 EXPANSIVE

Show profile locations and other site features (dimensions, references or benchmark, and North)

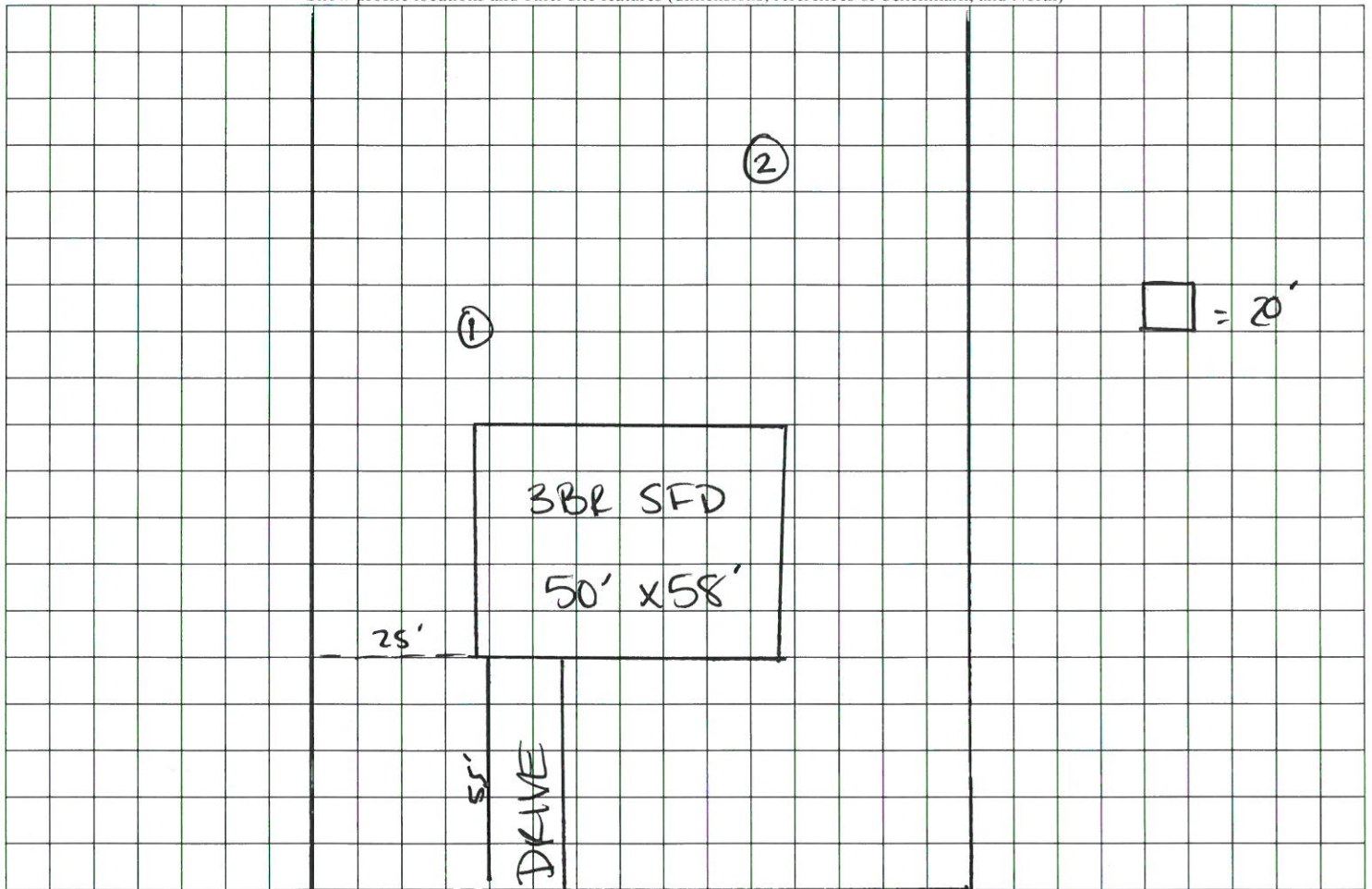

Southern PI