

HTE# _____

Harnett County Department of Public Health

No. 26495

PERMIT # SFD2004-002L

Operation Permit

New Installation Septic Tank Nitrification Line Repair Expansion

PROPERTY LOCATION: 4641 NC 27, W Lillington

Name: (owner) Paul Lyon SUBDIVISION _____ LOT # _____

System Installer: Larry Sharpe Registration # _____

Basement with plumbing: Garage Number of Bedrooms 3

Type of Water Supply: Community Public Well Distance from well _____ feet

System Type: Conventional (Tire chip) Types V and VI Systems expire in 5 years.

(In accordance with Table V a)

Owner must contact Health Department 6 months prior to expiration for permit renewal.

This system has been installed in compliance with applicable North Carolina General Statutes, Rules for Sewage Treatment and Disposal, and all conditions of the Improvement Permit and Construction Authorization.

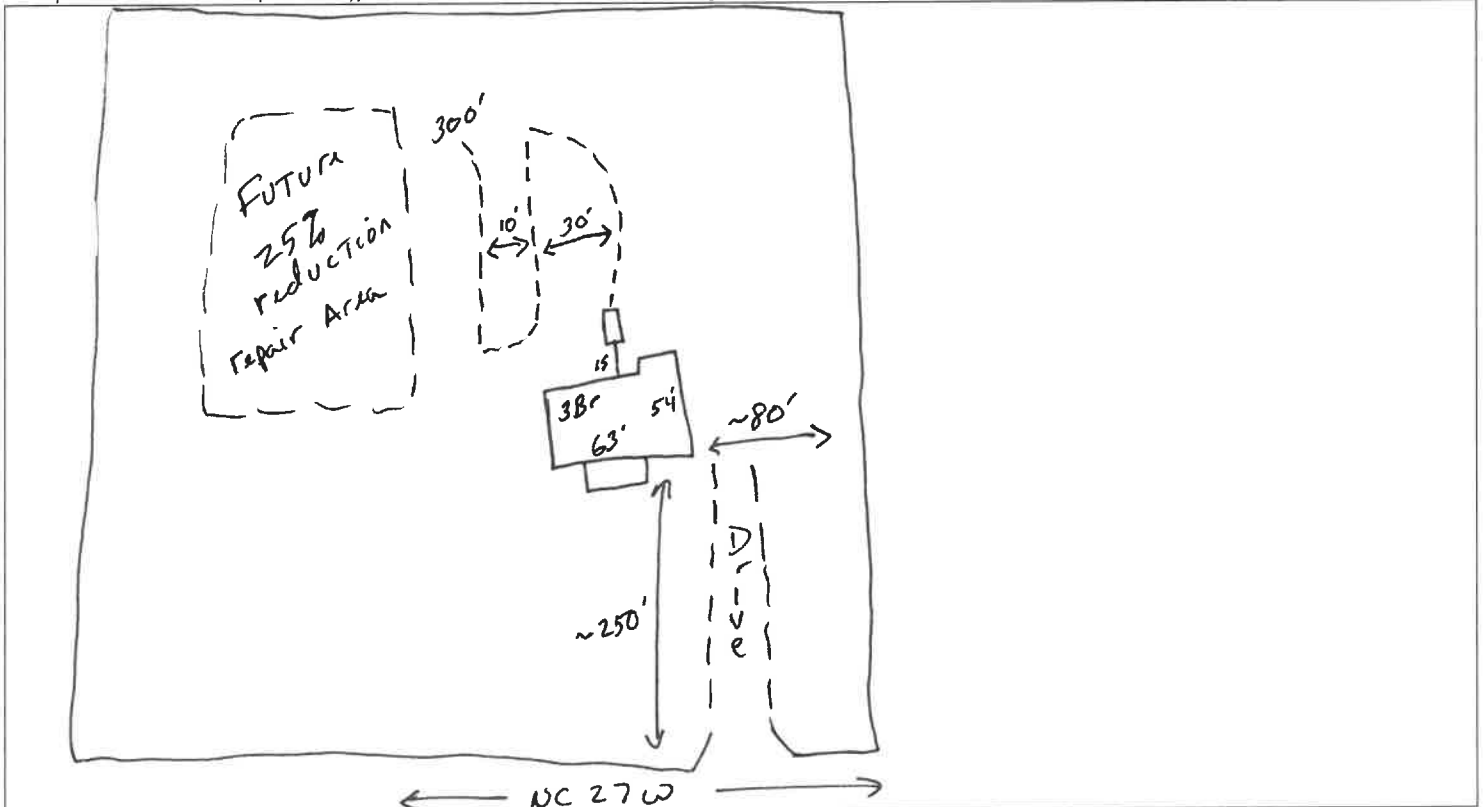

PERMIT CONDITIONS:

- I. Performance: System shall perform in accordance with Rule .1961.
- II. Monitoring: As required by Rule .1961.
- III. Maintenance: As required by Rule .1961. Other: _____
Subsurface system operator required? Yes No
If yes, see attached sheet for additional operation conditions, maintenance and reporting.
- IV. Operation: _____
- V. Other: _____

_____ D-Box _____ Pump _____ Alarm _____ H2O Line _____ PWR Line

Following are the specifications for the sewage disposal system on the above captioned property.

Type of system: Conventional Other _____ Septic Tank: 1000 gallons Pump Tank: _____ gallons
 Subsurface No. of exact length width of depth of
 Drainage Field ditches 1 of each ditch 300 feet ditches 3 feet ditches 23" inches
 French Drain Required: _____ Linear feet

Authorized State Agent Mal Oh REHS Date 1-21-21