

Olde Mill Village
 4-Bedroom Septic Proposal
 Lot #29

29
 93,103 SF
 2.137 AC

S 66°24'17"E 236.17'

S 48°12'07"W

S 12°15'34"W
 144.45'

369.46'

257.89'

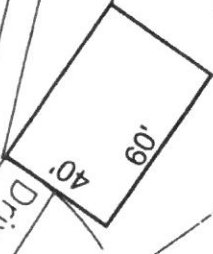

70.88'

*Preliminary Design
 Not a Permit

If plumbing is not sufficient
 a pump and tank may be
 required to septic drain field.

System: Gravity to D-Box
 Lines: 1-4 (400')
 0.3 LTAR
 24" Trench Bottom
 Accepted Status System
 Repair: Pressure Manifold
 Lines: 5-10 (400')
 0.3 LTAR
 24" Trench Bottom
 Accepted Status System

Adams
 Soil Consulting
 919-414-6761
 Job #699

GRAPHIC SCALE
 1" = 60'



Wood Spring Court
 50' Public R/W

Drive

