

**SOIL/SITE EVALUATION  
 for ON-SITE WASTEWATER SYSTEM**

Owner:                      Applicant: **Weaver Homes Inc**  
 Address:                      Date Evaluated: **3/30/2020**  
 Proposed Facility: **SFD 42'x62'** Design Flow (.1949): **360 GPD**      Property Size:  
 Location of Site: **6026 Rosser Pk** Property Recorded:  
 Water Supply:       Public     Individual     Well       Spring       Other  
 Evaluation Method:  Auger Boring       Pit       Cut  
 Type of Wastewater:       Sewage       Industrial Process       Mixed

P R O F I L E #	.1940 Landscape Position/ Slope %	Horizon Depth (In.)	SOIL MORPHOLOGY .1941		OTHER PROFILE FACTORS				Profile Class & LTAR
			.1941 Structure/ Texture	.1941 Consistence Mineralogy	.1942 Soil Wetness/ Color	.1943 Soil Depth (IN.)	.1956 Sapro Class	.1944 Restr Horiz	
1	L < 5%	0-12	GR LS	VFR SEXP NSNP					
		12-48	BK SCL	FR SEXP SSPP		48"			PS 0.45
2	L < 5%	0-20	GR LS	VFR SEXP NSNP					
		20-30	GR SL	VFR SEXP NSNP					
		30-48	BK SCL	FR SEXP SSPP		48			PS 0.45

Description	Initial System	Repair System	Other Factors (.1946):
Available Space (.1945)			Site Classification (.1948): <b>Provisionally suitable</b>
System Type(s)	<b>25% Red</b>	<b>25% Red</b>	Evaluated By: <b>Brittany Adams</b>
Site LTAR	<b>0.45</b>	<b>0.45</b>	Others Present:

COMMENTS: \_\_\_\_\_

LANDSCAPE POSITIONS	GROUP	TEXTURES	.1955 LTAR	CONSISTENCE MOIST	WET
R-RIDGE	I	S-SAND	1.2 - 0.8	VFR-VERY FRIABLE	NS-NON-STICKY
S-SHOULDER SLOPE		LS-LOAMY SAND		FR-FRIABLE	SS-SLIGHTY STICKY
L-LINEAR SLOPE	II	SL-SANDY LOAM	0.8 - 0.6	FI-FIRM	S-STICKY
FS-FOOT SLOPE		L-LOAM		VFI-VERY FIRM	VS-VERY STICKY
N-NOSE SLOPE	III	SI-SILT	0.6 - 0.3	EFI-EXTREMELY FIRM	NP-NON-PLASTIC
H-HEAD SLOPE		SIL-SILT LOAM		SP-SLIGHTLY STICKY	
CC-CONCLAVE SLOPE		CL-CLAY LOAM		P-PLASTIC	
CV-CONVEX SLOPE		SCL-SANDY CLAY LOAM		VP-VERY PLASTIC	
T-TERRACE	IV	SIC-SILTY CLAY	0.4 - 0.1		
FP-FLOOD PLAN		C-CLAY			
		SC-SANDY CLAY			

STRUCTURE

- SG-SINGLE GRAIN
- M- MASSIVE
- CR-CRUMB
- GR-GRANULAR
- SBK-SUBANGULAR BLOCKY
- ABK-ANGULAR BLOCKY
- PL-PLATY
- PR-PRISMATIC

MINERALOGY

- SLIGHTLY EXPANSIVE
- EXPANSIVE

Show profile locations and other site features (dimensions, references or benchmark, and North)

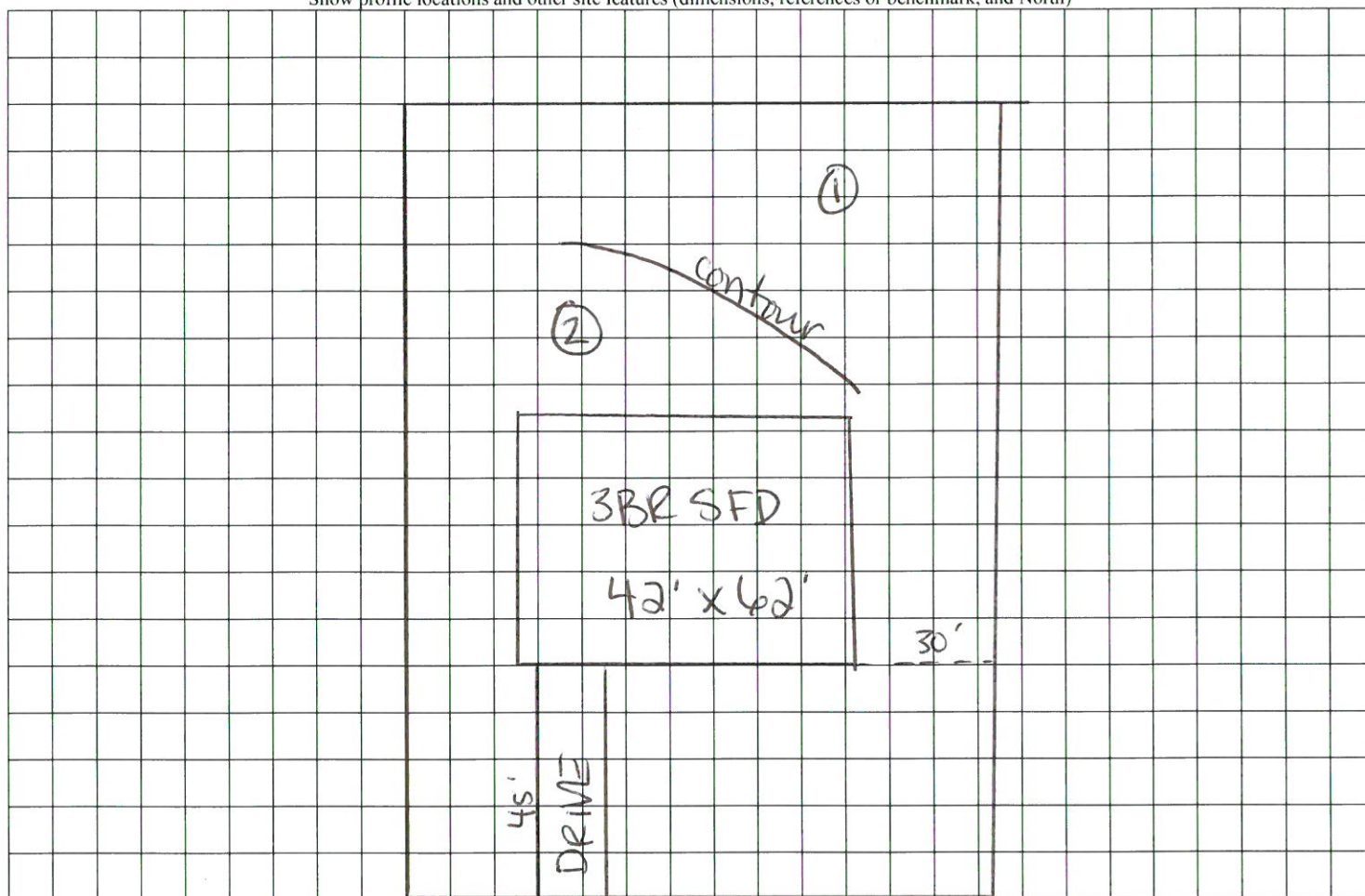

Rosser Pittman Rd