

Harnett County Department of Public Health

PERMIT # SFD2003-0050

Operation Permit

New Installation Septic Tank Nitrification Line Repair Expansion

PROPERTY LOCATION: 5986 ROSSER PITMAN RD

Name: (owner) WEAVER HOMES INC SUBDIVISION PITMAN FARM LOT # 1

System Installer: YELLOW DOG

Basement with plumbing: Garage Number of Bedrooms 4

Type of Water Supply: Community Public Well Distance from well _____ feet

System Type: ITS Types V and VI Systems expire in 5 years.

(In accordance with Table V a)

Owner must contact Health Department 6 months prior to expiration for permit renewal.

This system has been installed in compliance with applicable North Carolina General Statutes, Rules for Sewage Treatment and Disposal, and all conditions of the Improvement Permit and Construction Authorization.

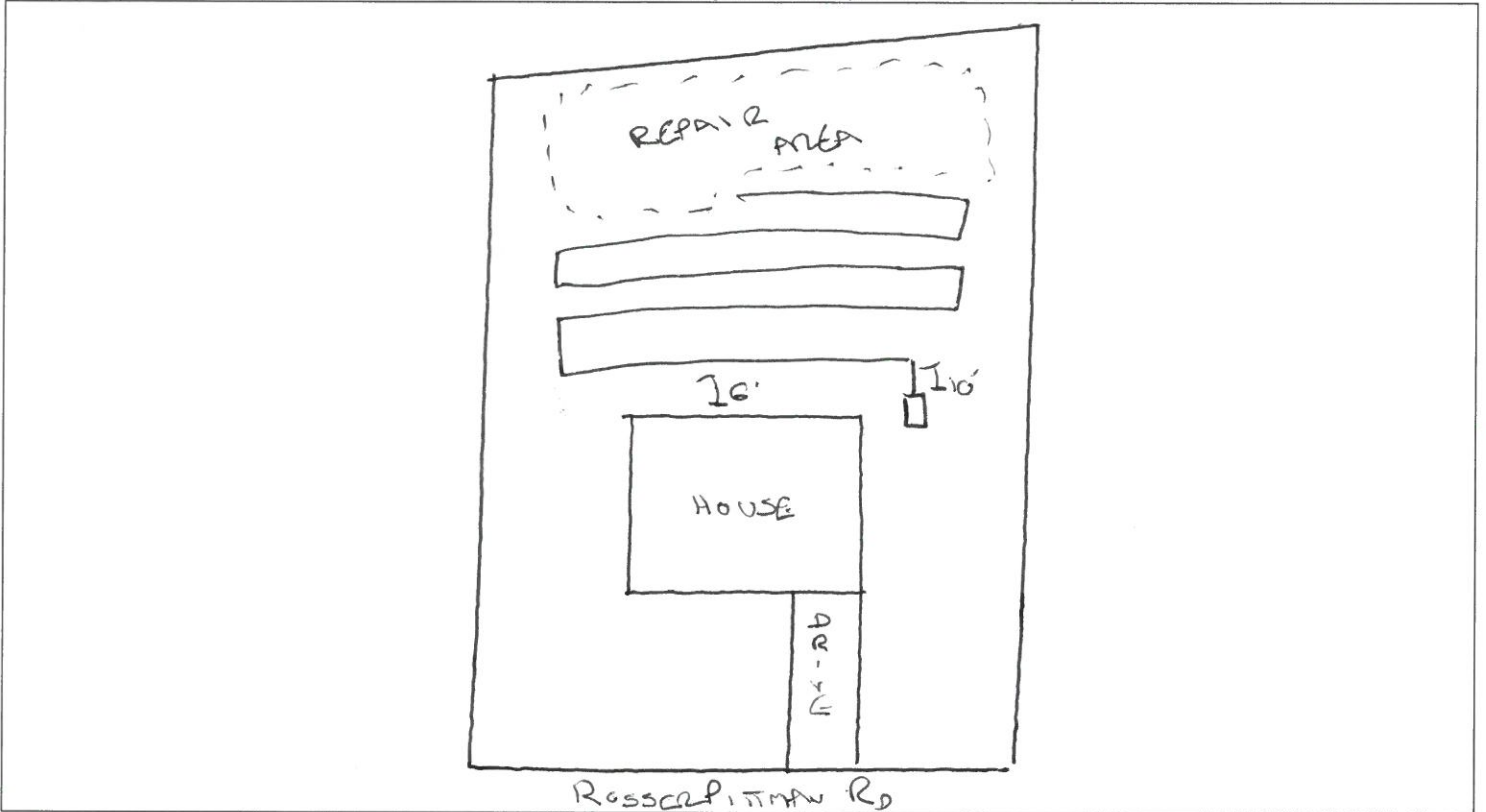

PERMIT CONDITIONS:

- I. Performance: System shall perform in accordance with Rule .1961.
- II. Monitoring: As required by Rule .1961.
- III. Maintenance: As required by Rule .1961. Other: _____
Subsurface system operator required? Yes No
If yes, see attached sheet for additional operation conditions, maintenance and reporting.
- IV. Operation: _____
- V. Other: _____

D-Box Pump Alarm H2O Line PWR Line

Following are the specifications for the sewage disposal system on the above captioned property.

Type of system: Conventional Other CHAMBER (24") Septic Tank: 1600 gallons Pump Tank: _____ gallons
Subsurface Drainage Field No. of ditches 1 exact length of each ditch 270 feet width of ditches 3 feet depth of ditches 18-24 inches
French Drain Required: _____ Linear feet

Authorized State Agent [Signature] Date 9/8/20