

Harnett County Department of Public Health

Improvement Permit

A building permit cannot be issued with only an Improvement Permit

ISSUED TO: NOBBIE POPE PROPERTY LOCATION: 920 BRICK MILL RD (SA 2005)
 SUBDIVISION _____ LOT # _____
 NEW REPAIR EXPANSION Site Improvements required prior to Construction Authorization Issuance: _____
 Type of Structure: 3-BEDROOM 58' x 74' SFD
 Proposed Wastewater System Type: PUMP TO 2596 MED. SYS.
 Projected Daily Flow: 366 GPD
 Number of bedrooms: 3 Number of Occupants: 6 max
 Basement Yes No
 Pump Required: Yes No May be required based on final location and elevations of facilities
 Type of Water Supply: Community Public Well Distance from well NA feet Permit valid for: Five years
 No expiration
 Permit conditions: _____

Authorized State Agent: [Signature] Date: 04/13/2020 SEE ATTACHED SITE SKETCH
 The issuance of this permit by the Health Department in no way guarantees the issuance of other permits. The permit holder is responsible for checking with appropriate governing bodies in meeting their requirements. This site is subject to revocation if the site plan, plat, or the intended use changes. The Improvement Permit shall not be affected by a change in ownership of the site. This permit is subject to compliance with the provisions of the Laws and Rules for Sewage Treatment and Disposal and to conditions of this permit.

Construction Authorization

(Required for Building Permit)

The construction and installation requirements of Rules 1950, 1952, 1954, 1955, 1956, 1957, 1958, and 1959 are incorporated by references into this permit and shall be met. Systems shall be installed in accordance with the attached system layout.

ISSUED TO: NOBBIE POPE PROPERTY LOCATION: 920 BRICK MILL RD (SA 2005)
 SUBDIVISION _____ LOT # _____
 Facility Type: 36" 58' x 24' SFD New Expansion Repair
 Basement? Yes No Basement Fixtures? Yes No
 Type of Wastewater System** 2596 REDUCTION SYSTEM (Initial) Wastewater Flow: 360 GPD
 (See note below, if applicable 2596 REDUCTION SYS. (Repair))

Installation Requirements/Conditions

Septic Tank Size <u>1000</u> gallons	Number of trenches <u>4</u>	Trench Spacing: <u>9</u> Feet on Center
Pump Tank Size <u>1000</u> gallons	Exact length of each trench <u>66</u> feet	Soil Cover: <u>12</u> inches
	Trenches shall be installed on contour at a	(Maximum soil cover shall not exceed
	Maximum Trench Depth of: <u>24</u> inches	36" above the trench bottom)
	(Trench bottoms shall be level to +/- 1/4"	
	in all directions)	
Pump Requirements: _____ ft. TDH vs. _____ GPM		Aggregate Depth: <u>NA</u> inches below pipe
		<u>NA</u> inches above pipe
Conditions: _____		<u>NA</u> inches total

**WATER LINES (INCLUDING IRRIGATION) MUST BE 10FT. FROM ANY PART OF SEPTIC SYSTEM OR REPAIR AREA.
NO UTILITIES ALLOWED IN INITIAL OR REPAIR DRAIN FIELD AREA.**

****If applicable:** I understand the system type specified is different from the type specified on the application. I accept the specifications of this permit.

Owner/Legal Representative Signature: _____ Date: _____

This Construction Authorization is subject to revocation if the site plan, plat, or the intended use changes. The Construction Authorization shall not be transferred when there is a change in ownership of the site. This Construction Authorization is subject to compliance with the provisions of the Laws and Rules for Sewage Treatment and Disposal and to the conditions of this permit. SEE ATTACHED SITE SKETCH

Authorized State Agent: [Signature] Date: 04/13/2020
ANDREW CURRIS Construction Authorization Expiration Date: 04/13/2025

Application # SFD2003-0044

Harnett County Department of Public Health Site Sketch

Property Location: 920 BRICK MILL ROAD (SL 2005)

Issued To: ROBBIE POPE Subdivision _____ Lot # _____

Authorized State Agent: *Andrew Curran* Date: 04/13/2020
ANDREW CURRAN

- * PUMP TO MEDIUM/LARGE D-BOX w/ 25% REDUCTION SMS.
- * SEPTIC AREA CLEARED EXCEPT FOR 7-10 SMALL PINES MARKED w/ RED FLAGS
- * SMS, FLAGGED ON SITE w/ WHITE/BLUE FLAGS

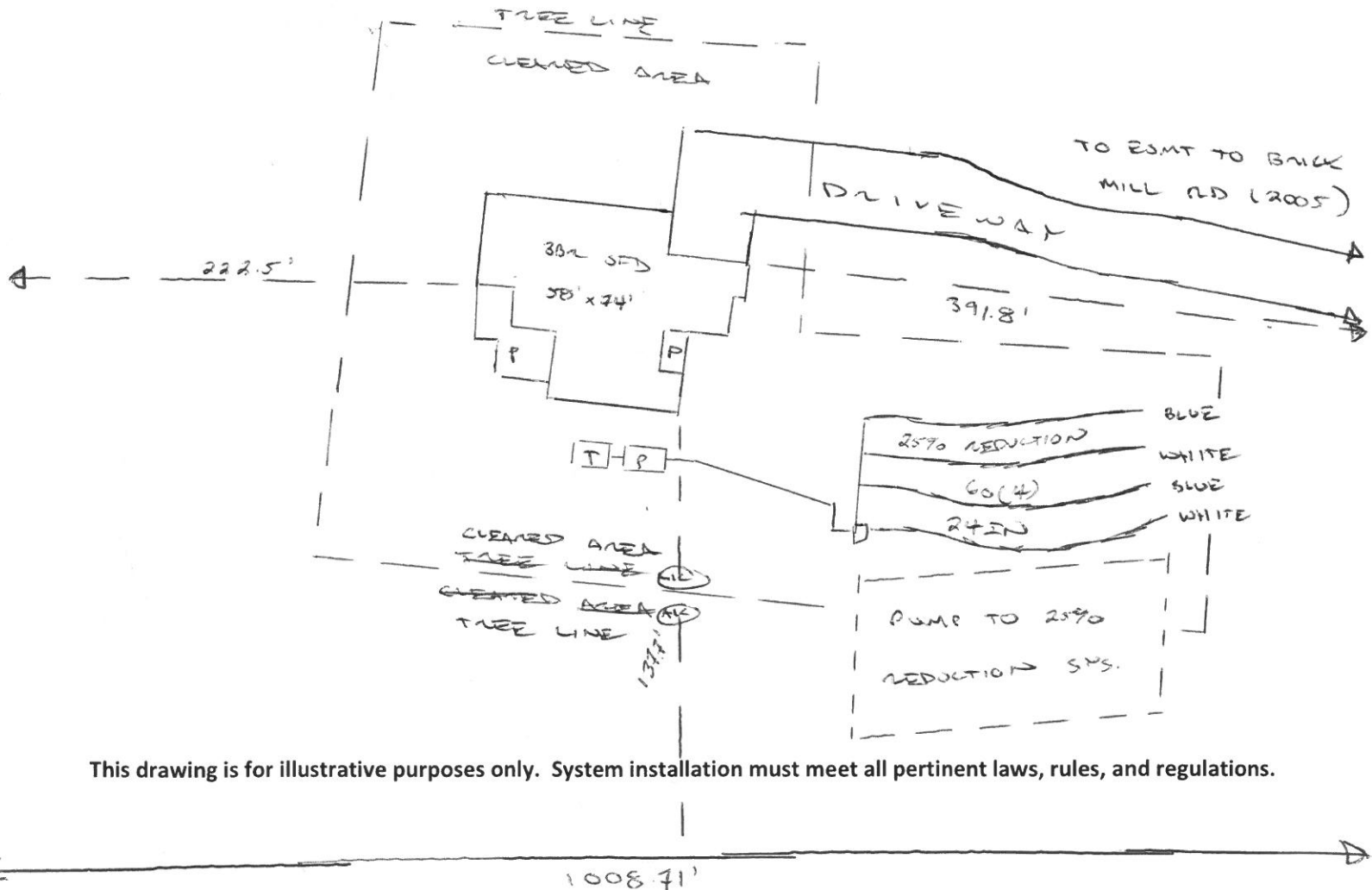

This drawing is for illustrative purposes only. System installation must meet all pertinent laws, rules, and regulations.