

**FEMA FLOOD HAZARD STATEMENT**  
 Lots shown on this plat are not located within the FEMA 100 year Flood Hazard Area as shown on FEMA map No. 3720068000J & 3720059900J Effective date: 10/3/2006

**Town of Coats ~ RA  
 Minimum Building  
 Setback Requirements**  
 FRONT: 40' from R/W  
 REAR: 30'  
 SIDE: 15'  
 MAXIMUM HEIGHT: 35'

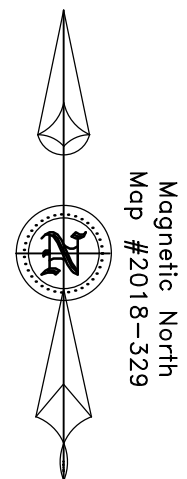

Magnetic North  
 Map #2018-529

**SYMBOLS & ABBREVIATIONS:**

- EIP/EIS... Existing Iron Pipe or Stake
- ERB..... Existing ReBar Stake
- ERRS... Existing Rail Road Spike
- EPK..... Existing Parker-Kaylon Nail
- EMN..... Existing Magnetic Nail
- ECS..... Existing Cotton Picker Spindle
- ⊠ ECM..... Existing Concrete Monument
- AG/BG..... Above/Below Ground Surface
- △ CP..... Calculated Point (not set)
- ⊙ CNTRL..... Control Point - Grid Coordinates
- ISS..... Iron Stake Set (#4 rebar)
- MNS..... Magnetic Nail Set
- CSS..... Cotton Spindle Set
- ⊕ FH..... Fire Hydrant
- ⊙ PP..... Power Pole
- OHE..... Overhead Electric Lines
- ↔ Land Hook (Property combined)
- C/L..... Centerline of Road or Easement
- R/W..... Right-of-Way
- D.B..... Deed Book
- P.B/P.C..... Plat Book / Plat Cabinet
- M.B..... Map Book
- NC\_PIN..... Parcel Identifier Number
- Ac..... Acres (Area of property)
- SF..... Square Feet
- [123]..... House Address

**LINE LEGEND:**

- Subject Boundary Surveyed
- - - Subject Boundary Not Surveyed
- Adjacent Property Lines
- ..... Abandoned Property Lines
- Right of Way Lines
- Easement Lines
- Survey Tie Lines
- OHE Overhead Electric Lines
- Center of Right-of-Way
- Minimum Building Setback
- Water Line

Lamas Denning  
 D.B. 1893, Pg. 529

Tract 2  
 10.10 Acres

James DeRayon Hartman  
 & Martha Ruth Hartman  
 D.B. 3662, Pg. 945  
 Map # 2018-329

David W. Watkins  
 D.B. 3625, Pg. 579  
 Map # 2018-202

Tanya Parrish Grant  
 D.B. 3662, Pg. 970  
 Map # 2019-314  
 Map # 2018-329

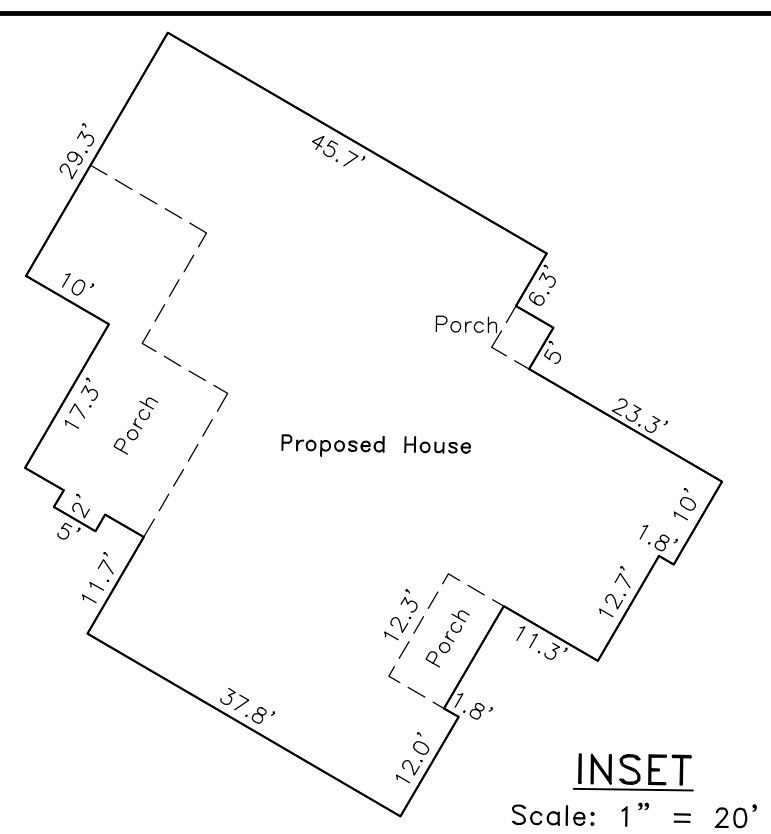

**~PRELIMINARY PLOT PLAN~**  
 - Not an actual survey -  
 This plan represents proposed improvements to a lot of record. This plan is subject to review and approval by County Planning and Inspections Departments.

NOT FOR RECORDATION

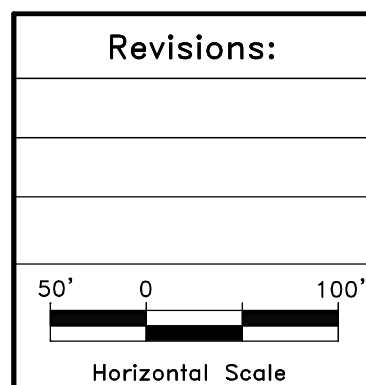

<b>"PLOT PLAN"</b>	
Map For: <b>Jeffrey &amp; Brandy Armstrong</b>	
Care of: Robert Pope Builders, LLC Deed Book 3715, Page 883 and Map #2018-329	
TOWNSHIP: Grove	COUNTY: Harnett
TOWN: Coats ETJ	STATE: NORTH CAROLINA
ZONE: RA	Parcel Number: 0690-20-8756.000

<b>STREAMLINE LAND SURVEYING, Inc.</b>		
NC FIRM C-1898		
870 NC 55 W, Coats, N.C. 27521		
Phone: 910-897-7715		
DATE: March 24, 2020	SCALE: 1" = 100'	SURVEYED BY: R.E.G. DRAWN BY: M.G.G.
FILE: 0599\190802RA\200323AR.dwg (PlotPlan)		