

Harnett County Department of Public Health Improvement Permit

A building permit cannot be issued with only an Improvement Permit

ISSUED TO: JESUS MACIAS LEON PROPERTY LOCATION: 31 THORNTONS CREEK (OLD STAGES S) ^{SA 1769}
 SUBDIVISION: THORNTONS CREEK LOT # 1
 NEW REPAIR EXPANSION
 Type of Structure: 3-BEDRM 54'x56' S/D
 Proposed Wastewater System Type: 25% REDUCTION S/D
 Projected Daily Flow: 360 GPD
 Number of bedrooms: 3 Number of Occupants: 6 max
 Basement Yes No
 Pump Required: Yes No May be required based on final location and elevations of facilities
 Type of Water Supply: Community Public Well Distance from well NA feet
 Permit valid for: Five years No expiration
 Permit conditions: _____

Authorized State Agent: [Signature] Date: 07/06/2020 SEE ATTACHED SITE SKETCH
 The issuance of this permit by the Health Department in no way guarantees the issuance of other permits. The permit holder is responsible for checking with appropriate governing bodies in meeting their requirements. This site is subject to revocation if the site plan, plat, or the intended use changes. The Improvement Permit shall not be affected by a change in ownership of the site. This permit is subject to compliance with the provisions of the Laws and Rules for Sewage Treatment and Disposal and to conditions of this permit.

Construction Authorization (Required for Building Permit)

The construction and installation requirements of Rules 1950, 1952, 1954, 1955, 1956, 1957, 1958, and 1959 are incorporated by references into this permit and shall be met. Systems shall be installed in accordance with the attached system layout.

ISSUED TO: JESUS MACIAS LEON PROPERTY LOCATION: 31 THORNTONS CREEK (OLD STAGES S) ^{SA 1769}
 SUBDIVISION: THORNTONS CREEK LOT # 1
 Facility Type: 3BR 54'x56' S/D New Expansion Repair
 Basement? Yes No Basement Fixtures? Yes No
 Type of Wastewater System** AT-GRADE 25% REDUCTION S/D (Initial) Wastewater Flow: 360 GPD
 (See note below, if applicable)
AT-GRADE 25% RED. S/D (Repair)
 Installation Requirements/Conditions
 Septic Tank Size 1000 gallons
 Pump Tank Size 1000 gallons
 Number of trenches 2
 Exact length of each trench 130 feet
 Trenches shall be installed on contour at a
 Maximum Trench Depth of: 15 inches
 (Trench bottoms shall be level to +/-1/4"
 in all directions)
 Trench Spacing: 9 Feet on Center
 Soil Cover: 6 inches (SUPPORT)
 (Maximum soil cover shall not exceed
 36" above the trench bottom)
 Pump Requirements: _____ ft. TDH vs. _____ GPM
 Aggregate Depth: NA inches below pipe
NA inches above pipe
 Conditions: AT-GRADE, 6IN IMPACT SOIL COVER REQUIRED NA inches total

**WATER LINES (INCLUDING IRRIGATION) MUST BE 10FT. FROM ANY PART OF SEPTIC SYSTEM OR REPAIR AREA.
 NO UTILITIES ALLOWED IN INITIAL OR REPAIR DRAIN FIELD AREA.**

**If applicable: I understand the system type specified is different from the type specified on the application. I accept the specifications of this permit.
 Owner/Legal Representative Signature: _____ Date: _____

This Construction Authorization is subject to revocation if the site plan, plat, or the intended use changes. The Construction Authorization shall not be transferred when there is a change in ownership of the site. This Construction Authorization is subject to compliance with the provisions of the Laws and Rules for Sewage Treatment and Disposal and to the conditions of this permit. SEE ATTACHED SITE SKETCH

Authorized State Agent: [Signature] Date: 07/06/2020
ANDREW CURRAN Construction Authorization Expiration Date: 07/06/2025

Application # SFD 2003-0041

Harnett County Department of Public Health Site Sketch

Property Location: 31 THORNTONS CREEK (OLD STAGE RD 3. - S. 1969)

Issued To: JESUS MACIAS LEON Subdivision THORNTONS CREEK Lot # 1

Authorized State Agent: *[Signature]* Date: 07/06/2020

ANDREAS CURRAN

- * PUMP TO MEDIUM SIZE D-BOX W/ EQUAL DISTRIBUTION
- * GDS IMPACT SOIL COVER REQUIRED
- * AT-GRADE SYSTEM
- * DO NOT DRIVE ON SEPTIC AREA
- * PROPOSED BY ADAMS SOIL CONSULTING

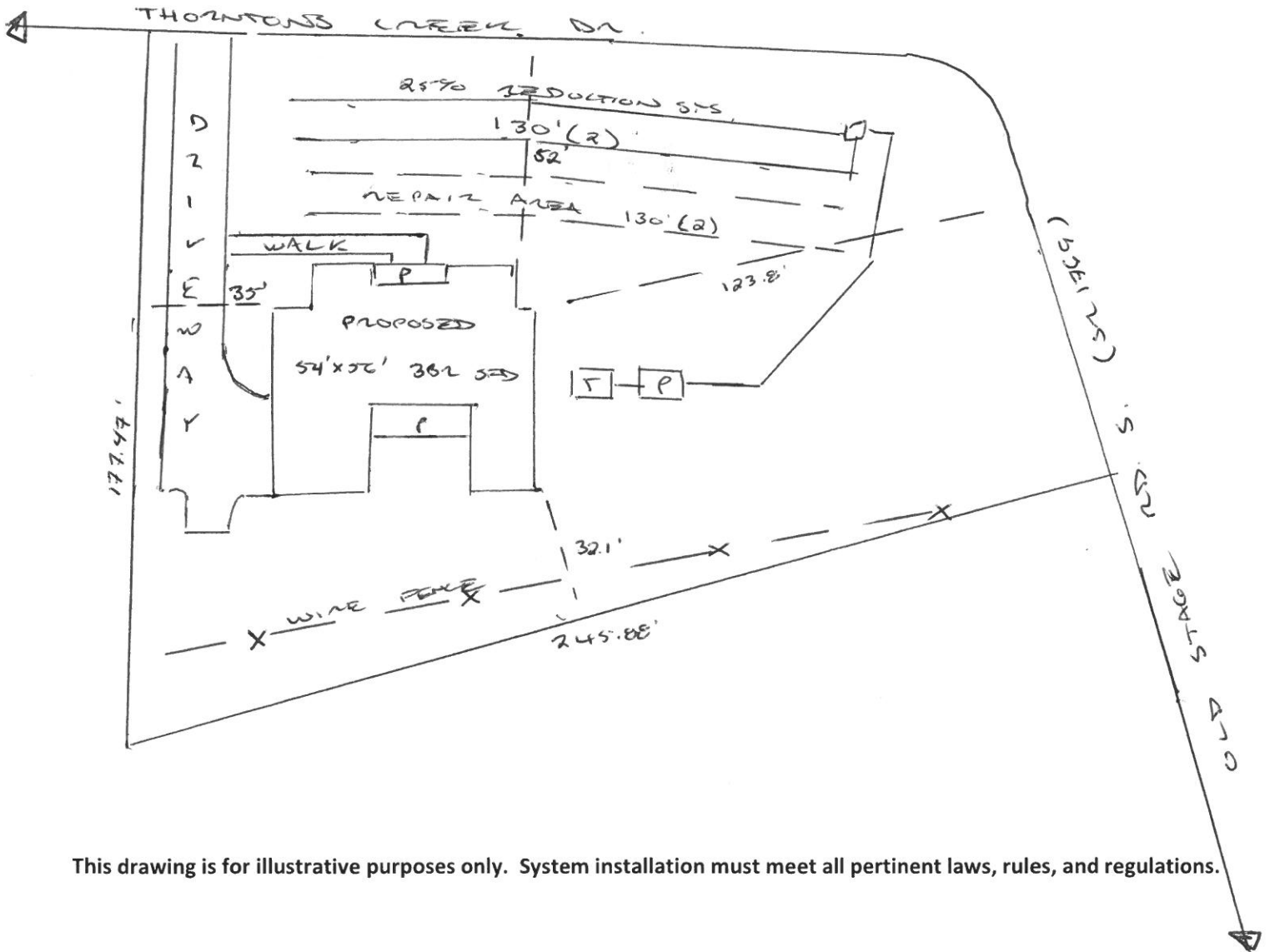

This drawing is for illustrative purposes only. System installation must meet all pertinent laws, rules, and regulations.

Thornton's Creek 3-Bedroom Septic Proposal Lot #1

Thornton's Creek Dr 50' Public R/W

SR 1769 Old Stage Rd

60' Public R/W

169.78'
A 169.94' R = 1139.44'



System: Pump to D-Box
Lines: 1-2 (260')
0.35 LTAR
15" Trench Bottom
Accepted Status System
Repair: Pump to D-Box
Lines: 3-4 (260')
0.35 LTAR
12" Trench Bottom
Accepted Status System

Soil Consulting
919-414-6761
Job #911

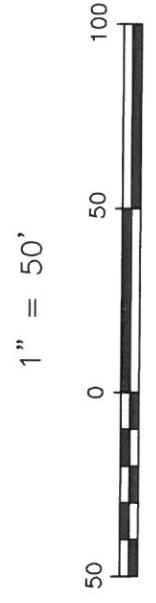

Thornton's Creek

Lot #1

3-Bedroom Home (360 gal./day)

<u>LINE #</u>	<u>COLOR</u>	<u>BS</u>	<u>HI</u>	<u>FS</u>	<u>ELEVATION</u>	<u>LINE LENGTH</u>	<u>Design Length</u>
TBM		3.0		100.0		<u>in field</u>	<u>installation</u>
INST. 1			103.0				
1	Blue			4.3	98.7	160	130
2	Pink			4.3	98.7	160	130
3	White			4.4	98.6	160	130
4	Yellow			4.5	98.5	160	130
				<u>System</u>		<u>Repair</u>	
				Lines 1-2		Lines 6-10	
	System Type			Accepted Status System		Accepted Status System	
				EZ-FLOW		EZ-FLOW	
	Suggested Soil LTAR			0.350		0.350	
	Total Line Length			260		260	
	Square Footage			780		780	
	Proposed Trench Bottom			15"		12"	
	Distribution Method			Pump to D-Box		Pump to D-Box	