

# Avery Pond 3-Bedroom Septic Proposal Lot #149

149

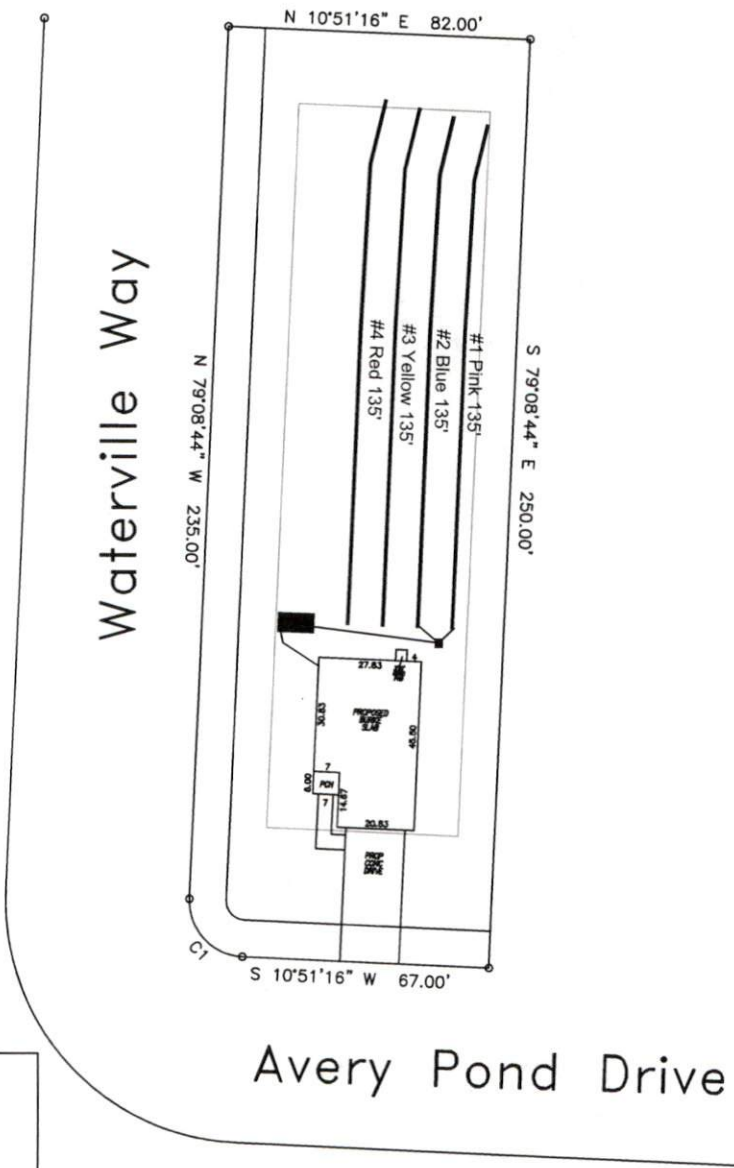

System: Gravity D-Box  
 Lines: 1-2 (270')  
 0.35 LTAR  
 18-24" Trench Bottom  
 Accepted Status System  
 Repair: Gravity to D-Box  
 Lines: 3-4 (270')  
 0.35 LTAR  
 18-24" Trench Bottom  
 Accepted Status System

GRAPHIC SCALE  
1" = 50'



Adams  
 Soil Consulting  
 919-414-6761  
 Job #708

**Avery Pond**  
**Lot #149**

3-Bedroom Home (360 gal./day)

<u>LINE #</u>	<u>COLOR</u>	<u>BS</u>	<u>HI</u>	<u>FS</u>	<u>ELEVATION</u>	<u>LINE LENGTH</u>	<u>Design Length</u>
TBM		2.0		100.0		<u>in field</u>	<u>installation</u>
INST. 1			102.0				
1	Pink			2.5	99.5	135	135
2	Blue			2.8	99.2	140	135
3	Yellow			3.3	98.7	145	135
4	Red			3.7	98.3	145	135
Total						565	540

**System**

Lines 1-2

**System Type**

Accepted Status System  
EZ-FLOW

**Repair**

Lines 3-4

Accepted Status System  
EZ-FLOW

Suggested Soil LTAR

0.35

0.35

**Total Line Length**

270

270

**Square Footage**

810

810

**Proposed Trench Bottom**

18-24"

18-24"

**Distribution Method**

Gravity to D-  
Box

Gravity to D-Box