

# Avery Pond 3-Bedroom Septic Proposal Lot #135

135

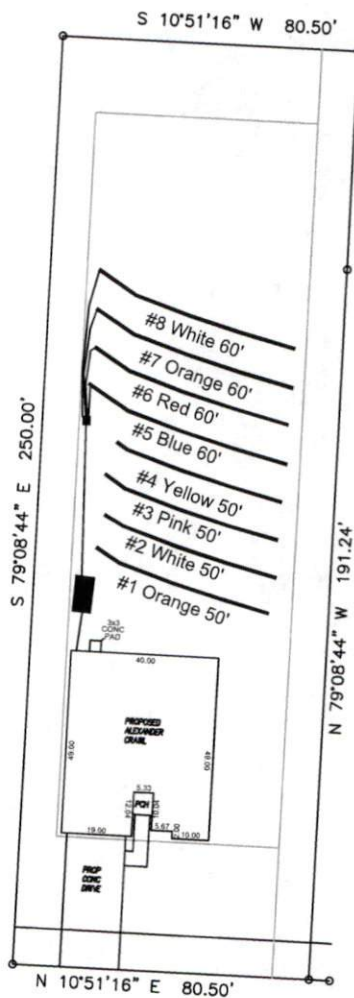

System: Gravity D-Box  
 Lines: 5-8 (240')  
 0.4 LTAR  
 24" Trench Bottom  
 Accepted Status System  
 Repair: Gravity to D-Box  
 Lines: 1-4 (200')  
 0.3 LTAR  
 15" Trench Bottom  
 T&J Panel - 50% Reduction

Avery Pond Drive

GRAPHIC SCALE  
 1" = 50'



Adams  
 Soil Consulting  
 919-414-6761  
 Job #708

**Avery Pond**  
**Lot #135**

3-Bedroom Home (360 gal./day)

<u>LINE #</u>	<u>COLOR</u>	<u>BS</u>	<u>HI</u>	<u>FS</u>	<u>ELEVATION</u>	<u>LINE LENGTH</u>	<u>Design Length</u>
TBM		2.0		100.0		<u>in field</u>	<u>installation</u>
INST. 1			102.0				
1	Orange			5.5	96.5	60	50
2	White			6	96	61	50
3	Pink			6.7	95.3	63	50
4	Yellow			7.2	94.8	64	50
5	Blue			7.8	94.2	65	60
6	Red			8.2	93.8	65	60
7	Orange			8.7	93.3	65	60
8	White			9.3	92.7	60	60
Total						503	440

	<u>System</u>	<u>Repair</u>
	Lines 5-8	Lines 1-4
<b>System Type</b>	Accepted Status System EZ-FLOW	50% Reduction System T&J Panel
Suggested Soil LTAR	0.40	0.30
<b>Total Line Length</b>	240	240
<b>Square Footage</b>	720	720
<b>Proposed Trench Bottom</b>	24"	15"
<b>Distribution Method</b>	Gravity to D-Box	Gravity to D-Box