



LEGEND
 AC=AIR CONDITIONING UNIT
 BOC=BACK OF CURB
 CATV=CABLE TV
 CB=CATCH BASIN
 DW=CONC DRIVEWAY
 EB=ELECTRIC BOX
 EM=ELECTRIC METER
 EOP=EDGE OF PAVEMENT
 EP=ELECTRIC PEDESTAL
 FH=FIRE HYDRANT
 LP=LIGHT POLE
 MTR=METER
 PCH=PORCH
 RCP=REINFORCED CONC PIPE
 R/W=RIGHT OF WAY
 SCO=CLEANOUT
 SW=SIDEWALK
 PP=POWER POLE
 TP=TELEPHONE PEDESTAL

○ EIP=EXISTING IRON PIPE
 ⊙ IRON PIPE SET
 ⊙ EIR=EXISTING IRON ROD
 TF=TRANSFORMER
 WM=WATER METER

N/F
 RONALD HALL
 DB 1164 PG 709

THIS SURVEY IS OF AN EXISTING PARCEL OR PARCELS OF LAND AND DOES NOT CREATE A NEW STREET OR CHANGE AN EXISTING STREET.

Shawn T. Rumberger 7-1-20
 SHAWN T. RUMBERGER, PLS L-4909 DATE

THIS MAP IS ONLY INTENDED FOR THE PARTIES AND PURPOSES SHOWN. THIS MAP IS NOT FOR RECORDATION. NO TITLE REPORT PROVIDED.

PLAT NORTH
 PB 2019, PGS 417-419



SETBACKS

FRONT	35'
SIDE	10'
REAR	20'
SIDE STREET	20'

VICINITY MAP (NTS)

S 10°51'16" W 80.50'

133

S 79°08'44" E 250.00'

134

20,125 S.F.
 0.462 AC.

N 79°08'44" W 250.00'

135

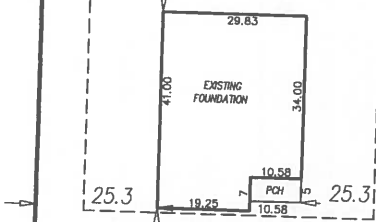

GENERAL NOTES:

1. ALL DISTANCES ARE HORIZONTAL GROUND DISTANCES IN U.S. SURVEY FEET UNLESS OTHERWISE NOTED.
2. AREAS SHOWN HEREON WERE COMPUTED USING THE COORDINATE METHOD.
3. LINES NOT SURVEYED ARE SHOWN AS DASHED LINES FROM INFORMATION REFERENCED ON THE FACE OF THIS SURVEY.
4. PROPERTY MAY BE SUBJECT TO ANY/ALL EASEMENTS AND RESTRICTIONS OF RECORD. THIS SURVEY IS A CORRECT REPRESENTATION OF THE LAND PLATTED AND OR DEEDED AND HAS BEEN PREPARED IN CONFORMITY WITH NORTH CAROLINA STANDARDS, G.S. 47-30, AND REQUIREMENTS OF LAW, BUT WITHOUT A FULL TITLE REPORT. A NORTH CAROLINA LICENSED ATTORNEY-AT-LAW SHOULD BE CONSULTED REGARDING CORRECT OWNERSHIP, WIDTH AND LOCATION OF EASEMENTS, AND OTHER TITLE QUESTIONS REVEALED BY TITLE EXAMINATION

GRAPHIC SCALE



1 inch = 40 ft.

N 10°51'16" E 80.50'

10' PUBLIC UTILITY EASEMENT

AVERY POND DRIVE
 50' PUBLIC R/W

FOUNDATION SURVEY

ECLS	PROJECT:	18-003 AVERY POND
	DRAWN BY:	AMW
	SCALE:	1"=40'
	DATE:	7-1-2020

FOR
 LGI HOMES
 837 AVERY POND DRIVE FUQUAY-VARINA, NC 27526
 LOT 134 AVERY POND SUBDIVISION; PHASE IIIA
 HECTOR'S CREEK TWP., HARNETT CO., NC
 P.B. 2019, PGS. 417-419



ECLS
 GLOBAL, INC.
 U.S. VETERAN-OWNED
 19 N MCKINLEY ST
 COATS, NC 27521
 910.897.3257 ECLSGLOBALINC.COM
 910.897.2329 (FAX) CO#C-4175