

# Avery Pond 3-Bedroom Septic Proposal Lot #133

133

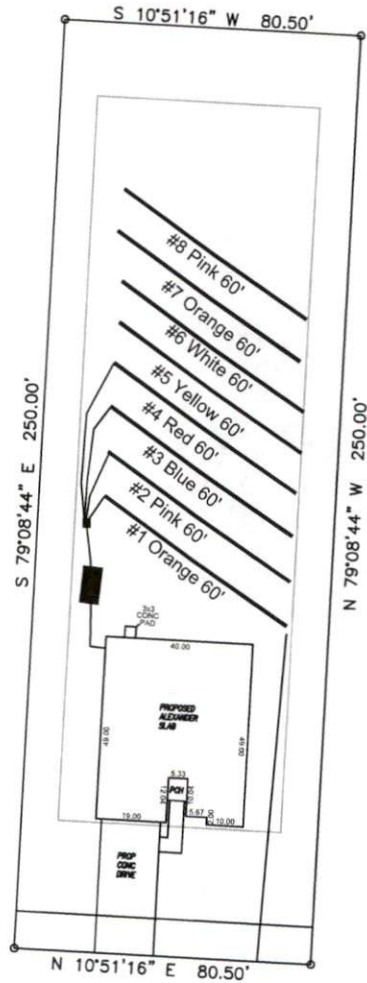

System: Gravity D-Box  
 Lines: 1-4 (240')  
 0.4 LTAR  
 24" Trench Bottom  
 Accepted Status System  
 Repair: Gravity to D-Box  
 Lines: 5-8 (240')  
 0.4 LTAR  
 24" Trench Bottom  
 Accepted Status System

Avery Pond Drive

GRAPHIC SCALE  
 1" = 50'



Adams  
 Soil Consulting  
 919-414-6761  
 Job #708

**Avery Pond**  
**Lot #133**

3-Bedroom Home (360 gal./day)

<u>LINE #</u>	<u>COLOR</u>	<u>BS</u>	<u>HI</u>	<u>FS</u>	<u>ELEVATION</u>	<u>LINE LENGTH</u>	<u>Design Length</u>
TBM		2.0		100.0		<u>in field</u>	<u>installation</u>
INST. 1			102.0				
1	Orange			4.6	97.4	70	60
2	Pink			5	97	70	60
3	Blue			5.4	96.6	65	60
4	Red			5.8	96.2	65	60
5	Yellow			6.3	95.7	65	60
6	White			6.6	95.4	65	60
7	Orange			7	95	60	60
8	Pink			8	94	60	60
Total						400	360

	<u>System</u>	<u>Repair</u>
	Lines 1-4	Lines 4-8
<b>System Type</b>	Accepted Status System EZ-FLOW	Accepted Status System EZ-FLOW
<b>Suggested Soil LTAR</b>	0.40	0.40
<b>Total Line Length</b>	240	240
<b>Square Footage</b>	720	720
<b>Proposed Trench Bottom</b>	24"	24"
<b>Distribution Method</b>	Gravity to D-Box	Gravity to D-Box