

PERMIT # NA

Operation Permit

New Installation  Septic Tank  Nitrification Line  Repair  Expansion 521429

PROPERTY LOCATION: 809 AVERY POND DR (CHILBERTLAND)

Name: (owner) LGI HOMES NC LLC SUBDIVISION AVERY POND LOT # 132

System Installer: THORNTON'S PLUMBING Registration # \_\_\_\_\_

Basement with plumbing:  Garage  Number of Bedrooms 3

Type of Water Supply:  Community  Public  Well Distance from well NA feet

System Type: 25% REDUCTION SIS. III G Types V and VI Systems expire in 5 years.

(In accordance with Table V a)

Owner must contact Health Department 6 months prior to expiration for permit renewal.

This system has been installed in compliance with applicable North Carolina General Statutes, Rules for Sewage Treatment and Disposal, and all conditions of the Improvement Permit and Construction Authorization.

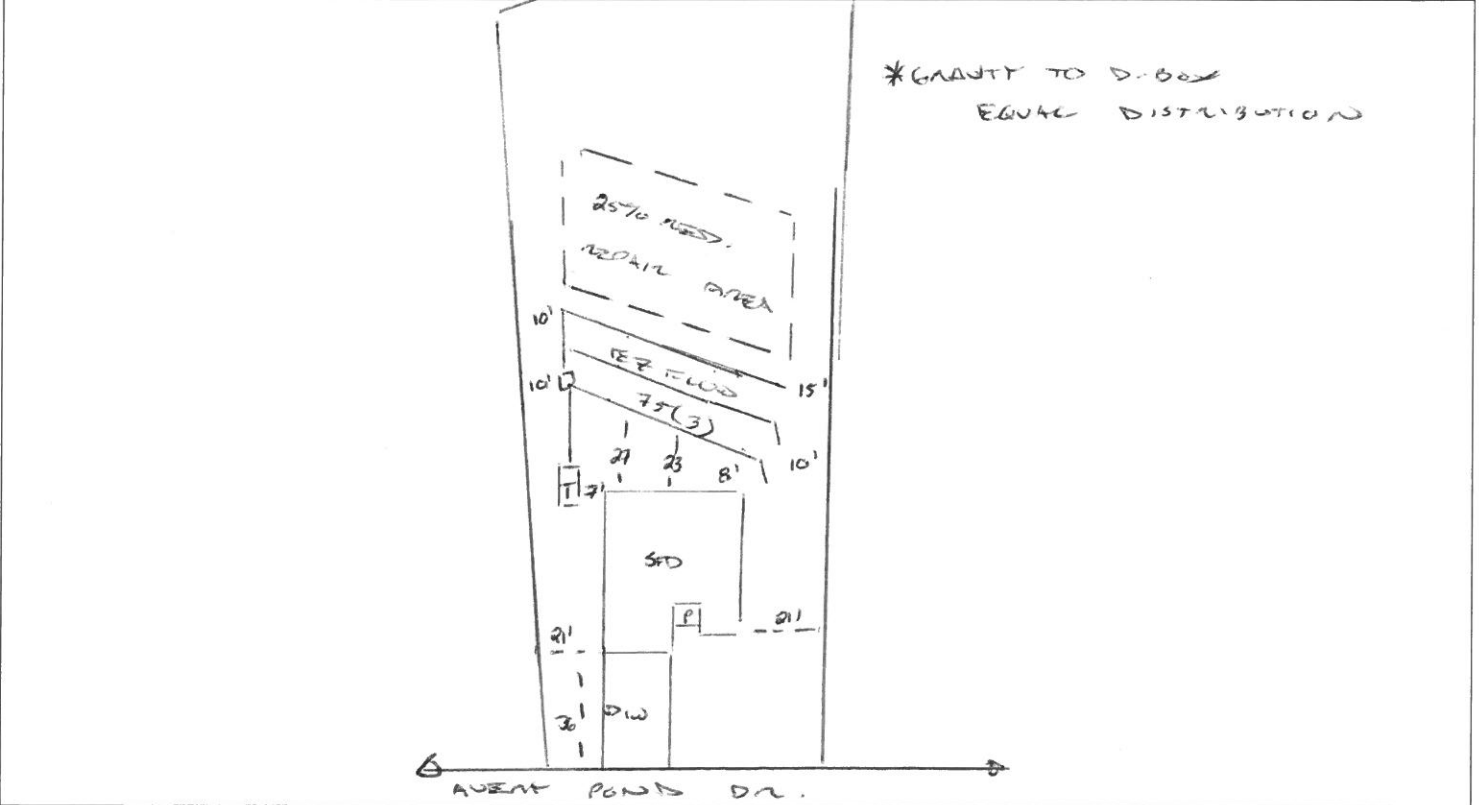

\*GRABBY TO D-BOX  
EQUAL DISTRIBUTION

PERMIT CONDITIONS:

- I. Performance: System shall perform in accordance with Rule .1961.
- II. Monitoring: As required by Rule .1961.
- III. Maintenance: As required by Rule .1961. Other: \_\_\_\_\_

Subsurface system operator required? Yes  No   
If yes, see attached sheet for additional operation conditions, maintenance and reporting.

IV. Operation: \_\_\_\_\_

V. Other: \_\_\_\_\_

D-Box  Pump  Alarm  H2O Line  PWR Line

Following are the specifications for the sewage disposal system on the above captioned property.

Type of system:  Conventional  Other PER FLOW III G Septic Tank: 1000 gallons Pump Tank: \_\_\_\_\_ gallons

Subsurface Drainage Field No. of ditches 3 exact length of each ditch 75 feet width of ditches 3 feet depth of ditches 24 inches

French Drain Required: \_\_\_\_\_ Linear feet

Authorized State Agent [Signature] Date 08/07/2020