

# Avery Pond 3-Bedroom Septic Proposal Lot #132

132

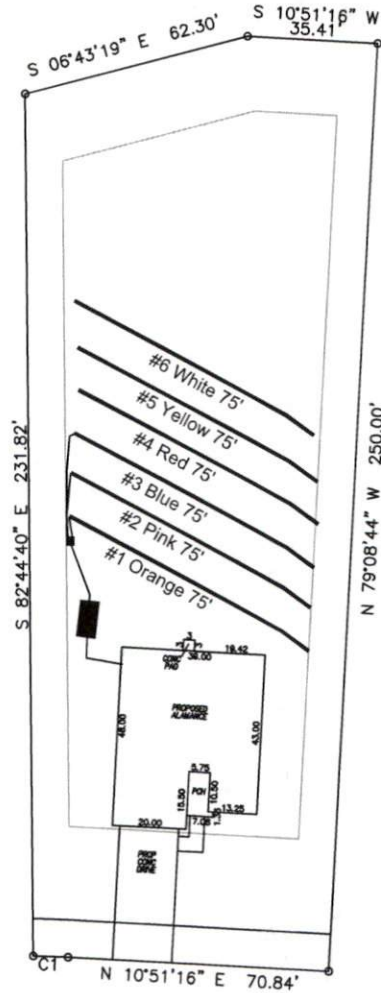

Avery Pond Drive

System: Gravity D-Box  
 Lines: 1-3 (225')  
 0.4 LTAR  
 24" Trench Bottom  
 Accepted Status System  
 Repair: Gravity to D-Box  
 Lines: 4-6 (225')  
 0.4 LTAR  
 24" Trench Bottom  
 Accepted Status System

GRAPHIC SCALE  
 1" = 50'



Adams  
 Soil Consulting  
 919-414-6761  
 Job #708

**Avery Pond**  
**Lot #132**

3-Bedroom Home (360 gal./day)

<u>LINE #</u>	<u>COLOR</u>	<u>BS</u>	<u>HI</u>	<u>FS</u>	<u>ELEVATION</u>	<u>LINE LENGTH</u>	<u>Design Length</u>
TBM		2.0		100.0		<u>in field</u>	<u>installation</u>
INST. 1			102.0				
1	Orange			2.6	99.4	75	75
2	Pink			2.9	99.1	75	75
3	Blue			3.2	98.8	75	75
4	Red			3.6	98.4	75	75
5	Yellow			4	98	75	75
6	White			4.3	97.7	75	75
7	Orange			4.8	97.2	75	not used
8	Pink			5.5	96.5	75	not used
Total						450	450

	<u>System</u>	<u>Repair</u>
	Lines 1-3	Lines 4-6
<b>System Type</b>	Accepted Status System EZ-FLOW	Accepted Status System EZ-FLOW
<b>Suggested Soil LTAR</b>	0.40	0.40
<b>Total Line Length</b>	225	225
<b>Square Footage</b>	675	675
<b>Proposed Trench Bottom</b>	24"	24"
<b>Distribution Method</b>	Gravity to D-Box	Gravity to D-Box