

JEANNIE P. STANCIL
DB:2519, PG:618
MAP PC E.SL:106A

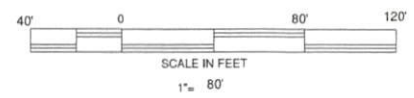

DEED REFERENCE: DEED BOOK 3783, PAGES 211-214
MAP REFERENCE: PLAT BOOK 2020, PAGE 68

BETH FLANAGAN
RAY OQUINN
DB:894, PG:124
MAP PC D, SL 163-C
3-B

MINIMUM BUILDING SETBACKS
FRONT YARD — 35'
REAR YARD — 25'
SIDE YARD — 10'
CORNER LOT SIDE YARD — 20'
MAXIMUM HEIGHT — 35'

THIS PROPERTY DOES NOT LIE IN A FLOOD HAZARD AREA (ZONE X)
AS SHOWN ON FEMA MAP NO. 372006200J EFFECTIVE DATE 10/3/2006

SITE PLAN APPROVAL
DISTRICT RA-30 **USE** SFD
#BEDROOMS 3
3.5-20 K.A.G.
ZONING ADMINISTRATOR

OWNER:
2020 HOLDING, LLC
350 WAGONER DR.
FAYETTEVILLE, NC 28303
910 893-5252

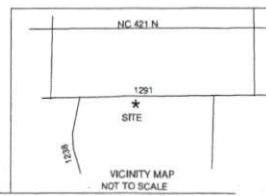

| | | | | |
|--|----------------------------------|---|------------------------|------------------------|
| SURVEY FOR MURRAY FARM LOT 1-E | | BENNETT SURVEYS 1662 CLARK RD., LILLINGTON, N.C. 27546 (910) 893-5252 | | F-1304 |
| 2020 HOLDING, LLC 350 WAGONER DR. FAYETTEVILLE, NC 28303 | | TOWNSHIP UPPER LITTLE RIVER COUNTY HARNETT | | 40' 0 80' |
| STATE: NORTH CAROLINA | | DATE: MARCH 4, 2020 | | SCALE: 1" = 80' |
| ZONED RA-30 | WATERSHED DISTRICT WS-IV-P & N/A | PID # 130610 0359 02 | PPN # 0620-05-9794.000 | SURVEYED BY: RVB |
| | | CHECKED & CLOSURE BY: MRB | | FIELD BOOK FOCUS 30/35 |
| | | | | DRAWING NO. 20157 |