

Application # SFD2002-0022

Harnett County Department of Public Health Site Sketch

Property Location: 118 Village Bend Dr. (Christina Light Rd. - 311412)
Issued To: Don Lynn Bids Subdivision Old Mill Village Lot # 1

Authorized State Agent: *[Signature]* Date: 02/27/2020
ANDREW CURRAN

- * GRAVITY TO D-BOX EQUAL DISTRIBUTION REQUIRED
- * PROPOSAL BY ADAMS SOIL CONSULTING

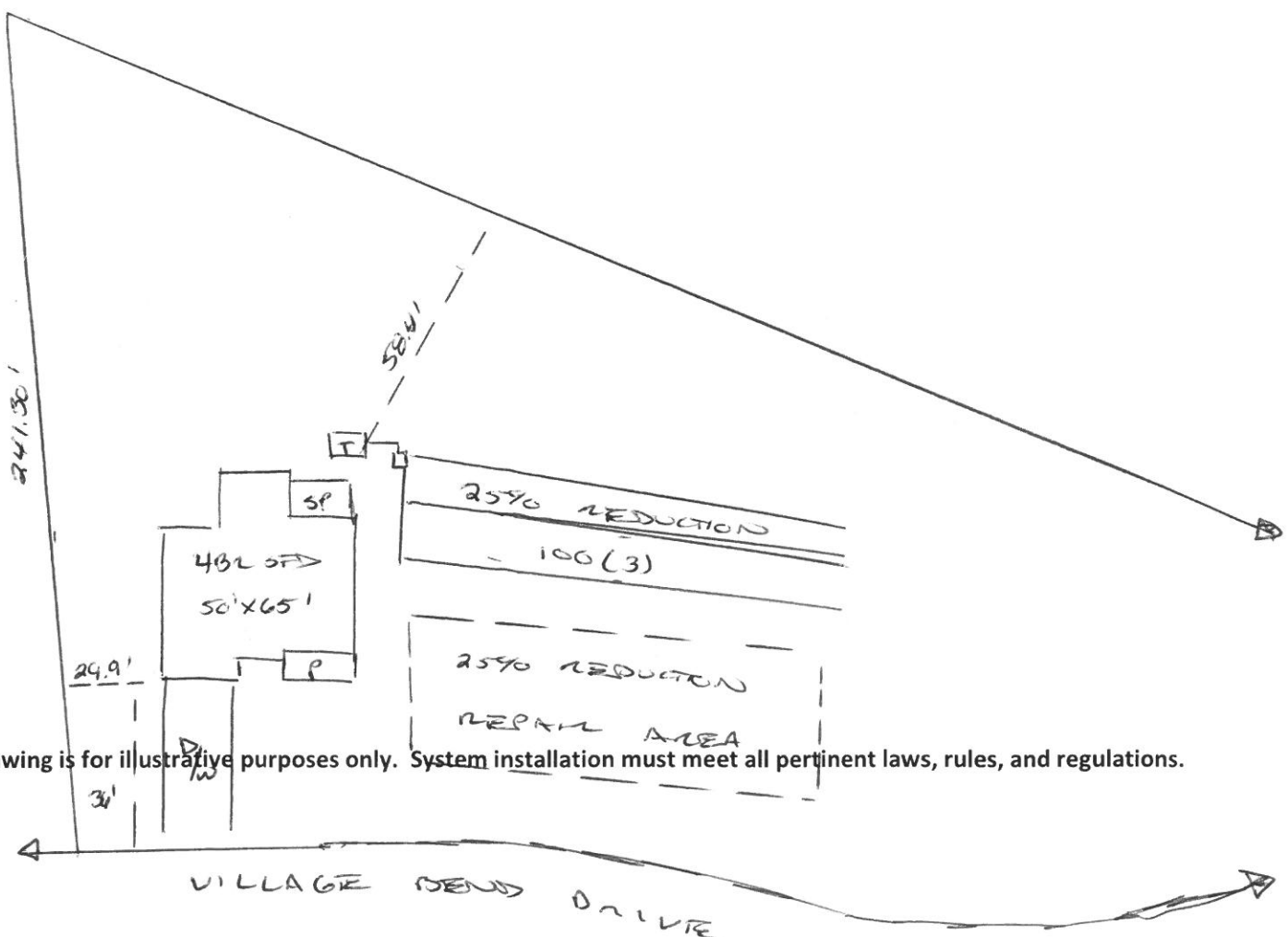

This drawing is for illustrative purposes only. System installation must meet all pertinent laws, rules, and regulations.

Olde Mill Village 4-Bedroom Septic Proposal Lot #1

499.89'
15' LANDSCAPE EASEMENT

System: Gravity to D-Box
 Lines: 2-4 (300')
 0.4 LTAR
 24" Trench Bottom
 Accepted Status System
 Repair: Pressure Manifold
 Lines: 5-7 (300')
 0.4 LTAR
 24" Trench Bottom
 Accepted Status System

If plumbing is not sufficient
 a pump and tank may be
 required to septic drain field.

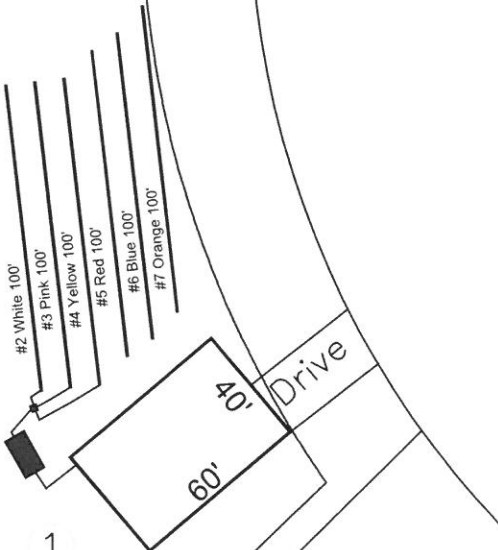

1
 52,654 SF
 1.209 AC

241.30'

*Preliminary Design
 Not a Permit

Adams
 Soil Consulting
 919-414-6761
 Job #699

GRAPHIC SCALE
 1" = 60'

