

HTE# SFD2002-0011

Harnett County Department of Public Health

No. 26565

PERMIT # NA

Operation Permit

New Installation Septic Tank Nitrification Line Repair Expansion

521429

PROPERTY LOCATION: 86 WATERVILLE WAY (CHALBEATE ROAD)

Name: (owner) LGS HOMES NC LLC SUBDIVISION AVERY POND LOT # 146

System Installer: THORNTONS PLUMBING Registration # _____

Basement with plumbing: Garage Number of Bedrooms 3

Type of Water Supply: Community Public Well Distance from well NA feet

System Type: 25% REDUCTION SIS. IIIg Types V and VI Systems expire in 5 years.

(In accordance with Table V a) Owner must contact Health Department 6 months prior to expiration for permit renewal.

This system has been installed in compliance with applicable North Carolina General Statutes, Rules for Sewage Treatment and Disposal, and all conditions of the Improvement Permit and Construction Authorization.

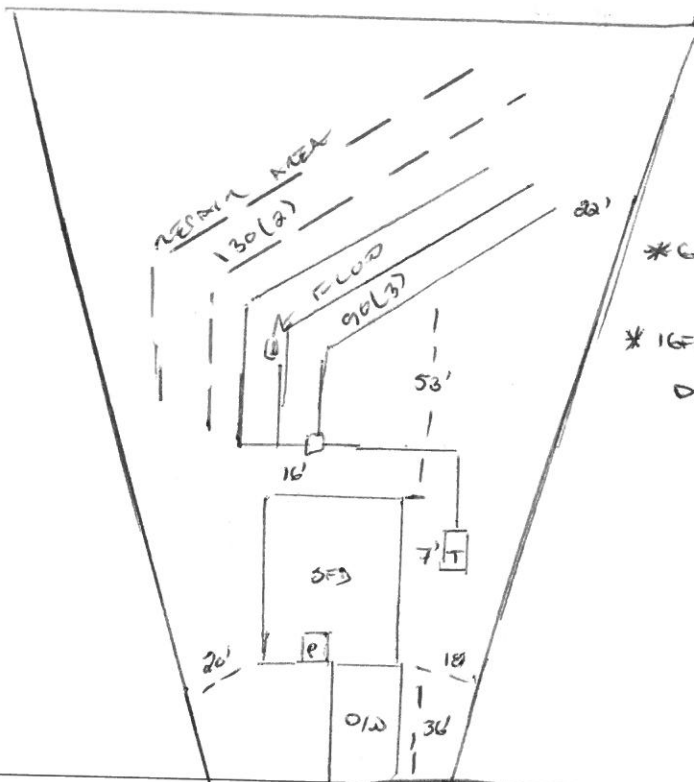

*GRAVITY TO D-BOX
 EQUAL DISTRIBUTION
 * 16FT OFF SPD NOT
 DECK/STEPS

PERMIT CONDITIONS:

- I. Performance: System shall perform in accordance with Rule .1961.
- II. Monitoring: As required by Rule .1961.
- III. Maintenance: As required by Rule .1961. Other: _____
 Subsurface system operator required? Yes No
 If yes, see attached sheet for additional operation conditions, maintenance and reporting.
- IV. Operation: _____
- V. Other: _____

D-Box Pump Alarm H2O Line PWR Line

Following are the specifications for the sewage disposal system on the above captioned property.

Type of system: Conventional Other IEE FLOW IIIg Septic Tank: 1000 gallons Pump Tank: _____ gallons
 Subsurface No. of _____ exact length _____ width of _____ depth of _____
 Drainage Field ditches 3 of each ditch 90 feet ditches 3 feet ditches 18 inches
 French Drain Required: _____ Linear feet

Authorized State Agent [Signature] Date 08/31/2020