

Adams Soil Consulting
1676 Mitchell Road
Angier, NC 27501
919-414-6761

June 10, 2019
Project #803

Tommy Talton
432 Kipling Road
Fuquay-Varina, NC 27526

RE: Preliminary soil/site evaluation for 470 Kipling Road n Harnett County, NC

Mr. Talton,

Adams Soil Consulting completed a soils evaluation per your request for the above referenced parcel for an individual parcel approximately 4.8 acres in area adjacent to NC 210 in Harnett County. The soil/site evaluation was performed using hand auger borings, under moist soil conditions, based on the criteria found in the State Subsurface Rules, 15ANCAC 18A .1900 "Laws and Rules for Sewage Treatment and Disposal Systems". The purpose of the evaluation was to identify areas suitable for a septic system that could potentially support a single-family dwelling on each lot. Only a portion of the property was evaluated.

The suitable soils shown on the accompanying soil map have potential for a conventional type initial and repair area for potentially one 4-bedrooms home on each parcel. Each lot contains greater than 30,000 ft² of suitable soils that consist of sandy clay loam subsoil that can support a daily loading rate of 0.3 - 0.4 gallons/day/ft². The specific septic system and loading rates for each lot will be permitted by the Harnett County Health Department. The areas for the proposed septic fields shall not be impacted by home sites, pools, garages and shall not be mechanically altered from the natural lay of the land.

The lots may require septic systems utilizing pumps, shallow or ultra-shallow conventional trench placement, low pressure pipe systems, and/or reductions systems for final approval. The lots may require a site plan or design to be developed before a final improvement permit is issued by Harnett County. Depending on the location and size of the proposed home, garage, pool area etc. a septic system layout/design may be required before a permit can be issued on the above referenced lots demonstrating available space for a repair area. Due to the subjective nature of the permitting process and the variability of naturally occurring soils, ASC cannot guarantee that areas delineated as suitable for on-site wastewater disposal systems will be permitted by the governing agency. It should be noted that a more detailed soils evaluation may be needed to access the potential soil constraints that may limit future land subdivision.

Please give me a call if you have any questions.

Sincerely,



Alex Adams
NC Licensed Soil Scientist #1247



Preliminary Soils Evaluation

Tommy Talton

470 Kipling Road, Harnett County NC

*Not a Survey
(sketched from public records)

Legend

Areas contain soils with 30 inches or more of useable material and have potential for conventional, modified conventional, LPP or ultra-shallow conventional septic systems. There may be inclusion of soils 24-29 inches to a restrictive horizon that will have potential for LPP septic systems.

US Unsuitable Areas or Area Not Evaluated

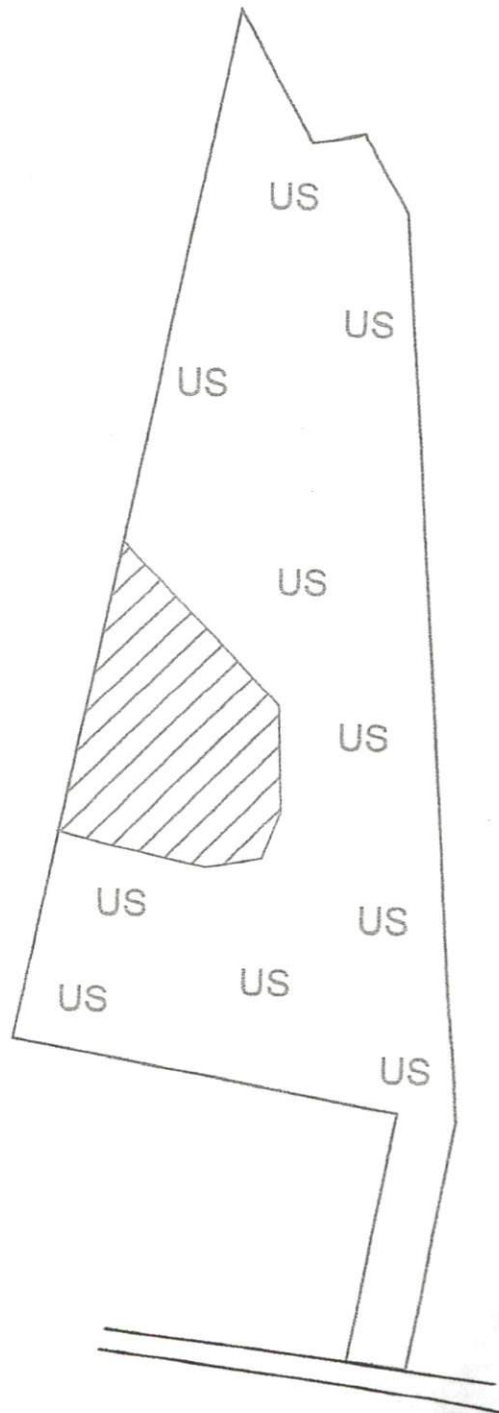

- *Preliminary Soils Evaluation
- *Soil boundary was sketched onto a preliminary map of the property taken from public records.
- *Not a Survey.
- *Septic system setbacks listed below for new lots.
 - 1) 10' from property lines.
 - 2) 100' from wells for primary systems.
 - 3) 50' from surface waters (streams, ponds, lakes).
- *Any mechanical disturbances such as grading, cutting and filling of the suitable soil areas can render areas unsuitable for future septic systems.
- *See accompanying report for additional information.
- *Due to Soil Variability, Adams soil consulting cannot guarantee that the areas shown as suitable will be permitted by the local Health Department.

GRAPHIC SCALE
1" = 150'



Adams
Soil Consulting
919-414-6761
Project #803