

PERMIT # NA

Operation Permit

New Installation  Septic Tank  Nitrification Line  Repair  Expansion

SN 1423

PROPERTY LOCATION: 41 BENTON FARM WAY (TYPED DEWAL WS)

Name: (owner) CHARLES PERRY SUBDIVISION JOANISE ELIZABETH HOWE LOT # 106

System Installer: JASON MATTHEWS Registration # \_\_\_\_\_

Basement with plumbing:  Garage  Number of Bedrooms 3

Type of Water Supply:  Community  Public  Well Distance from well NA feet

System Type: 25% REDUCTION SYS. TITG Types V and VI Systems expire in 5 years.

(In accordance with Table V a)

Owner must contact Health Department 6 months prior to expiration for permit renewal.

This system has been installed in compliance with applicable North Carolina General Statutes, Rules for Sewage Treatment and Disposal, and all conditions of the Improvement Permit and Construction Authorization.

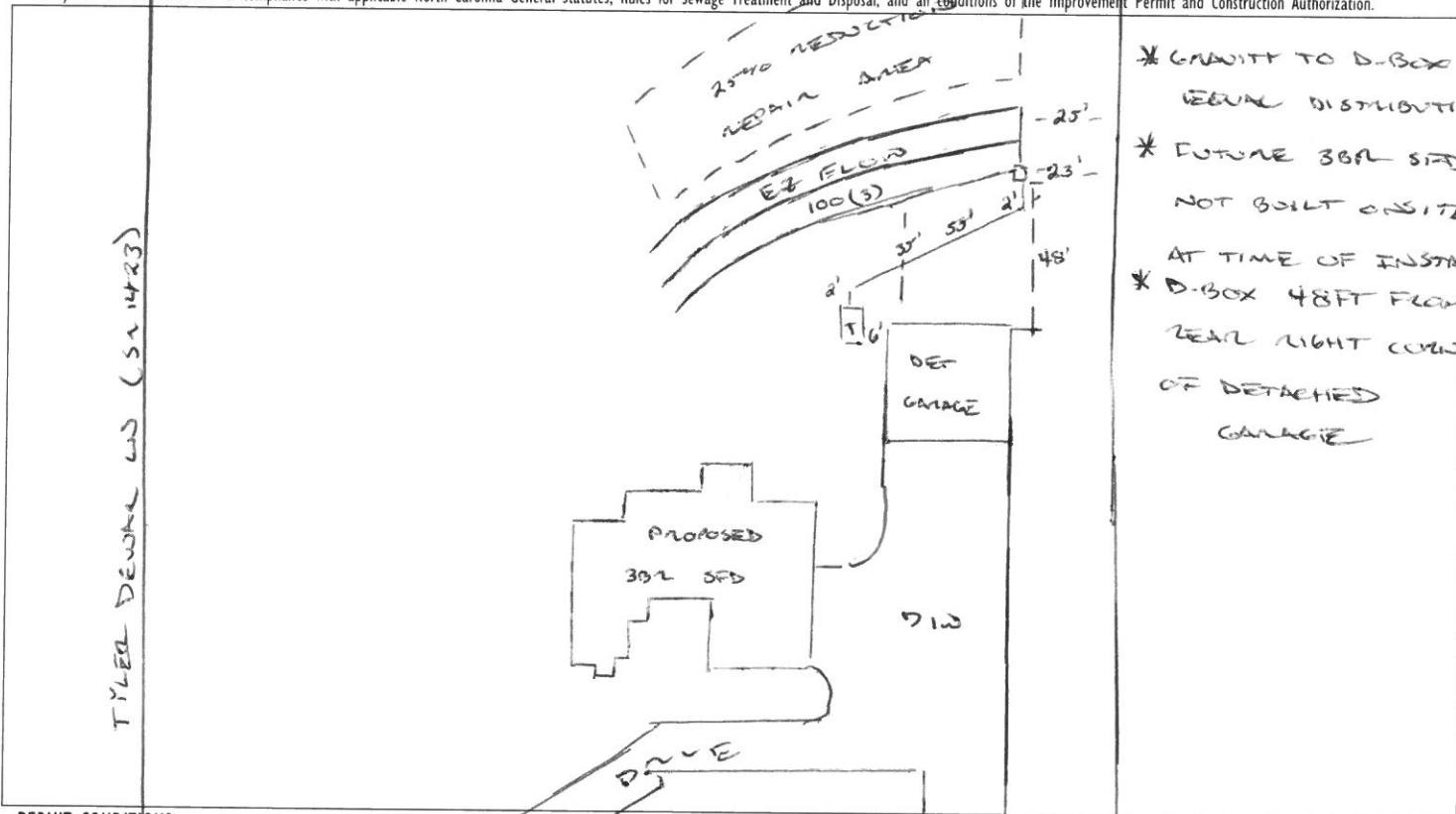

PERMIT CONDITIONS:

- I. Performance: System shall perform in accordance with Rule .1961.
- II. Monitoring: As required by Rule .1961.
- III. Maintenance: As required by Rule .1961. Other: BENTON FARM WAY  
Subsurface system operator required? Yes  No   
If yes, see attached sheet for additional operation conditions, maintenance and reporting.
- IV. Operation: \_\_\_\_\_
- V. Other: \_\_\_\_\_

D-Box  Pump  Alarm  H2O Line  PWR Line

Following are the specifications for the sewage disposal system on the above captioned property.

Type of system:  Conventional  Other E2 FLOW TITG Septic Tank: 1250 gallons Pump Tank: \_\_\_\_\_ gallons

Subsurface No. of exact length width of depth of  
Drainage Field ditches 3 of each ditch 100 feet ditches 3 feet ditches 18 inches

French Drain Required: \_\_\_\_\_ Linear feet

Authorized State Agent [Signature] Date 05/13/2020