

**SOIL/SITE EVALUATION  
 for ON-SITE WASTEWATER SYSTEM**

Cumin Plantation

Owner: Applicant: **Lamco Custom Builders**  
 Address: Date Evaluated: **1/13/2020**  
 Proposed Facility: **SFD** Design Flow (.1949): **360 GPD** Property Size:  
 Location of Site: **206 Southen PI** Property Recorded:  
 Water Supply:  Public  Individual  Well  Spring  Other  
 Evaluation Method:  Auger Boring  Pit  Cut  
 Type of Wastewater:  Sewage  Industrial Process  Mixed

P R O F I L E #	.1940 Landscape Position/ Slope %	Horizon Depth (In.)	SOIL MORPHOLOGY .1941		OTHER PROFILE FACTORS				Profile Class & LTAR	
			.1941 Structure/ Texture	.1941 Consistence Mineralogy	.1942 Soil Wetness/ Color	.1943 Soil Depth (IN.)	.1956 Sapro Class	.1944 Restr Horiz		
1	L 25%	0-24"	GR SL	VFR	SXP	NSNP				
		24-48"	BK SCL	Fi	SXP	SSSP	48"			PS 0.45
2	L 25%	0-24"	GR SL	VFR	SXP	NSNP				
		24+	BK SCL	Fi	SXP	SSSP	24"			UN
3,4	L 25%	0-24"	GR SL	VFR	SXP	NSNP				
		24-40"	BK SCL	Fi	SXP	SSSP	40"			PS 0.45

Description	Initial System	Repair System	Other Factors (.1946): Site Classification (.1948):
Available Space (.1945)	25% Red	Pump to 25% Red	Provisionally suitable
System Type(s)	25% Red	Pump to 25% Red	Evaluated By: Brittany Adams
Site LTAR	0.45	0.45	Others Present:

COMMENTS: \_\_\_\_\_

LANDSCAPE POSITIONS	GROUP	TEXTURES	.1955 LTAR	CONSISTENCE MOIST	WET
R-RIDGE	I	S-SAND	1.2 - 0.8	VFR-VERY FRIABLE FR-FRIABLE	NS-NON-STICKY SS-SLIGHTLY STICKY
S-SHOULDER SLOPE		LS-LOAMY SAND			
L-LINEAR SLOPE					
FS-FOOT SLOPE	II	SL-SANDY LOAM	0.8 - 0.6	FI-FIRM VFI-VERY FIRM	S-STICKY VS-VERY STICKY
N-NOSE SLOPE		L-LOAM			
H-HEAD SLOPE	III	SI-SILT	0.6 - 0.3	EFI-EXTREMELY FIRM	NP-NON-PLASTIC SP-SLIGHTLY STICKY P-PLASTIC VP-VERY PLASTIC
CC-CONCLAVE SLOPE		SIL-SILT LOAM			
CV-CONVEX SLOPE		CL-CLAY LOAM			
T-TERRACE		SCL-SANDY CLAY LOAM			
FP-FLOOD PLAN	IV	SIC-SILTY CLAY C-CLAY SC-SANDY CLAY	0.4 - 0.1		

STRUCTURE  
 SG-SINGLE GRAIN  
 M- MASSIVE  
 CR-CRUMB  
 GR-GRANULAR  
 SBK-SUBANGULAR BLOCKY  
 ABK-ANGULAR BLOCKY  
 PL-PLATY  
 PR-PRISMATIC

MINERALOGY  
 SLIGHTLY EXPANSIVE  
 EXPANSIVE

Show profile locations and other site features (dimensions, references or benchmark, and North)

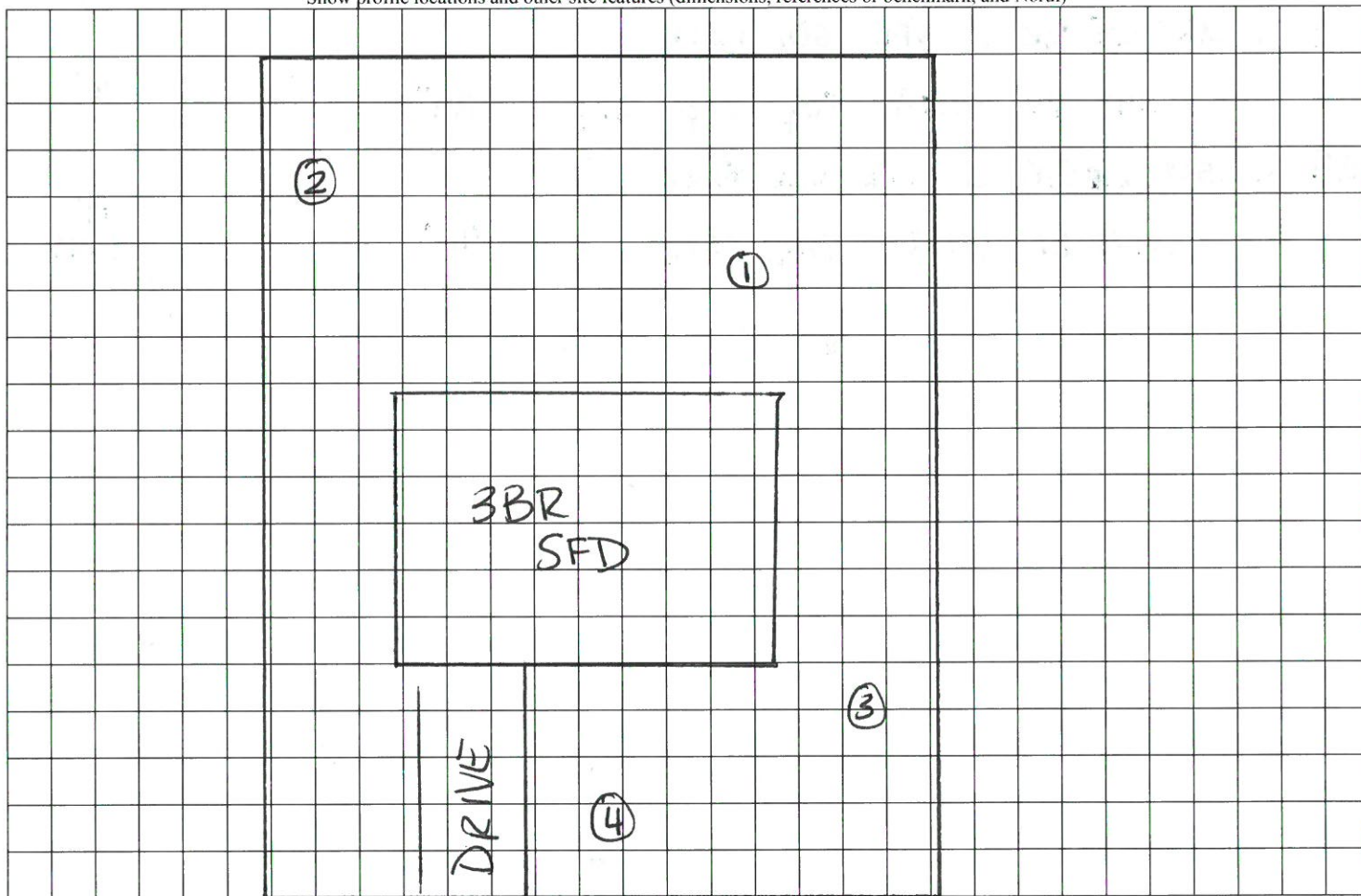

Southern PI