

Harnett County Department of Public Health Improvement Permit

A building permit cannot be issued with only an Improvement Permit

SL 1440

ISSUED TO: True Homes LLC PROPERTY LOCATION: 53 Norris Farm Dr. (Jones Norris Rd)
 SUBDIVISION: Norris Farms LOT # 2

NEW REPAIR EXPANSION Site Improvements required prior to Construction Authorization Issuance: _____

Type of Structure: 3-Bedroom 40'x46' SFD

Proposed Wastewater System Type: 25% reduction SS.

Projected Daily Flow: 360 GPD

Number of bedrooms: 3 Number of Occupants: 6 max

Basement Yes No

Pump Required: Yes No May be required based on final location and elevations of facilities

Type of Water Supply: Community Public Well Distance from well NA feet

Permit valid for: Five years No expiration

Permit conditions: _____

Authorized State Agent: [Signature] Date: 12/20/2019 SEE ATTACHED SITE SKETCH

The issuance of this permit by the Health Department in no way guarantees the issuance of other permits. The permit holder is responsible for checking with appropriate governing bodies in meeting their requirements. This site is subject to revocation if the site plan, plat, or the intended use changes. The Improvement Permit shall not be affected by a change in ownership of the site. This permit is subject to compliance with the provisions of the Laws and Rules for Sewage Treatment and Disposal and to conditions of this permit.

Construction Authorization

(Required for Building Permit)

The construction and installation requirements of Rules .1950, .1952, .1954, .1955, .1956, .1957, .1958, and .1959 are incorporated by references into this permit and shall be met. Systems shall be installed in accordance with the attached system layout.

ISSUED TO: True Homes LLC PROPERTY LOCATION: 53 Norris Farm Dr. (Jones Norris Rd)
 SUBDIVISION: Norris Farms LOT # 2

Facility Type: 3B2 40'x46' SFD New Expansion Repair

Basement? Yes No Basement Fixtures? Yes No

Type of Wastewater System** Pump to 25% reduction (Initial) Wastewater Flow: 360 GPD
 (See note below, if applicable)

Pump to 25% red. SS. (Repair)

Installation Requirements/Conditions

Septic Tank Size <u>1000</u> gallons	Number of trenches <u>2</u>	Exact length of each trench <u>115</u> feet	Trench Spacing: <u>9</u> Feet on Center
Pump Tank Size <u>1000</u> gallons	Trenches shall be installed on contour at a Maximum Trench Depth of: <u>18-24</u> inches (Trench bottoms shall be level to +/-1/4" in all directions)	Soil Cover: <u>6-13</u> inches (Maximum soil cover shall not exceed 36" above the trench bottom)	

Pump Requirements: _____ ft. TDH vs. _____ GPM Aggregate Depth: NA inches below pipe NA inches above pipe NA inches total

Conditions: Pump to D-Box Distribution Required

**WATER LINES (INCLUDING IRRIGATION) MUST BE 10FT. FROM ANY PART OF SEPTIC SYSTEM OR REPAIR AREA.
NO UTILITIES ALLOWED IN INITIAL OR REPAIR DRAIN FIELD AREA.**

**If applicable: I understand the system type specified is different from the type specified on the application. I accept the specifications of this permit.

Owner/Legal Representative Signature: _____ Date: _____

This Construction Authorization is subject to revocation if the site plan, plat, or the intended use changes. The Construction Authorization shall not be transferred when there is a change in ownership of the site. This Construction Authorization is subject to compliance with the provisions of the Laws and Rules for Sewage Treatment and Disposal and to the conditions of this permit. SEE ATTACHED SITE SKETCH

Authorized State Agent: [Signature] Date: 12/20/2019
 Construction Authorization Expiration Date: 12/20/2024

Application # 51B1912-0026

Harnett County Department of Public Health Site Sketch

Property Location: 53 Norris Farm Dr. (James Norris Ct. 51144G)

Issued To: True Homes LLC Subdivision Norris Farms Lot # 2

Authorized State Agent: *Andrew Gunn* Date: 12/26/2015

ANDREW GUNN

* PUMP TO D-BOX EQUAL DISTRIBUTION

* 18IN-24IN TRENCH

- CONTOUR MAY VARY MAY REQUIRE
DEEP TO SHALLOW OR SHALLOW
TO DEEP INSTALL

* PROPOSAL BY ADAMS
SOIL CONSULTING

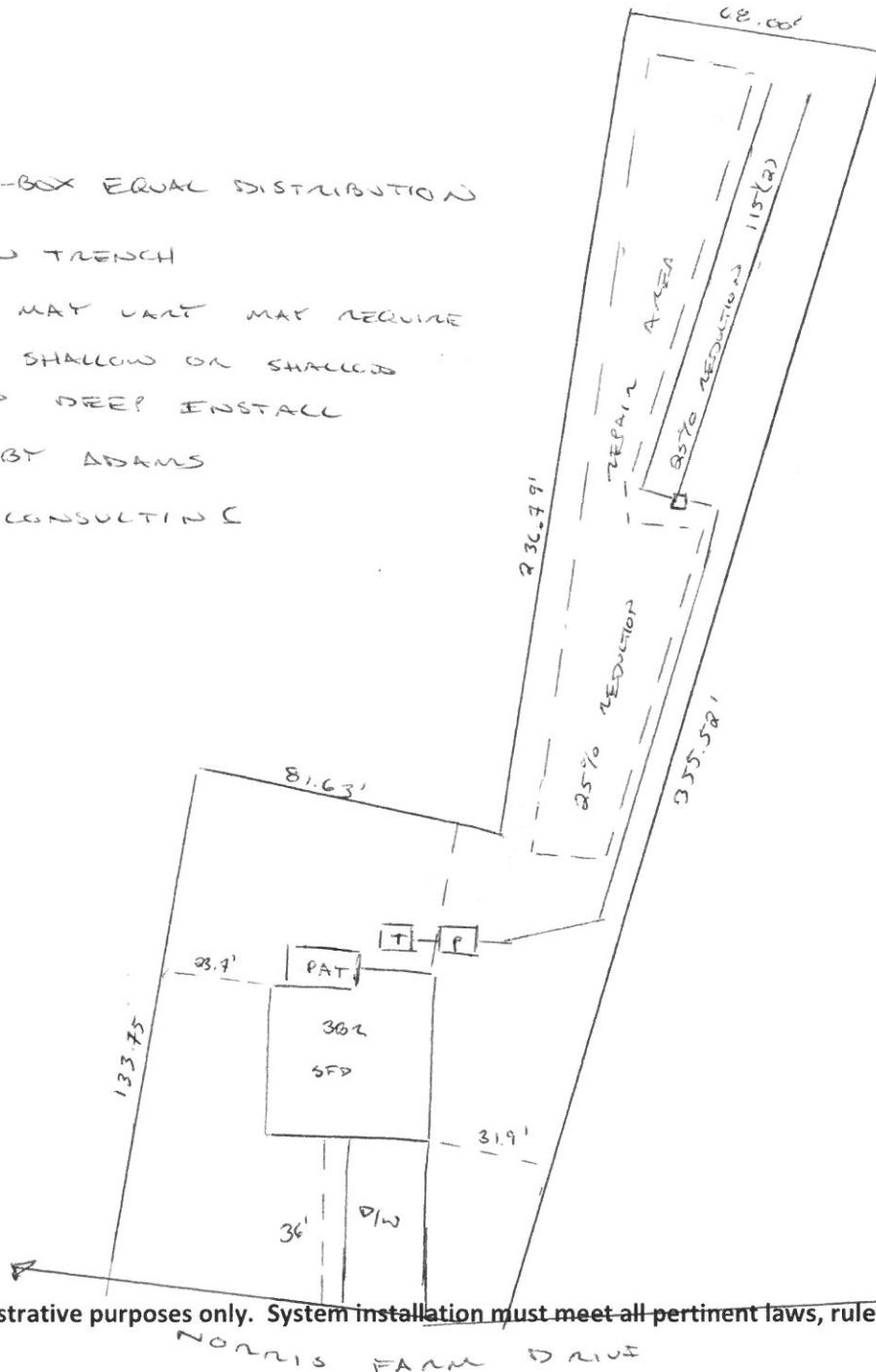

This drawing is for illustrative purposes only. System installation must meet all pertinent laws, rules, and regulations.

NORRIS FARM DRIVE