

I, MICHAEL P. GRIFFIN, certify that under my direction and supervision this map was drawn from an actual field survey; that the error of closure of the survey as calculated by coordinates is 1: 10,000+; that the area shown hereon was calculated by coordinates.

Witness my hand and seal this 7TH day of FEBRUARY 2020.

EASEMENTS ARE HEREBY RESERVED BY THE DEVELOPER ON, OVER, UNDER, ABOVE AND THROUGH A STRIP OF LAND TEN FEET IN WIDTH ALONG EACH SIDE LOT LINE AND FIFTEEN FEET IN WIDTH ALONG EACH REAR LOT LINE AND FRONT LOT LINE FOR DRAINAGE, WATER AND SEWAGE INSTALLATION AND MAINTENANCE AND FOR OTHER UTILITY PURPOSES.



W.S. WELLONS CORP.

S 25°24'44" E 119.42'

DRAINAGE & UTILITY EASEMENT
LOW/SWAMPY AREA



0.43 AC.



N 79°16'40" E 176.82'

132.4'

S 88°48'27" W 216.74'

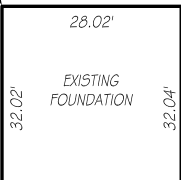

37.6' 10.90' 11.0' 17.7'

CI

OLD SALEM DRIVE

50' PUBLIC RW

PER COVENANTS
SETBACKS

FRONT	15'
REAR	15'
SIDE	8'

CI R=480.98' L=80.00' N05°57'27"W 79.91'

THIS PROPERTY IS NOT LOCATED
IN THE 100 YEAR FLOOD ZONE.

LEGEND

- | | | | |
|-----|---------------------|-----|--------------------|
| EIP | EXISTING IRON PIPE | FES | FLARED END SECTION |
| IPS | IRON PIPE SET | WM | WATER METER |
| R/W | RIGHT OF WAY | CO | CLEAN OUT |
| N/F | NOW OR FORMERLY | FH | FIRE HYDRANT |
| EIS | EXISTING IRON STAKE | CB | CATCH BASIN |

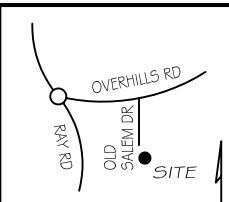

GRIFFIN LAND SURVEYING, INC.

P. O. BOX 148
FUQUAY-VARINA, NC 27526
(919) - 567 - 1963

FOUNDATION SURVEY
FOR

H & H HOMES

COUNTRY SQUIRE ESTATES
LOT 83

OLD SALEM DRIVE
NORTH CAROLINA

HARNETT CO. ANDERSON CREEK TWSP

DRAWN BY KDF

DATE 2/7/20

CHECKED BY MPG

SCALE 1" = 30'