

Harnett County Department of Public Health Improvement Permit

A building permit cannot be issued with only an Improvement Permit

321401

ISSUED TO: Stephenson Bldg Inc.
NEW REPAIR EXPANSION
Type of Structure: 4-bedroom 66'x60' STD
Proposed Wastewater System Type: 25% reduction
Projected Daily Flow: 480 GPD
Number of bedrooms: 4 Number of Occupants: 8 max
Basement Yes No
Pump Required: Yes No May be required based on final location and elevations of facilities
Type of Water Supply: Community Public Well Distance from well NA feet
Permit conditions: _____

PROPERTY LOCATION: 218 Hobby Rd. (Rollins Mill Road)
SUBDIVISION Paula E. Stephenson LOT # 32
Site Improvements required prior to Construction Authorization Issuance: _____

Authorized State Agent: [Signature] Date: 11/15/2019 SEE ATTACHED SITE SKETCH
The issuance of this permit by the Health Department in no way guarantees the issuance of other permits. The permit holder is responsible for checking with appropriate governing bodies in meeting their requirements. This site is subject to revocation if the site plan, plat, or the intended use changes. The Improvement Permit shall not be affected by a change in ownership of the site. This permit is subject to compliance with the provisions of the Laws and Rules for Sewage Treatment and Disposal and to conditions of this permit.

Construction Authorization

(Required for Building Permit)

The construction and installation requirements of Rules .1950, .1952, .1954, .1955, .1956, .1957, .1958 and .1959 are incorporated by references into this permit and shall be met. Systems shall be installed in accordance with the attached system layout.

ISSUED TO: Stephenson Bldg Inc.
Facility Type: 4-bedroom 66'x60' STD New Expansion Repair
Basement? Yes No Basement Fixtures? Yes No
Type of Wastewater System** 25% reduction system
(See note below, if applicable)

PROPERTY LOCATION: 218 Hobby Rd. (Rollins Mill Road)
SUBDIVISION Paula E. Stephenson LOT # 32

Installation Requirements/Conditions

Septic Tank Size 1250 gallons
Pump Tank Size _____ gallons

Number of trenches 3
Exact length of each trench 135 feet
Trenches shall be installed on contour at a
Maximum Trench Depth of: 24 inches
(Trench bottoms shall be level to +/-1/4"
in all directions)

Trench Spacing: 9 Feet on Center
Soil Cover: 12 inches
(Maximum soil cover shall not exceed
36" above the trench bottom)

Pump Requirements: _____ ft. TDH vs. _____ GPM

Aggregate Depth: NA inches below pipe
NA inches above pipe
NA inches total

Conditions: Gravity to D-Box Equal Distribution Required

**WATER LINES (INCLUDING IRRIGATION) MUST BE 10FT. FROM ANY PART OF SEPTIC SYSTEM OR REPAIR AREA.
NO UTILITIES ALLOWED IN INITIAL OR REPAIR DRAIN FIELD AREA.**

**If applicable: I understand the system type specified is different from the type specified on the application. I accept the specifications of this permit.

Owner/Legal Representative Signature: _____ Date: _____

This Construction Authorization is subject to revocation if the site plan, plat, or the intended use changes. The Construction Authorization shall not be transferred when there is a change in ownership of the site. This Construction Authorization is subject to compliance with the provisions of the Laws and Rules for Sewage Treatment and Disposal and to the conditions of this permit. SEE ATTACHED SITE SKETCH

Authorized State Agent: [Signature] Date: 11/15/2019
ANDREW CURRY Construction Authorization Expiration Date: 11/15/2024

Application # SFD1910-0049

Harnett County Department of Public Health Site Sketch

Property Location: 218 Hobby Road (Rollins Mill Road) SR 1401
Issued To: Stephenson Bldg Inc. Subdivision Ruola E. Stephenson Lot # 32

Authorized State Agent: [Signature] Date: 11/15/2019

ANDREW CURRIE

- * SEPTIC PROPOSAL BY ADAMS
- SOLL CONSULTING
- * GRAVITY TO D-BOX EQUAL DISTRIBUTION REQUIRED

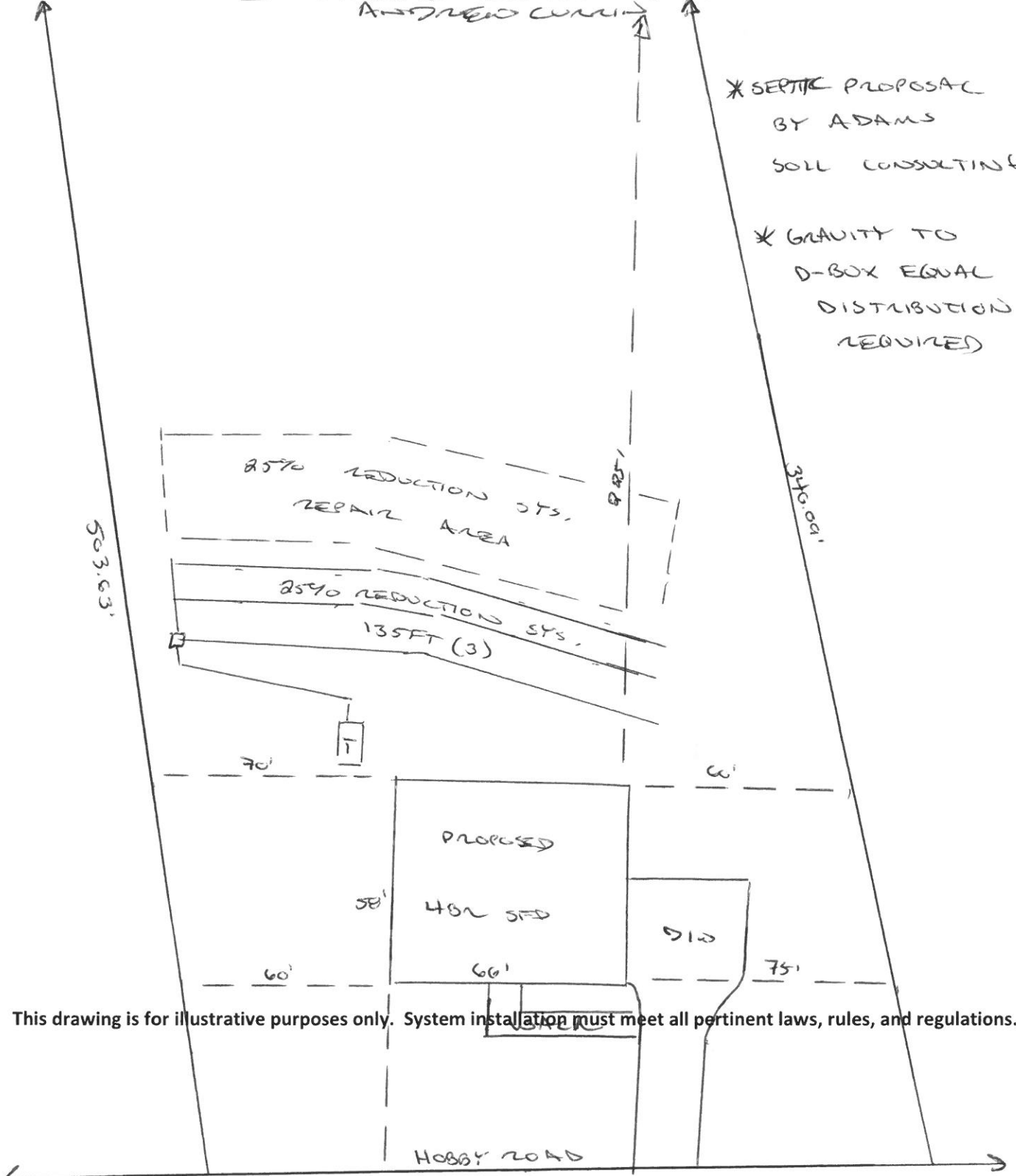

This drawing is for illustrative purposes only. System installation must meet all pertinent laws, rules, and regulations.