

Harnett County Department of Public Health

Improvement Permit

A building permit cannot be issued with only an Improvement Permit

SN1735

ISSUED TO: Frankie & Margaret Hasant

PROPERTY LOCATION: 111 Laverdale Lane (Antioch Ch. Rd.)
SUBDIVISION Larry W. Baird LOT # NA

NEW REPAIR EXPANSION
Type of Structure: 3-Bedroom 65' X 33' SFD
Proposed Wastewater System Type: At-Grade Sys.
Projected Daily Flow: 360 GPD
Number of bedrooms: 3 Number of Occupants: 6 max

Site Improvements required prior to Construction Authorization Issuance: _____

Basement Yes No
Pump Required: Yes No May be required based on final location and elevations of facilities [SI08 PLUMBING HIGH]
Type of Water Supply: Community Public Well Distance from well NA feet

Permit valid for: Five years
 No expiration

Permit conditions: _____

Authorized State Agent: [Signature]

Date: 10/10/2019

SEE ATTACHED SITE SKETCH

The issuance of this permit by the Health Department in no way guarantees the issuance of other permits. The permit holder is responsible for checking with appropriate governing bodies in meeting their requirements. This site is subject to revocation if the site plan, plat, or the intended use changes. The Improvement Permit shall not be affected by a change in ownership of the site. This permit is subject to compliance with the provisions of the Laws and Rules for Sewage Treatment and Disposal and to conditions of this permit.

Construction Authorization

(Required for Building Permit)

The construction and installation requirements of Rules .1950, .1952, .1954, .1955, .1956, .1957, .1958, and .1959 are incorporated by references into this permit and shall be met. Systems shall be installed in accordance with the attached system layout.

ISSUED TO: Frankie & Margaret Hasant

PROPERTY LOCATION: 111 Laverdale Ln. (Antioch Ch. Rd.)
SUBDIVISION Larry W. Baird LOT # NA

SN1735

Facility Type: 302 65' X 33' SFD New Expansion Repair
Basement? Yes No Basement Fixtures? Yes No

Type of Wastewater System** At-Grade 25% Reduction Sys. (Initial) Wastewater Flow: 360 GPD
(See note below, if applicable)

Pump to At-Grade Sys. (Repair)

Installation Requirements/Conditions

Septic Tank Size 1000 gallons
Pump Tank Size _____ gallons

Number of trenches 3
Exact length of each trench 90 feet
Trenches shall be installed on contour at a
Maximum Trench Depth of: 14 inches
(Trench bottoms shall be level to +/-1/4"
in all directions)

Trench Spacing: 9 Feet on Center
Soil Cover: 6 inches [IMPORT]
(Maximum soil cover shall not exceed
36" above the trench bottom)

Pump Requirements: _____ ft. TDH vs. _____ GPM

Aggregate Depth: NA inches below pipe
NA inches above pipe
NA inches total

Conditions: Reference Site Plan, At-Grade Install

**WATER LINES (INCLUDING IRRIGATION) MUST BE 10FT. FROM ANY PART OF SEPTIC SYSTEM OR REPAIR AREA.
NO UTILITIES ALLOWED IN INITIAL OR REPAIR DRAIN FIELD AREA.**

**If applicable: I understand the system type specified is different from the type specified on the application. I accept the specifications of this permit.

Owner/Legal Representative Signature: _____

Date: _____

This Construction Authorization is subject to revocation if the site plan, plat, or the intended use changes. The Construction Authorization shall not be transferred when there is a change in ownership of the site. This Construction Authorization is subject to compliance with the provisions of the Laws and Rules for Sewage Treatment and Disposal and to the conditions of this permit.

SEE ATTACHED SITE SKETCH

Authorized State Agent: [Signature]

Date: 10/10/2019

ANDREW CURRIN

Construction Authorization Expiration Date: 10/10/2024

Application # SFD1909-0036

Harnett County Department of Public Health Site Sketch

Property Location: 111 Lowendale Lane (Antioch Church Rd - S121735)

Issued To: Frankie & Margerette Harant Subdivision Larry W. Baird Lot # NA

Authorized State Agent: Andrew Curran Date: 10/10/2019

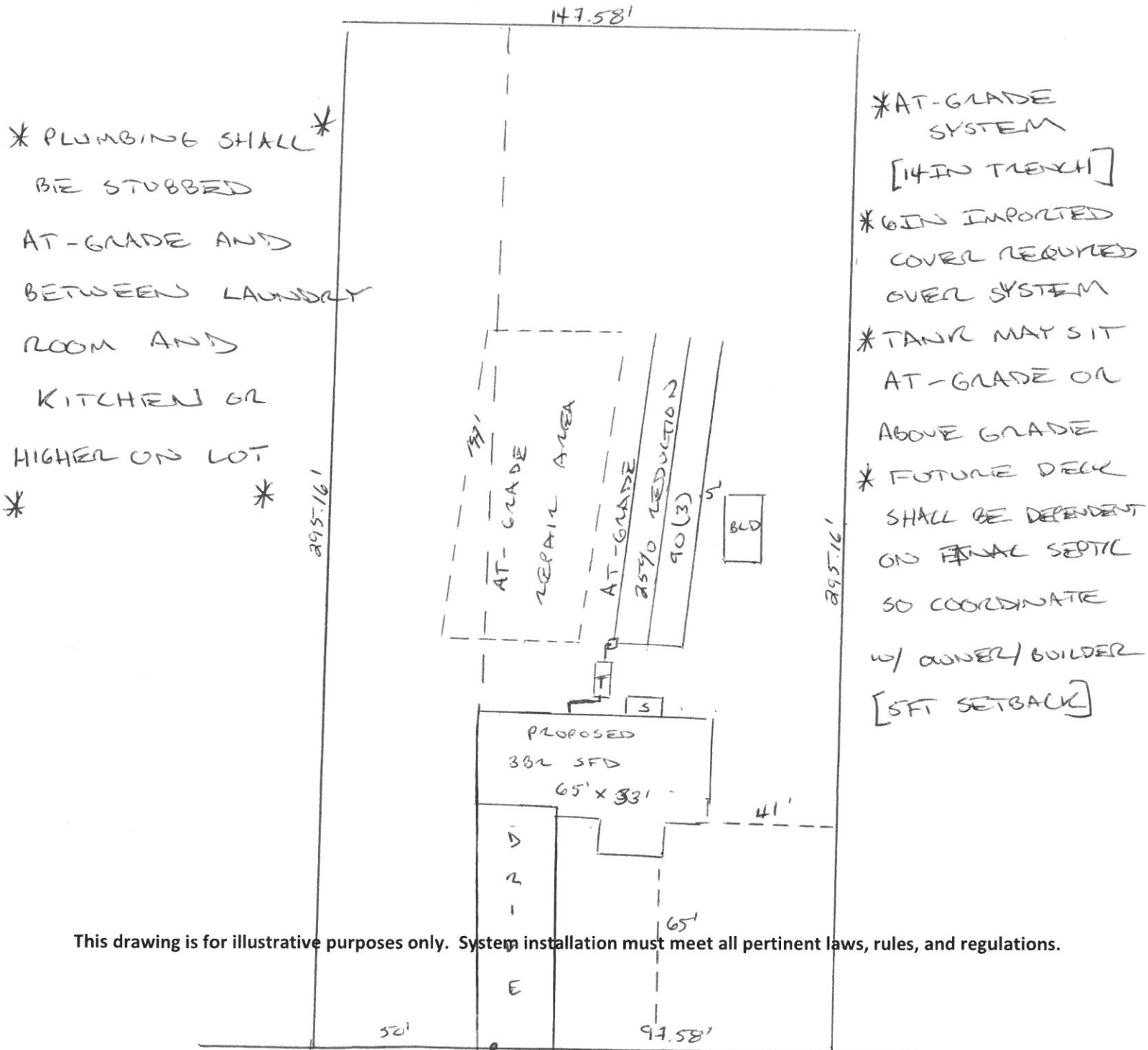

This drawing is for illustrative purposes only. System installation must meet all pertinent laws, rules, and regulations.