



ECS Southeast, LLP

6151 Raeford Road
Suite A
Fayetteville, NC 28304
(910) 401-3288 [Phone]
(910) 323-0539 [Fax]

LETTER OF TRANSMITTAL

September 11, 2019
Pride Homes
3350 Footbridge Lane, Suite 124
Fayetteville, NC 28306

ATTN: Joe Perkins

RE: **Clark Lot**
ECS Job # **33:4967**

Permits:
Location: **366 Clark rd**
Lillington, NC

We are enclosing: Field Reports For your use As requested

ENCL:

Field Report # 1 09/10/2019



Dennis D Lowery, 043840
Project Engineer

Donny Johnson
Field Services Manager

Disclaimer

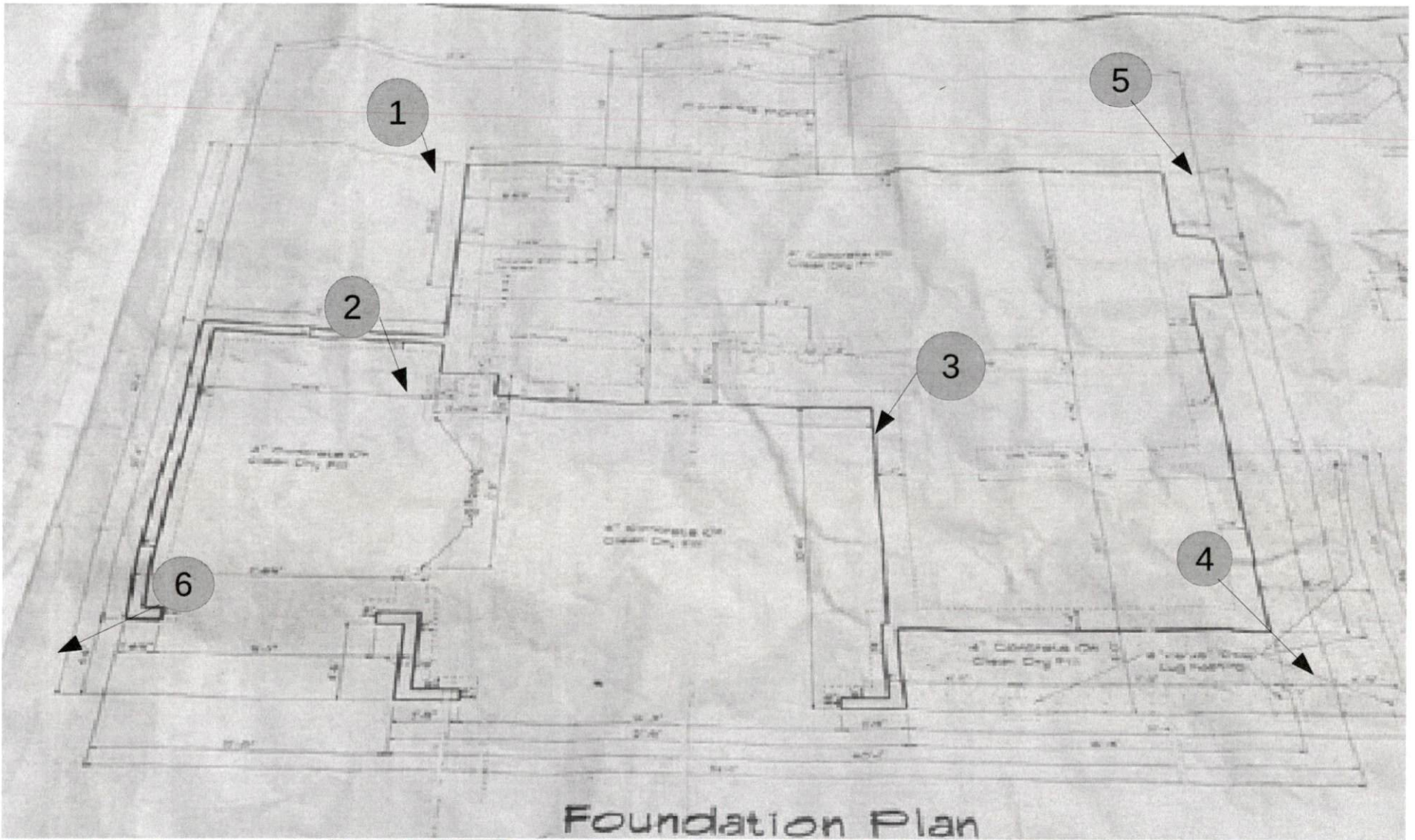
1. This report (and any attachments) shall not be reproduced except in full without prior written approval of ECS.
2. The information in this report relates only to the activities performed on the report date.
3. Where appropriate, this report includes statements as to compliance with applicable project drawings and specifications for the activities performed on this report date.
4. Incomplete or non-conforming work will be recorded for future resolution.
5. The results of samples and/or specimens obtained or prepared for subsequent laboratory testing will be presented in separate reports/documents.



<p>Thomas Wilmot 9/10/19 366 Clark Rd Proj # 4967 W/O # 53507</p>	<p>KEYS DCP's Test Locations #</p>		 <p style="text-align: center;">NORTH</p>
---	--	---	--



Report of Spread Footing - Foundation Observations

Project: Clark Lot
 Location: 366 Clark rd
Lillington - Harnett - NC - 27546
 Contractor: None Listed

Project No. 4967
 Day/Date: 09/10/2019

Footing Number	Location	Size (W x H x L)		Footing Bottom Elevation		Description of Subgrade Material	Required Blow Counts		Design Bearing Pressure
		Design	Actual	Design	Depth of Undercut (in)		# of Blows / increment		
1	south east corner	x x	x x	N/A	0	Grey Clay Sand	6		2000
							3,6,9		
1	south east corner	x x	x x	N/A	-1	Orange Brown Sand clay	6		2000
							4,4,6		
1	south east corner	x x	x x	N/A	-2	Orange Brown Sand clay	6		2000
							6,8,9		
1	south east corner	x x	x x	N/A	-3	Orange Brown Sand clay	6		2000
							8,12,16		
2	east middle	x x	x x	N/A	0	Grey Clay Sand	6		2000
							4,6,8		
2	east middle	x x	x x	N/A	-1	Orange Brown Sand Clay	6		2000
							4,7,9		
2	east middle	x x	x x	N/A	-2	Orange Brown Sand Clay	6		2000
							5,8,12		
2	east middle	x x	x x	N/A	-3	Orange Brown Sand Clay	6		2000
							6,11,14		
3	middle	x x	x x	N/A	0	Grey Clay Sand	6		2000
							4,5,6		

By: Thomas Allen Wilmot

ECS Southeast, LLP



Report of Spread Footing - Foundation Observations

Project: Clark Lot

Project No. 4967

Location: 366 Clark rd
Lillington - Harnett - NC - 27546

Day/Date: 09/10/2019

Contractor: None Listed

Footing Number	Location	Size (W x H x L)		Footing Bottom Elevation		Description of Subgrade Material	Required Blow Counts		Design Bearing Pressure
		Design	Actual	Design	Depth of Undercut (in)		# of Blows / increment		
3	middle	x x	x x	N/A	-1 .	Orange Brown Sand Clay	6		2000
							5,5,6		
3	middle	x x	x x	N/A	-2 .	Orange Brown Sand Clay	6		2000
							4,4,5		
3	middle	x x	x x	N/A	-3 .	Orange Brown Sand Clay	6		2000
							4,6,6		
4	Northwest	x x	x x	N/A	0 .	Grey Clay Sand	6		2000
							3,4,5		
4	Northwest	x x	x x	N/A	-1 .	Orange brown Sand clay	6		2000
							5,6,6		
4	Northwest	x x	x x	N/A	-2 .	Orange brown Sand clay	6		2000
							5,8,10		
4	Northwest	x x	x x	N/A	-3 .	Orange brown Sand clay	6		2000
							8,14,17		
5	Southwest	x x	x x	N/A	0 .	Grey Clay Sand	6		2000
							4,4,6		
5	Southwest	x x	x x	N/A	-1 .	Orange Brown Sand Clay	6		2000
							4,7,8		

By: Thomas Allen Wilmot

 ECS Southeast, LLP



Report of Spread Footing - Foundation Observations

Project: Clark Lot
 Location: 366 Clark rd
Lillington - Harnett - NC - 27546
 Contractor: None Listed

Project No. 4967
 Day/Date: 09/10/2019

Footing Number	Location	Size (W x H x L)		Footing Bottom Elevation		Description of Subgrade Material	Required Blow Counts	Design Bearing Pressure
		Design	Actual	Design	Depth of Undercut (in)		# of Blows / increment	
5	Southwest	x x	x x	N/A	-2	Orange Brown Sand Clay	6	2000
							5,7,11	
5	Southwest	x x	x x	N/A	-3	Orange Brown Sand Clay	6	2000
							7,11,14	
6	Northeast corner	x x	x x	N/A	0	Grey Clay Sand	6	2000
							5,7,8	
6	Northeast corner	x x	x x	N/A	-1	Orange Brown Sand Clay	6	2000
							5,8,11	
6	Northeast corner	x x	x x	N/A	-2	Orange Brown Sand Clay	6	2000
							6,9,12	
6	Northeast corner	x x	x x	N/A	-3	Orange Brown Sand Clay	6	2000
							7,10,13	

By: Thomas Allen Wilmot

ECS Southeast, LLP