

General Notes:

- 1.) "READ" Boise Installation Guide before installation of products.
- 2.) All, I-Joist, LVL beams, and Rim Board must be field cut to length.
- 3.) Contractor must verify and approve the material list.
- 4.) I-Joist may be moved 3" out of its own o.c. spacing, up to 19.2" o.c., to allow for plumbing drops.
- 5.) This layout, is a placement plan and, was designed in accordance with the original design of the structure (unless otherwise noted). See original plans for additional structural notes.
- 6.) Ceramic tile floors should be supported per APA standards. Additional joists may be required.
- 7.) HVAC & PLUMBER, "Review" Boise Installation Guide (Joist Hole Location & Sizing) Chart "BEFORE" cutting the I-joist product.
- 8.) "Blocking", are Random Length I-joist, Labeled as such.

We Recommend Locating Plumbing Drops & Moving Joist Accordingly Before Installation

Connector Summary				
PlotID	Qty	Manuf	Product	Flange
H1	15	Simpson	IUS 1.81/14	None
5" Screws*	38	Simpson	SDS 5" Screws*	None
Option Screened Porch				
PlotID	Length	Product	Plies	Net Qty
BM7-2	16' 0"	1-3/4" x 11-7/8" VERSA-LAM® 2.0 3100 SP	2	2
Products				
PlotID	Length	Product	Plies	Net Qty
J1	37' 0"	14" BCI® 4500s-1.8	1	2
J2	34' 0"	14" BCI® 4500s-1.8	1	13
J3-2	19' 0"	14" BCI® 4500s-1.8	2	2
J4	18' 0"	14" BCI® 4500s-1.8	1	1
J5	16' 0"	14" BCI® 4500s-1.8	1	2
J6	14' 0"	14" BCI® 4500s-1.8	1	4
J7	4' 0"	14" BCI® 4500s-1.8	1	1
J8	37' 0"	14" BCI® 5000s-1.8	1	3
J9	21' 0"	14" BCI® 5000s-1.8	1	1
J10	17' 0"	14" BCI® 5000s-1.8	1	4
J11	17' 0"	14" BCI® 5000s-1.8	1	1
J12	17' 0"	14" BCI® 5000s-1.8	1	1
BM1-2	8' 0"	1-3/4" x 9-1/4" VERSA-LAM® 2.0 3100 SP	2	6
BM2-2	6' 0"	1-3/4" x 9-1/4" VERSA-LAM® 2.0 3100 SP	2	2
BM3-2	18' 0"	1-3/4" x 11-7/8" VERSA-LAM® 2.0 3100 SP	2	2
BM4-2	10' 0"	1-3/4" x 11-7/8" VERSA-LAM® 2.0 3100 SP	2	2
BM5	8' 0"	1-3/4" x 14" VERSA-LAM® 2.0 3100 SP	1	1
BM6-3	24' 0"	1-3/4" x 24" VERSA-LAM® 2.0 3100 SP	3	3
Rim1	12' 0"	1" x 14" BC RIM BOARD OSB	1	13
BLK1	25' 0"	14" BCI® 4500s-1.8	1	1

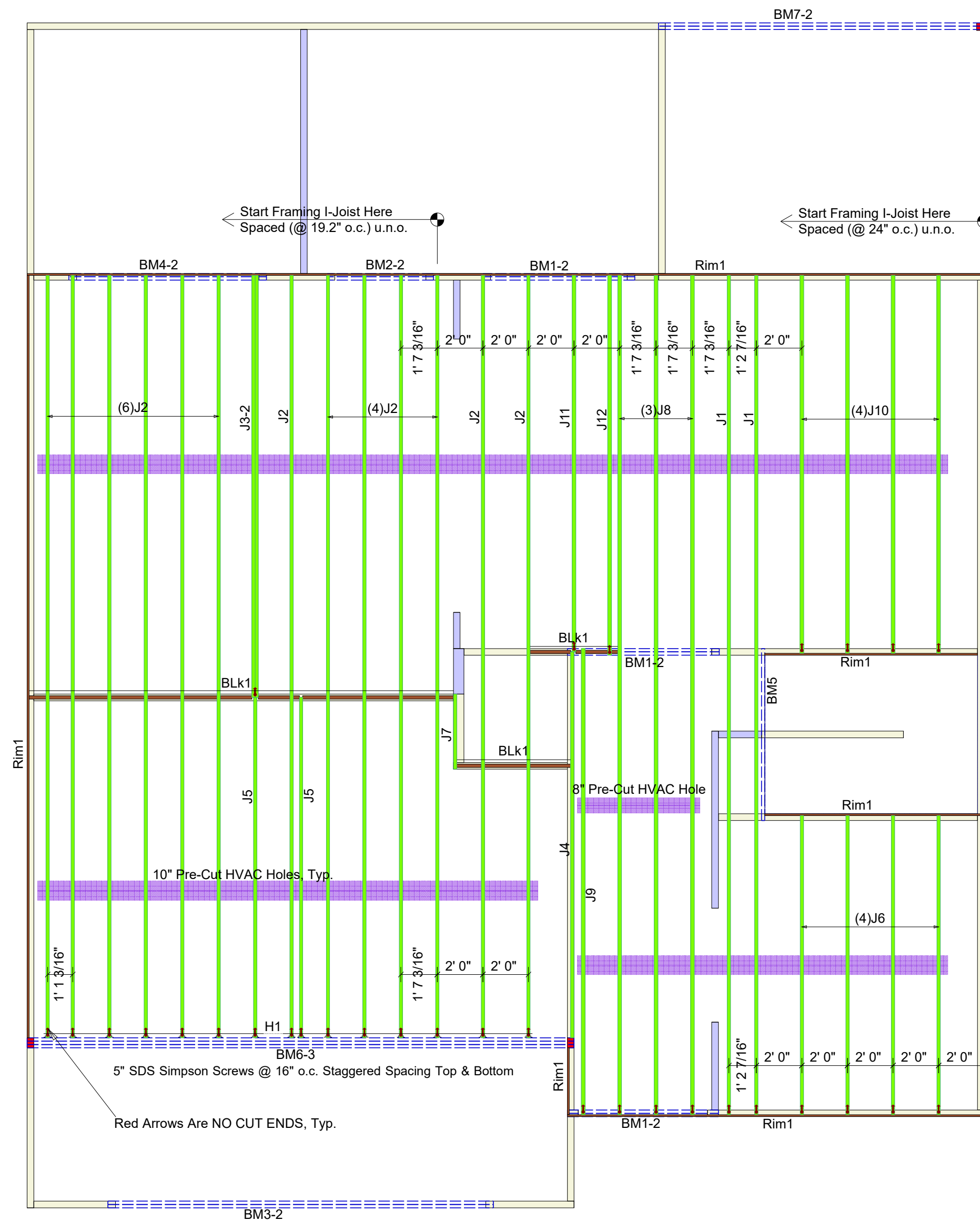

DN01 DO NOT cut, notch or drill flanges

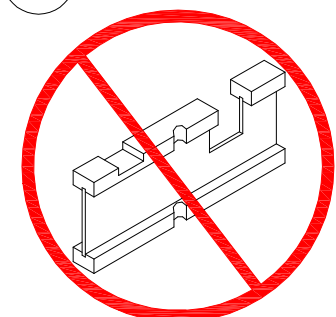

Note: Refer to current Boise Cascade Installation Guide for details not shown.

I-Joist Plot ID # & Length on Top of Flange

2nd FLOOR LAYOUT

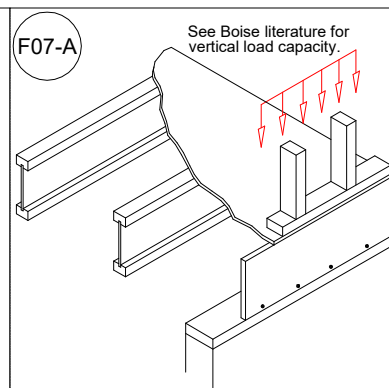
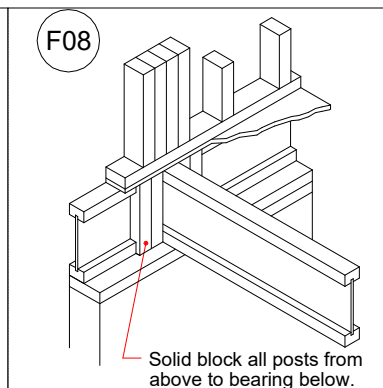
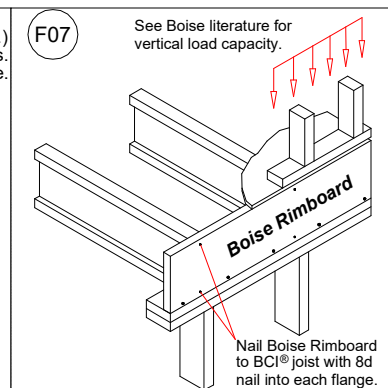
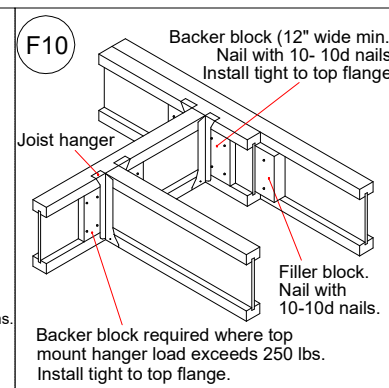
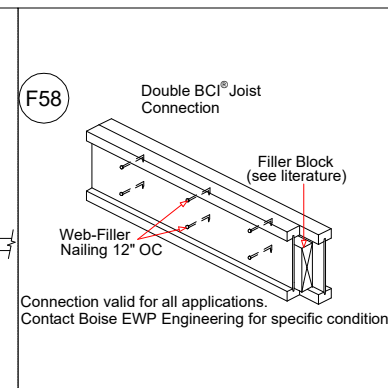
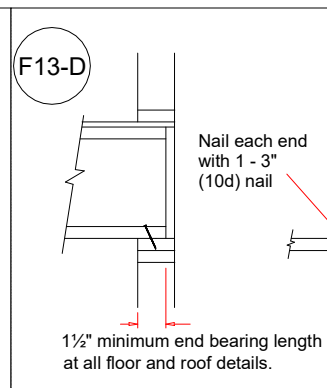
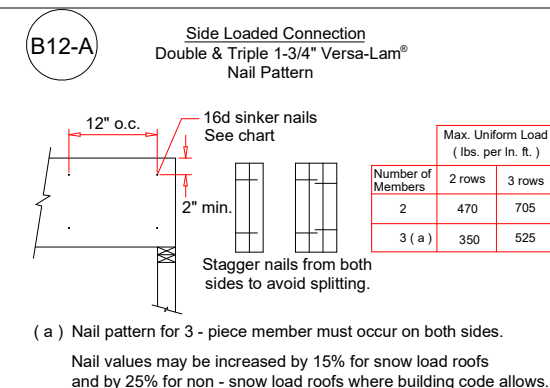
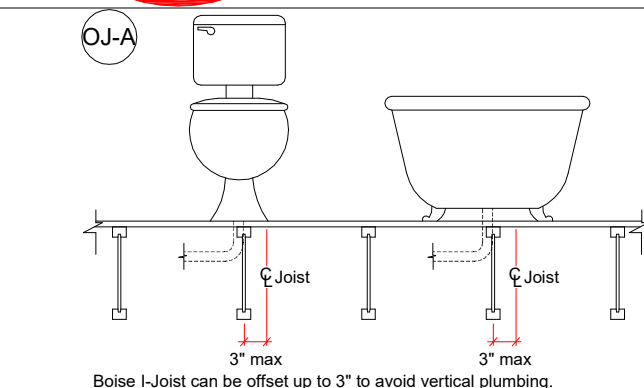

Cav-Land Development

CL-2862 (GL)

Scale: NTS

Date: 02.12.2018

By: J. Ciferri

DWG:

Sheet: 1 of 1

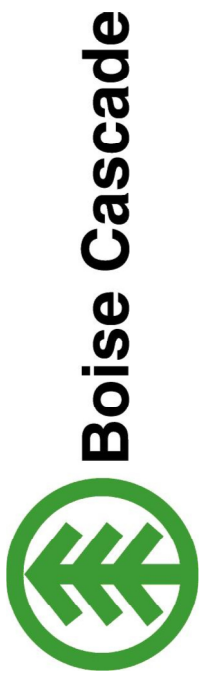

200 Emmett Drive, Dunn, N.C. 28334 (910) 892 + 8400