



September 25, 2019
Revised September 26, 2019

Jason Buie
Buie Construction
P.O. Box 612
Buies Creek, NC 27506
919-695-6370
Email: buiebuilt@gmail.com

Reference: Engineering Services
Chris & Natalie Munz
Project No.: 1901-010152r

As requested by the client, Tyndall Engineering & Design (TE&D) is providing recommendations for the following items:

- 1) (1) 16' garage door opening in-lieu of the plan specified (2) 9' garage door openings.

The following conclusions and recommendations were noted:

- 1) Based on our plan review, conversations with the builder, and analysis, the proposed (1) 16' garage door opening should be constructed in general accordance with the attached diagrams on pages 2, 3, and 4 of this report.

We appreciate being able to assist you during this phase of the project. If you need further assistance or require additional information, please do not hesitate to contact us.

Sincerely,
Tyndall Engineering & Design

Sean M. Holmes
SMH | 1901-010152r

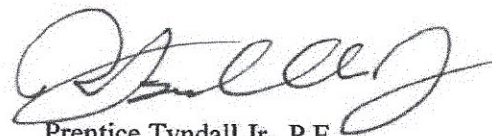
Prentice Tyndall Jr., P.E.

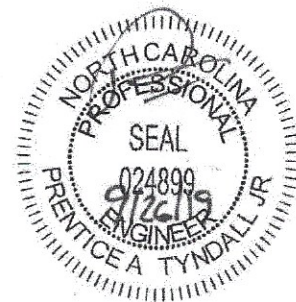



RIGHT ELEVATION

1/4" = 1'-0"



TYNDALL
ENGINEERING & DESIGN, P.A.

☎ 919 773-1200 • ☎ 919 773-9658
69 Shipwash Drive • Garner • North Carolina • 27529
www.tyndallengineering.com

CLIENT INFORMATION:

Jason Buie
Buie Construction
P.O. Box 612
Buies Creek, NC 27506

PROJECT INFORMATION:

Chris & Natalie Munz
Project No.: 1901-010152

SEAL:

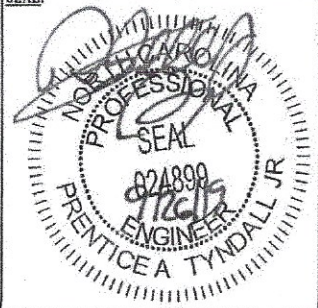

DESIGNED BY:

SMH

DATE:

9-25-19

DRAWING #:

1 of 3

CHECKED BY:

PAT

SCALE:

NTS

PAGE #:

2 of 4

REV #:

1

DESCRIPTION:

16' Opening

REVISION DATE:

9-26-19

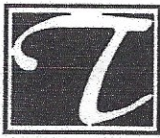
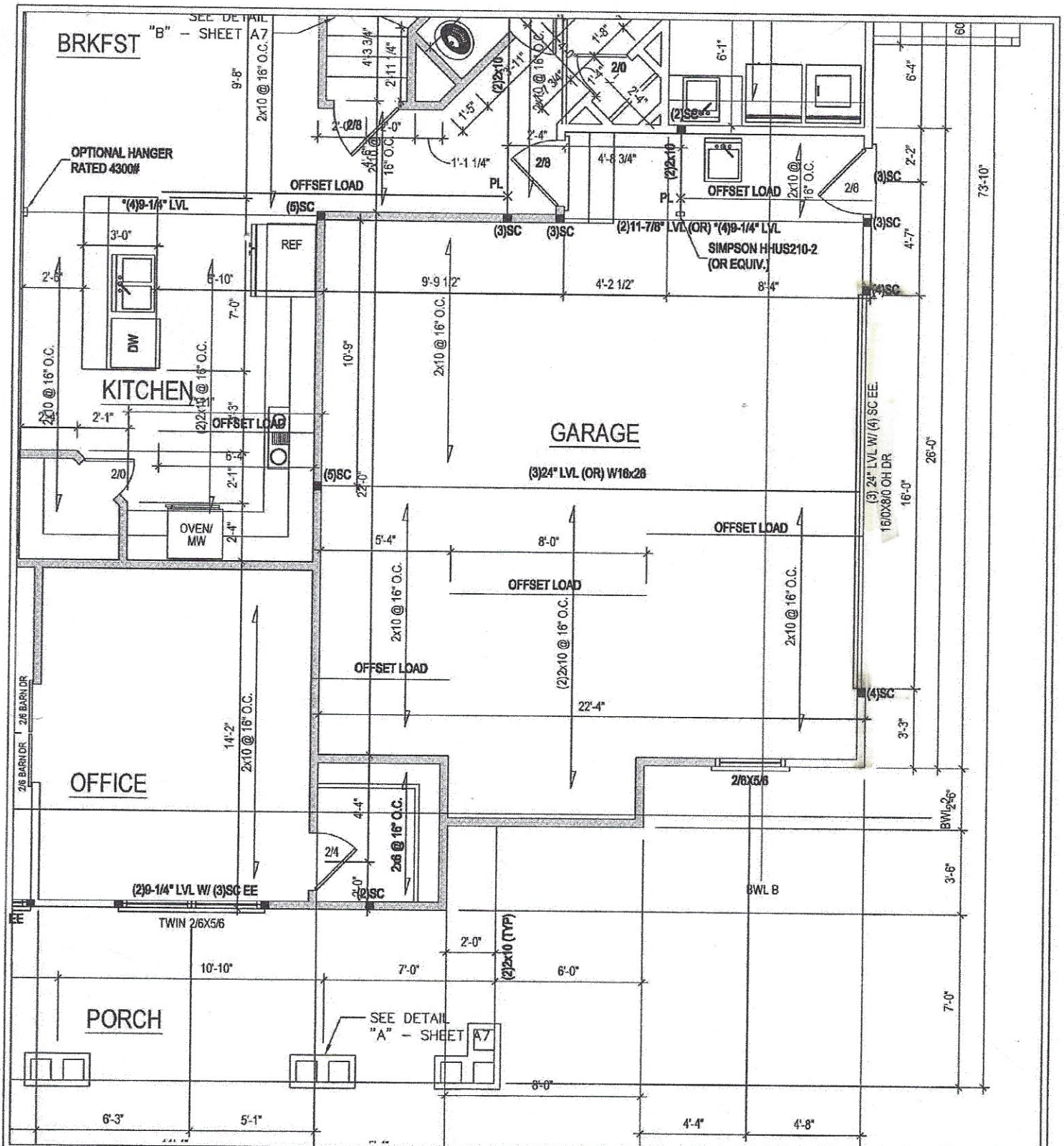

TYNDALL
ENGINEERING & DESIGN, P.A.

919 773-1200 • 919 773-9658
69 Shipwash Drive • Garner • North Carolina • 27529
www.tyndallengineering.com

CLIENT INFORMATION:

Jason Buie
Buie Construction
P.O. Box 612
Buies Creek, NC 27506

PROJECT INFORMATION:

Chris & Natalie Munz
Project No.: 1901-010152

DESIGNED BY:

SMH

DATE:

9-25-19

DRAWING #:

2 of 3

CHECKED BY:

PAT

SCALE:

NTS

PAGE #:

3 of 4

REV #:

1

DESCRIPTION:

16' Opening

REVISION DATE:

9-26-19

SEAL:

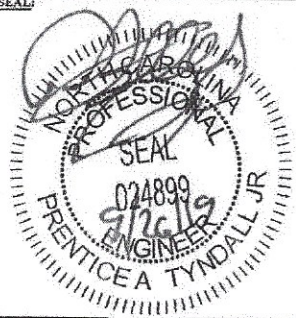

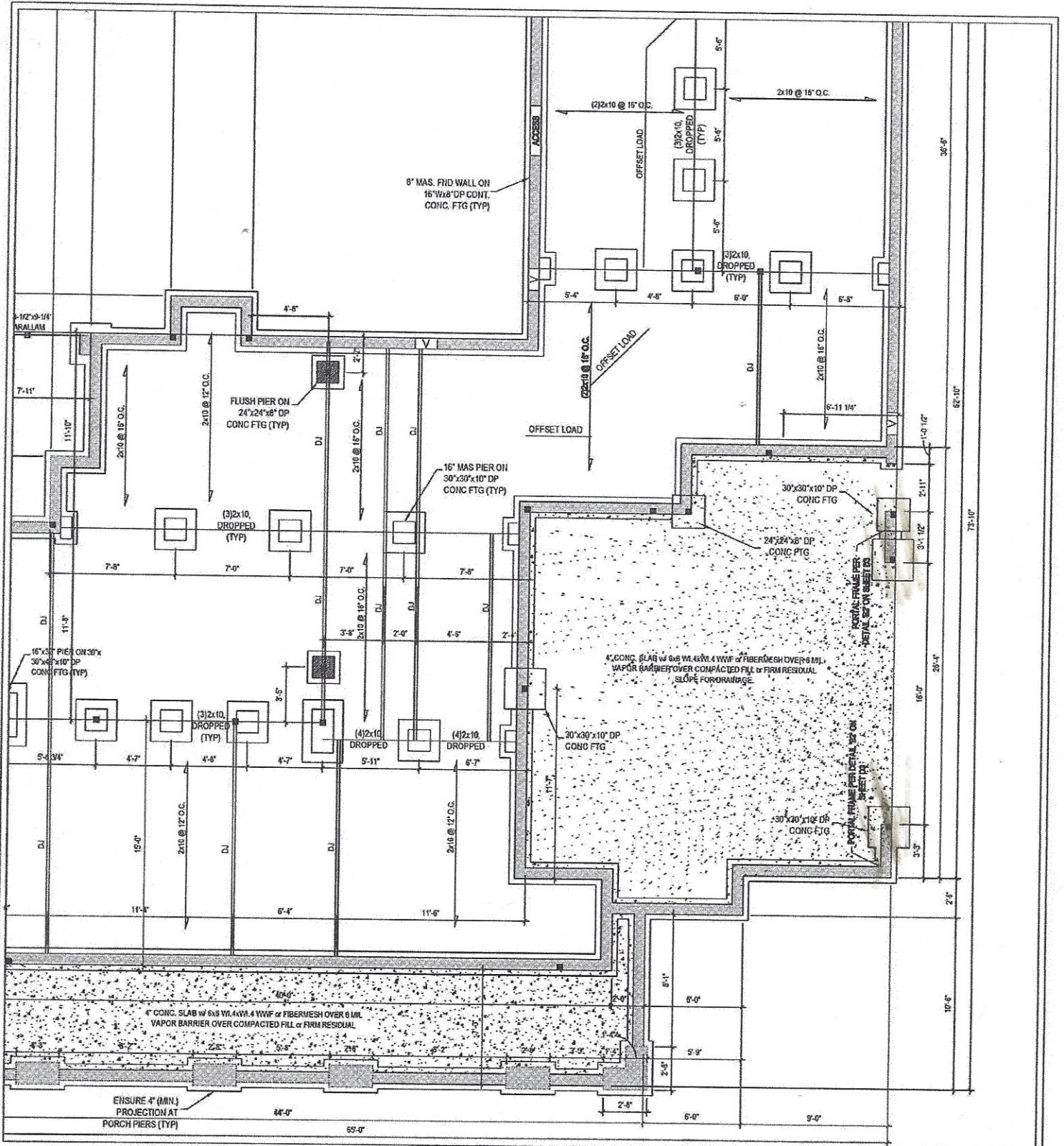

TYNDALL
ENGINEERING & DESIGN, P.A.

☎ 919 773-1200 ☎ 919 773-9658
69 Shipwash Drive • Garner • North Carolina • 27529
www.tyndalengineering.com

CLIENT INFORMATION:

Jason Buie
Buie Construction
P.O. Box 612
Buies Creek, NC 27506

PROJECT INFORMATION:

Chris & Natalie Munz
Project No.: 1901-010152

DESIGNED BY:

SMH

DATE:

9-25-19

DRAWING #:

3 of 3

CHECKED BY:

PAT

SCALE:

NTS

PAGE #:

4 of 4

REV #:

1

DESCRIPTION:

16' Opening

REVISION DATE:

9-26-19

SEAL:

