

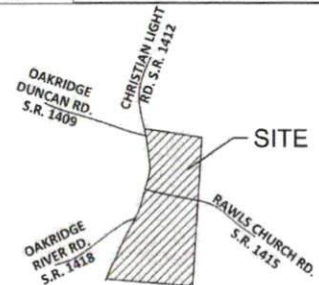

# Bateman Civil Survey Company

Engineers • Surveyors • Planners

2524 Relevance Avenue, Apex, NC 27539 P: 919.577.1080 F: 919.577.1081  
www.batemancivilsurvey.com info@batemancivilsurvey.com  
NCBELS Firm No. C-2378



### VICINITY MAP

(Not to Scale)

### LEGEND

- PO = PORCH
- CP = COVERED PATIO
- SW = SIDEWALK
- DW = CONC DRIVEWAY
- SP = SCREENED PORCH
- P = CONCRETE PATIO
- ⊙ = COMPUTED POINT
- = IRON PIPE FOUND
- ⊙ = IRON PIPE SET
- = DRILL HOLE FOUND
- ⊕ = WATER METER
- CO = CLEAN OUT
- AC = AIR CONDITIONER
- ⊙ = CABLE BOX
- ⊙ = SEWER MANHOLE
- ⊕ = TELEPHONE PEDESTAL
- CB = CATCH BASIN
- G = GAS METER
- E = ELECTRIC METER
- YI = YARD INLET

I, STEVEN P. CARSON, CERTIFY THAT THIS PLAT WAS DRAWN UNDER MY DIRECT SUPERVISION FROM A SURVEY MADE UNDER MY SUPERVISION (PLAT BOOK REFERENCED IN TITLE BLOCK); THAT THE BOUNDARIES NOT SURVEYED ARE CLEARLY INDICATED AS DRAWN FROM INFORMATION LISTED UNDER REFERENCES; THAT THE RATIO OF PRECISION AS CALCULATED IS 1:10,000+; AND THAT THIS MAP MEETS THE REQUIREMENTS OF THE STANDARD OF PRACTICE FOR LAND SURVEYING IN NORTH CAROLINA. L-4752  
DATED:

# PRELIMINARY

This map is of an existing parcel of land and is only intended for the parties and purposes shown. This map not for recordation. No title report provided.

BUILDER TO VERIFY HOUSE LOCATION, DIMENSIONS AND REVIEW TOTAL IMPERVIOUS NOTED ON THIS PLOT PLAN

## PRELIMINARY PLOT PLAN

FOR  
KB HOMES

**MASON POINTE - PHASE 1B - LOT 66**  
79 PINEY FIELD ROAD, FUQUAY-VARINA, NC  
HECTORS CREEK TOWNSHIP, HARNETT COUNTY

DATE: 5/20/19 DRAWN BY: MJA CHECKED BY: SPC

REFERENCE: BK 2019, PGS. 91-96 BCS# 180102 SCALE: 1" = 40'

### NOTES:

1. THIS SURVEY WAS PREPARED BY BATEMAN CIVIL SURVEY CO., UNDER THE SUPERVISION OF STEVEN P. CARSON, PLS.
2. THIS PLAN HAS BEEN PREPARED FOR LAYOUT AND PERMITTING PURPOSES ONLY.
3. PROPERTY LINES SHOWN WERE TAKEN FROM EXISTING FIELD EVIDENCE, EXISTING DEEDS AND/OR PLATS OF PUBLIC RECORD, AND INFORMATION SUPPLIED TO THE SURVEYOR BY THE CLIENT.
4. ALL DISTANCES ARE HORIZONTAL GROUND DISTANCES AND ALL BEARINGS ARE NORTH CAROLINA STATE PLANE COORDINATE SYSTEM UNLESS OTHERWISE SHOWN.
5. THIS MAP IS NOT FOR RECORDATION AND SHOULD BE REVIEWED BY A LOCAL GOVERNMENT AGENCY FOR COMPLIANCE WITH ANY APPLICABLE LAND DEVELOPMENT REGULATIONS.
6. THE BASIS OF NORTH AND ALL EASEMENTS, RIGHTS-OF-WAYS, BUFFERS, SETBACKS AND ADJOINERS, ETC. REFERENCED IN TITLE BLOCK.
7. NO INVESTIGATION INTO THE EXISTENCE OF JURISDICTIONAL WETLANDS OR RIPARIAN BUFFERS PERFORMED BY THIS FIRM.
8. SURVEYOR HAS MADE NO INVESTIGATION OR INDEPENDENT SEARCH FOR EASEMENTS OF RECORD, ENCUMBRANCES, RESTRICTIVE COVENANTS, OWNERSHIP TITLE EVIDENCE OR ANY OTHER FACTS THAT AN ACCURATE AND CURRENT TITLE RECORD MAY DISCLOSE.
9. THE PROPERTY LIES IN ZONE 'X' PER NATIONAL FLOOD INSURANCE PROGRAM F.I.R.M. MAP #37200644001, DATED OCTOBER 3, 2006.
10. ZONING IS : RA-30
11. PROPERTY OWNER: KB HOME RALEIGH- DURHAM INC.  
4506 S. MIAMI BLVD. #100  
DURHAM, NC. 27703

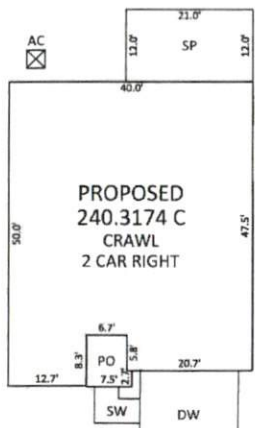

INSET SCALE: 1" = 20'

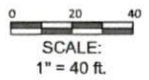

### LOT INFORMATION:

PIN: 0644-39-0410.000  
TOTAL LOT AREA = 0.60 AC = 26,064 SF  
HOUSE = 1,893 SF  
PORCH = 59 SF  
SIDEWALK = 38 SF  
DRIVEWAY = 650 SF  
SCREENED PORCH = 252 SF  
AC PAD = 9 SF  
PROPOSED IMPERVIOUS = 2,901 SF  
PERCENT IMPERVIOUS = 11.1 %

### BUILDING SETBACKS

FRONT - 35'  
REAR - 20'  
SIDE - 10'  
SIDE CORNER - 20'  
MAX HEIGHT 35'

MAX. IMPERVIOUS PER LOT: 5,910 SF

Curve Table				
Curve #	Length	Radius	Direction	Chord
C19	102.32	275.00	N39°34'26"E	101.73

