

Harnett County Department of Public Health Improvement Permit

A building permit cannot be issued with only an Improvement Permit

S21412

ISSUED TO: KB Homes Carolinas PROPERTY LOCATION: 61 Piney Field Rd. (Christina Ct. Rd.)
 SUBDIVISION: Mason Pointe LOT # 67
 NEW REPAIR EXPANSION
 Type of Structure: 4-Bedroom 50'x70' SFS
 Proposed Wastewater System Type: 25% reduction
 Projected Daily Flow: 480 GPD
 Number of bedrooms: 4 Number of Occupants: 8 max
 Basement Yes No
 Pump Required: Yes No May be required based on final location and elevations of facilities
 Type of Water Supply: Community Public Well Distance from well NA feet
 Permit conditions: _____ Permit valid for: Five years
 No expiration

Authorized State Agent: [Signature] Date: 07/17/2019 SEE ATTACHED SITE SKETCH
 The issuance of this permit by the Health Department in no way guarantees the issuance of other permits. The permit holder is responsible for checking with appropriate governing bodies in meeting their requirements. This site is subject to revocation if the site plan, plat, or the intended use changes. The Improvement Permit shall not be affected by a change in ownership of the site. This permit is subject to compliance with the provisions of the Laws and Rules for Sewage Treatment and Disposal and to conditions of this permit.

Construction Authorization

(Required for Building Permit)

The construction and installation requirements of Rules .1950, .1952, .1954, .1955, .1956, .1957, .1958, and .1959 are incorporated by references into this permit and shall be met. Systems shall be installed in accordance with the attached system layout.

ISSUED TO: KB Homes Carolinas PROPERTY LOCATION: 61 Piney Field Rd. (Christina Ct. Rd.)
 SUBDIVISION: Mason Pointe LOT # 67
 Facility Type: 4BR 50'x70' SFS New Expansion Repair
 Basement? Yes No Basement Fixtures? Yes No
 Type of Wastewater System** 25% reduction system (Initial) Wastewater Flow: 480 GPD
 (See note below, if applicable 50% reduction sys. (Repair))

Installation Requirements/Conditions

Septic Tank Size <u>1000</u> gallons	Number of trenches <u>1</u>	Trench Spacing: <u>9</u> Feet on Center
Pump Tank Size _____ gallons	Exact length of each trench <u>300 (MIN)</u> feet	Soil Cover: <u>12</u> inches
	Trenches shall be installed on contour at a	(Maximum soil cover shall not exceed
	Maximum Trench Depth of: <u>24</u> inches	36" above the trench bottom)
	(Trench bottoms shall be level to +/-1/4"	
	in all directions)	
Pump Requirements: _____ ft. TDH vs. _____ GPM		Aggregate Depth: <u>NA</u> inches below pipe
		<u>NA</u> inches above pipe
		<u>NA</u> inches total

Conditions: _____

**WATER LINES (INCLUDING IRRIGATION) MUST BE 10FT. FROM ANY PART OF SEPTIC SYSTEM OR REPAIR AREA.
 NO UTILITIES ALLOWED IN INITIAL OR REPAIR DRAIN FIELD AREA.**

*If applicable: I understand the system type specified is different from the type specified on the application. I accept the specifications of this permit.
 Owner/Legal Representative Signature: _____ Date: _____

This Construction Authorization is subject to revocation if the site plan, plat, or the intended use changes. The Construction Authorization shall not be transferred when there is a change in ownership of the site. This Construction Authorization is subject to compliance with the provisions of the Laws and Rules for Sewage Treatment and Disposal and to the conditions of this permit. SEE ATTACHED SITE SKETCH

Authorized State Agent: [Signature] Date: 07/17/2019
ANDREW CURRIN Construction Authorization Expiration Date: 07/17/2024

HTE# SFD1905-0017

Permit # NA

Harnett County Department of Public Health Site Sketch

5/21/12

ISSUED TO: KB Homes Carolinas SUBDIVISION: 61 Piney Field Rd. (Christina Ct. Rd.)
South Creek LOT # 67
Mason Pointe

Authorized State Agent: *Andrew Curran* Date: 07/17/2019
ANDREW CURRAN

* THIS DRAWING IS FOR ILLUSTRATIVE PURPOSE ONLY, SYSTEM INSTALLATION MUST MEET ALL PERTINENT LAWS, RULES, AND REGULATIONS

* PROPOSAL BY CENTRAL CAROLINA SOIL CONSULTING
* 300FT 25% RED. SYS. MINIMUM [420FT FLAGGED OR ~~SOFT~~ SOIL SCIENTIST]
* GRAVITY TO SERIAL OR EQUAL DISTRIBUTION

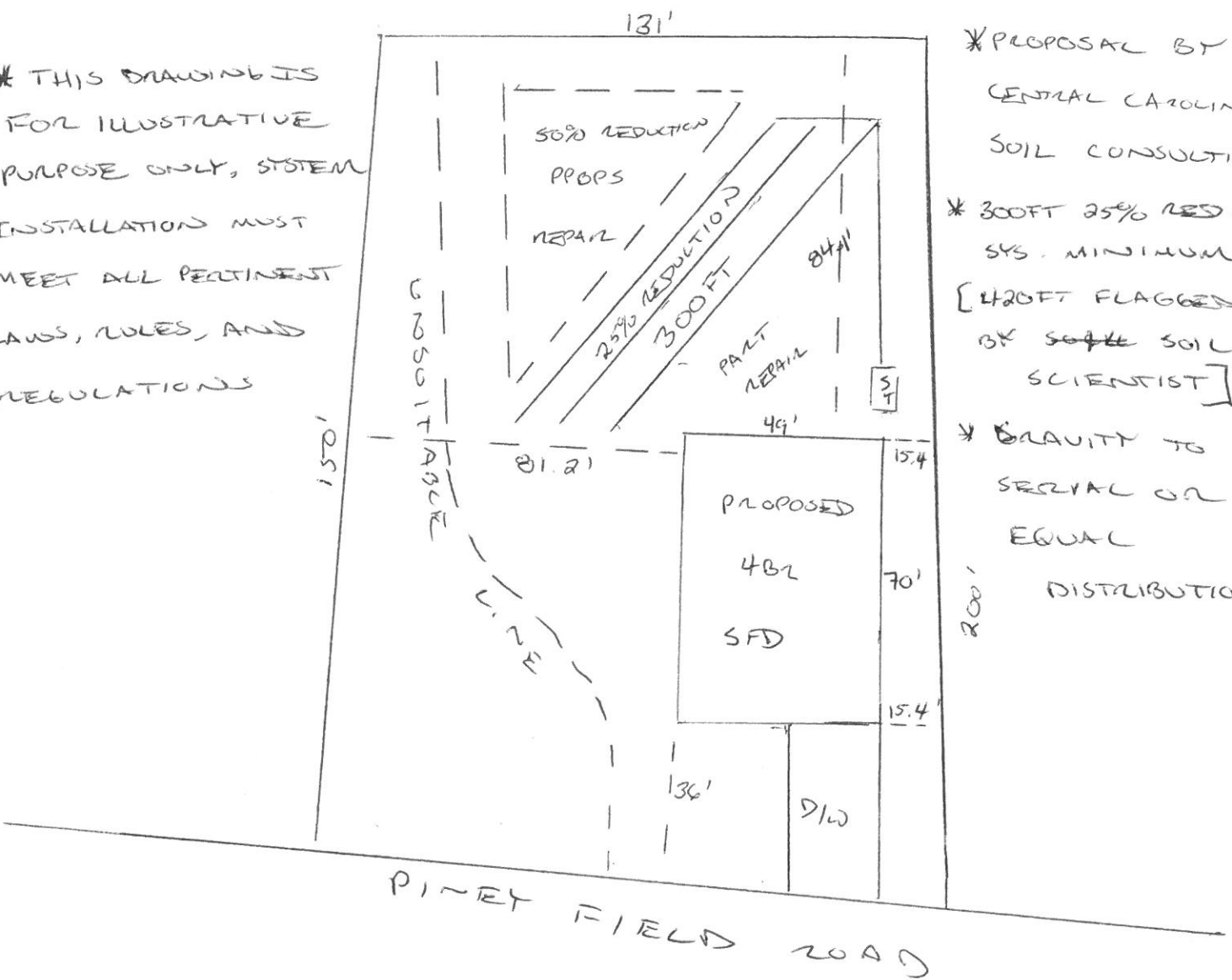

PINEY FIELD ROAD

**Masons Pointe S/D Lot 67
SYSTEM TAP CHART**

Bench Mark	is = 100.00		Location of BM		Elevation Head	-93.60
Pump tank elev.	100.00	Pump elev.	94.60	Manifold elev.	1.00	
line	color	rod read	Elevation	length	hole size	flow/tap gal/day trench area LINE LTAR

	total	feet =	0	gal/min =	0	LTAR =	0.3500
% of Dose Vol.	75	Des. Flow	480	LTAR + %5	0.3675		
Dose Volume	0.00	Pump Run=	#DIV/0!	(Itar W/ INOV)	0.4667		
Dose Pump Time	#DIV/0!	Tank Gal/IN	19.65	(Itar W/ INOV + 5%)	0.4900		
Drawdown in Inches	0.00						

**Masons Pointe S/D Lot 67
Repair TAP CHART**

Bench Mark	is = 100.00		Location of BM		Elevation Head	2.50
Pump tank elev.	100.00	Pump elev.	94.60	Manifold elev.	97.10	
line	color	rod read	Elevation	length	hole size	flow/tap gal/day trench area LINE LTAR
1	Orange	3.90	96.10	55	1/2in SCH 80	5.48 93.38 165 0.5659
2	Pink	4.40	95.60	70	1/2in SCH 40	7.11 121.15 210 0.5769
7	Yellow	8.00	92.00	90	3/4in SCH 80	10.1 172.10 270 0.6374
8	Pink	9.00	91.00	60	1/2in SCH 80	5.48 93.38 180 0.5188

	total	feet =	275	gal/min =	28.17	LTAR =	0.3500
% of Dose Vol.	75	Des. Flow	480	LTAR + %5	0.3675		
Dose Volume	134.06	Pump Run=	17.04	(Itar W/ INOV)	0.7000		
Dose Pump Time	4.76	Tank Gal/IN	19.65	(Itar W/ INOV + 5%)	0.7350		
Drawdown in Inches	6.82						