

Harnett County Department of Public Health

PERMIT # SFD1904-0058

Operation Permit

New Installation Septic Tank Nitrification Line Repair Expansion

PROPERTY LOCATION: 2342 PEACOCK FARM RD. (521257)

Name: (owner) JACK & EMILY HALL SUBDIVISION _____ LOT # _____

System Installer: ADCOCK ESCAVATING

Basement with plumbing: Garage Number of Bedrooms 5

Type of Water Supply: Community Public Well Distance from well NA feet

System Type: 25% REDUCTION SIS - IIIg Types V and VI Systems expire in 5 years.

(in accordance with Table V a)

Owner must contact Health Department 6 months prior to expiration for permit renewal.

This system has been installed in compliance with applicable North Carolina General Statutes, Rules for Sewage Treatment and Disposal, and all conditions of the Improvement Permit and Construction Authorization.

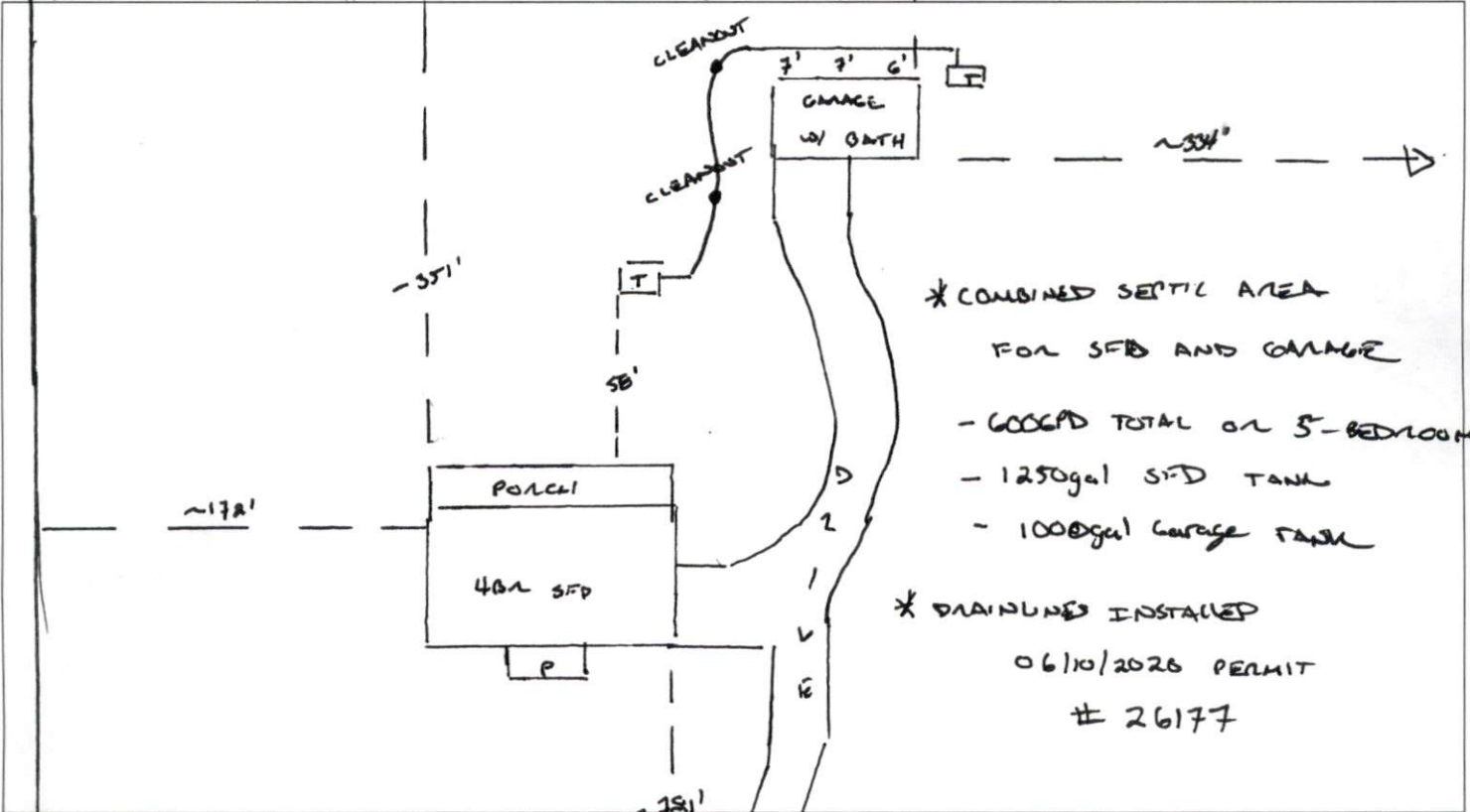

PERMIT CONDITIONS:

- I. Performance: System shall perform in accordance with Rule .1961.
- II. Monitoring: As required by Rule .1961.
- III. Maintenance: As required by Rule .1961. Other: _____
Subsurface system operator required? Yes No
If yes, see attached sheet for additional operation conditions, maintenance and reporting.
- IV. Operation: _____
- V. Other: _____

D-Box Pump Alarm H2O Line PWR Line

Following are the specifications for the sewage disposal system on the above captioned property.

Type of system: Conventional Other EE FLOW IIIg Septic Tank: 1250, 1000 [EXT] gallons Pump Tank: _____ gallons
Subsurface No. of exact length width of depth of
Drainage Field ditches 3 [EXT] of each ditch 120 [EXT] feet ditches 3 [EXT] feet ditches 24 [EXT] inches
French Drain Required: _____ Linear feet

Authorized State Agent [Signature] Date 10/13/2021

HTE# SFD1904-0058

Harnett County Department of Public Health

No. **26177**

PERMIT # _____

Operation Permit

New Installation Septic Tank Nitrification Line Repair Expansion

PROPERTY LOCATION: 2342 Peach Farm Rd

Name: (owner) Jack + Emily Hall SUBDIVISION _____ LOT # _____

System Installer: Jay Adcock Registration # _____

Basement with plumbing: Garage Number of Bedrooms _____

Type of Water Supply: Community Public Well Distance from well _____ feet

System Type: III g EZ Flow Types V and VI Systems expire in 5 years.

(In accordance with Table V a) Owner must contact Health Department 6 months prior to expiration for permit renewal.

This system has been installed in compliance with applicable North Carolina General Statutes, Rules for Sewage Treatment and Disposal, and all conditions of the Improvement Permit and Construction Authorization.

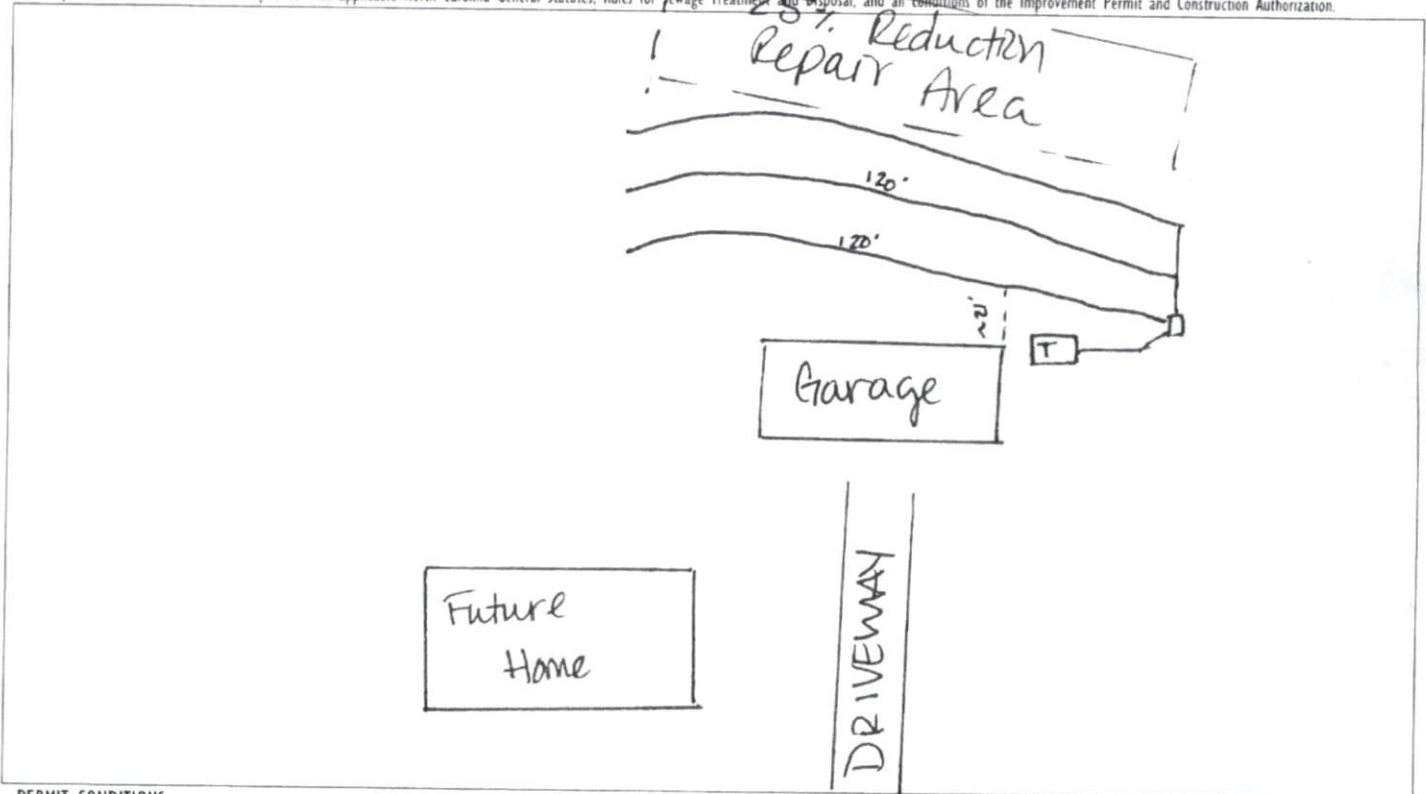

PERMIT CONDITIONS:

I. Performance: System shall perform in accordance with Rule .1961.

II. Monitoring: As required by Rule .1961.

III. Maintenance: As required by Rule .1961. Other: _____

Subsurface system operator required? Yes No

If yes, see attached sheet for additional operation conditions, maintenance and reporting.

IV. Operation: _____

V. Other: This is Tank for Garage only. Tank for house not installed

D-Box Pump Alarm H2O Line PWR Line

Following are the specifications for the sewage disposal system on the above captioned property.

Type of system: Conventional Other III g EZ Flow Septic Tank: 1000 gallons Pump Tank: _____ gallons

Subsurface Drainage Field No. of ditches 3 exact length of each ditch 120 feet width of ditches 3 feet depth of ditches 24 inches

French Drain Required: _____ Linear feet

Authorized State Agent [Signature] REHS-I

Date 6/10/2020