



Initial Application Date: 4-11-19

Application # SFD1904-0029

COUNTY OF HARNETT RESIDENTIAL LAND USE APPLICATION  
Central Permitting 108 E. Front Street, Lillington, NC 27546 Phone: (910) 893-7525 ext:2 Fax: (910) 893-2793 www.harnett.org/permits

\*\*A RECORDED SURVEY MAP, RECORDED DEED (OR OFFER TO PURCHASE) & SITE PLAN ARE REQUIRED WHEN SUBMITTING A LAND USE APPLICATION\*\*

LANDOWNER: Caviness Land Development Mailing Address: 1041B Robeson Street  
City: Fayetteville State: NC Zip: 28305 Contact No: 910.339.6330 Email: janine@cavinessland.com

APPLICANT\*: SAME Mailing Address: \_\_\_\_\_

City: \_\_\_\_\_ State: \_\_\_\_\_ Zip: \_\_\_\_\_ Contact No: \_\_\_\_\_ Email: \_\_\_\_\_  
\*Please fill out applicant information if different than landowner

CONTACT NAME APPLYING IN OFFICE: Tony Fofi/Janine Lightner Phone # 910.237.2832 / 910.339.6330

ADDRESS: 471 Angel Oak Drive Lot #290 PIN: 0516-07-0516

DEED OR OTP: Contract to purchase included

PROPOSED USE:

- SFD: (Size 42 x 54) # Bedrooms: 4 # Baths: 2.5 Basement(w/wo bath):  Garage:  Deck:  Crawl Space:  Slab:  Monolithic Slab:   
(Is the bonus room finished?  yes  no w/ a closet?  yes  no (if yes add in with # bedrooms)
- Mod: (Size \_\_\_\_\_ x \_\_\_\_\_) # Bedrooms \_\_\_\_\_ # Baths \_\_\_\_\_ Basement (w/wo bath)  Garage:  Site Built Deck:  On Frame  Off Frame   
(Is the second floor finished?  yes  no Any other site built additions?  yes  no
- Manufactured Home:  SW  DW  TW (Size \_\_\_\_\_ x \_\_\_\_\_) # Bedrooms: \_\_\_\_\_ Garage:  site built?  Deck:  site built?
- Duplex: (Size \_\_\_\_\_ x \_\_\_\_\_) No. Buildings: \_\_\_\_\_ No. Bedrooms Per Unit: \_\_\_\_\_
- Home Occupation: # Rooms: \_\_\_\_\_ Use: \_\_\_\_\_ Hours of Operation: \_\_\_\_\_ #Employees: \_\_\_\_\_
- Addition/Accessory/Other: (Size \_\_\_\_\_ x \_\_\_\_\_) Use: \_\_\_\_\_ Closets in addition?  yes  no

Water Supply:  County \_\_\_\_\_ Existing Well \_\_\_\_\_ New Well (# of dwellings using well \_\_\_\_\_) \*Must have operable water before final  
(Need to Complete New Well Application at the same time as New Tank)

Sewage Supply: \_\_\_\_\_ New Septic Tank \_\_\_\_\_ Expansion \_\_\_\_\_ Relocation \_\_\_\_\_ Existing Septic Tank  County Sewer  
(Complete Environmental Health Checklist on other side of application if Septic)

Does owner of this tract of land, own land that contains a manufactured home within five hundred feet (500') of tract listed above?  yes  no

Does the property contain any easements whether underground or overhead  yes  no

Structures (existing or proposed): Single family dwellings: \_\_\_\_\_ Manufactured Homes: \_\_\_\_\_ Other (specify): \_\_\_\_\_

If permits are granted I agree to conform to all ordinances and laws of the State of North Carolina regulating such work and the specifications of plans submitted. I hereby state that foregoing statements are accurate and correct to the best of my knowledge. Permit subject to revocation if false information is provided.

Janine Lightner  
Signature of Owner or Owner's Agent

4-9-19  
Date

\*\*\*It is the owner/applicants responsibility to provide the county with any applicable information about the subject property, including but not limited to: boundary information, house location, underground or overhead easements, etc. The county or its employees are not responsible for any incorrect or missing information that is contained within these applications.\*\*\*

\*This application expires 6 months from the initial date if permits have not been issued\*\*

APPLICATION CONTINUES ON BACK

strong roots • new growth

strong roots • new growth

30' UTILITY EASEMENT

N55°09'27"E 86:40'

WETLANDS

290

0.54 ACRES  
23,377 SQ. FT.

291

FOREST OAKS  
PHASE 5, SECTION 1  
M.B. 2017, PG. 314

CONSERVATION  
DISTRICT LINE

289

FOREST OAKS  
PHASE 5, SECTION 1  
M.B. 2017, PG. 314

N35°56'17"W 280.62'

201.16'

S34°37'45"E 279.98'

**SITE PLAN APPROVAL:**  
**DISTRICT R-200R USE SFD**  
**#BEDROOMS 4**  
**4-11-19**  
**ADMINISTRATOR**

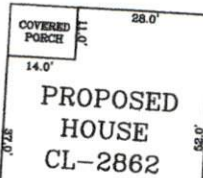

10' STREET  
TREE EASEMENT

C1

ANGEL OAK DRIVE  
50 FT. PUBLIC R/W