

*Avery Pond*

*Lot #48*

3-Bedroom Home (360 gal./day)

<u>LINE #</u>	<u>COLOR</u>	<u>BS</u>	<u>HI</u>	<u>FS</u>	<u>ELEVATION</u>	<u>LINE LENGTH</u>	<u>Design Length</u>
TBM		2.0		100.0		<u>in field</u>	<u>installation</u>
INST. 1			102.0				
<i>1</i>	<i>White</i>			<i>3.2</i>	<i>98.8</i>	<i>50</i>	<i>50</i>
<i>2</i>	<i>Orange</i>			<i>4.2</i>	<i>97.8</i>	<i>70</i>	<i>50</i>
<i>3</i>	<i>Pink</i>			<i>4.6</i>	<i>97.4</i>	<i>85</i>	<i>85</i>
<i>4</i>	<i>Yellow</i>			<i>5.1</i>	<i>96.9</i>	<i>115</i>	<i>115</i>
<i>5</i>	<i>Red</i>			<i>6.4</i>	<i>95.6</i>	<i>125</i>	<i>100</i>
<i>6</i>	<i>Blue</i>			<i>7.9</i>	<i>94.1</i>	<i>125</i>	<i>100</i>
<i>7</i>	<i>White</i>			<i>8.3</i>	<i>93.7</i>	<i>100</i>	<i>100</i>

	<u>System</u>	<u>Repair</u>
	Lines 5-7	Lines 1-4
<b>System Type</b>	Accepted Status System EZ-FLOW	Accepted Status System EZ-FLOW
Suggested Soil LTAR	0.30	0.30
<b>Total Line Length</b>	300	300
<b>Square Footage</b>	900	900
<b>Proposed Trench Bottom</b>	18"	18"
<b>Distribution Method</b>	Gravity to D-Box	Pressure Manifold

# Avery Pond 3-Bedroom Septic Proposal Lot #48

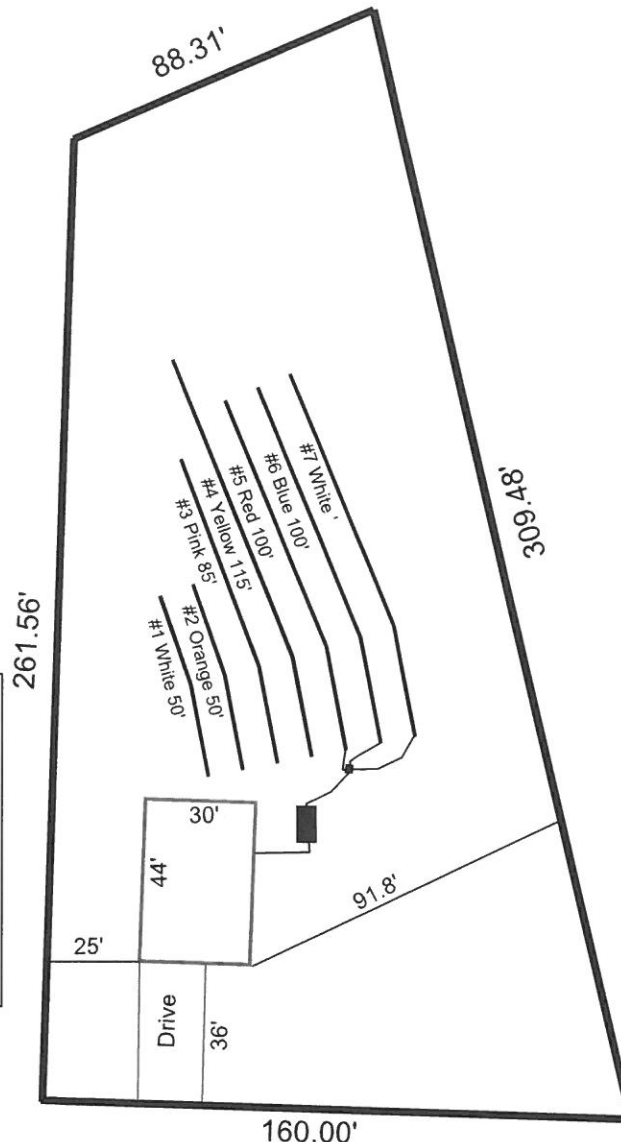

System: Gravity to D-Box  
 Lines: 5-7 (300')  
 0.3 LTAR  
 18-24" Trench Bottom  
 Accepted Status System  
 Repair: Pump to D-Box  
 Lines: 1-4 (300')  
 0.3 LTAR  
 18-24" Trench Bottom  
 Accepted Status System

48

0.789 AC.

Avery Pond Drive

GRAPHIC SCALE  
 1" = 50'



Adams  
 Soil Consulting  
 919-414-6761  
 Job #708