

Avery Pond

Lot #176

3-Bedroom Home (360 gal./day)

<u>LINE #</u>	<u>COLOR</u>	<u>BS</u>	<u>HI</u>	<u>FS</u>	<u>ELEVATION</u>	<u>LINE LENGTH</u>	<u>Design Length</u>
TBM		2.0		100.0		<u>in field</u>	<u>installation</u>
INST. 1			102.0				
1	Red			2.3	99.7	100	100
2	Pink			3.4	98.6	100	100
3	Blue			4.4	97.6	100	100
4	White			5.2	96.8	100	100
5	Yellow			7	95	100	100
6	Orange			8	94	100	100

	<u>System</u>	<u>Repair</u>
	Lines 4-6	Lines 1-3
System Type	Accepted Status System	Accepted Status System
	EZ-FLOW	EZ-FLOW
Suggested Soil LTAR	0.30	0.30
Total Line Length	300	300
Square Footage	900	900
Proposed Trench Bottom	24"	24"
Distribution Method	Gravity to D-Box	Pump to D-Box

If plumbing is sufficient to supply repair field without use of a pump then initial system may be switched with the repari

Avery Pond 3-Bedroom Septic Proposal Lot #176

176

0.527 AC.

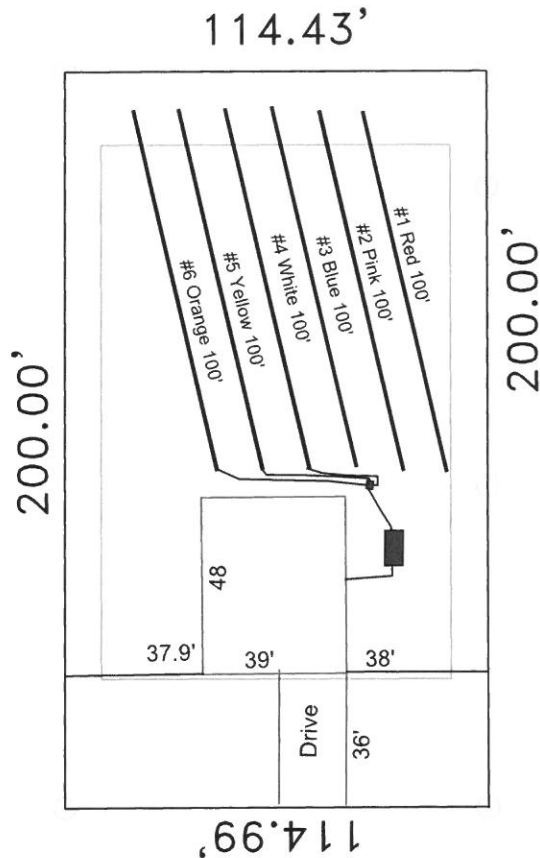

System: Gravity to D-Box
 Lines: 4-6 (300')
 0.3 LTAR
 18-24" Trench Bottom
 Accepted Status System
 Repair: Pump to D-Box
 Lines: 1-3 (300')
 0.3 LTAR
 18-24" Trench Bottom
 Accepted Status System

Avery Pond Drive

*If plumbing is sufficient to supply Lines 1-3 without the use of a pump then system and repair may be switched.

GRAPHIC SCALE
 1" = 50'



Adams
 Soil Consulting
 919-414-6761
 Job #708